

**RESURVEY OF LANDS**  
 ALL THAT CERTAIN LANDS SITUATE IN LOT 4, CHAMPION SURVEY, CITY OF PAINESVILLE, TOWNSHIP NUMBER 11 NORTH, RANGE VIII WEST, IN THE CONNECTICUT WESTERN RESERVE SURVEY, COUNTY OF LAKE, STATE OF OHIO. A RESURVEY OF THE LANDS TO JEFFERSON & DANIELLE BURRY, AS RECORDED IN DOCUMENT NUMBER 2006R016664 (PPN 15-C-014-0-00-007-0) IN THE OFFICE OF THE COUNTY RECORDER.

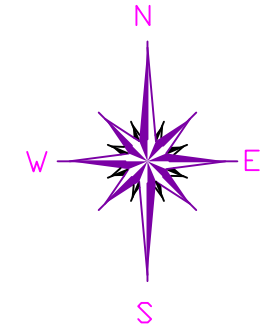

BASIS OF BEARINGS ARE TO AN ASSUMED MERIDIAN ALONG THE CENTERLINE OF GILLETT STREET NORTH 00°-53'-46" EAST



**SCALE: 1" = 30'**  
**SURVEY: AUGUST 24, 2019**  
**MAP: AUGUST 27, 2019**

THIS SURVEY WAS PERFORMED TO AN ACCURACY AS SET FORTH IN THE 2003 OHIO ADMINISTRATIVE CODE 4733-37.

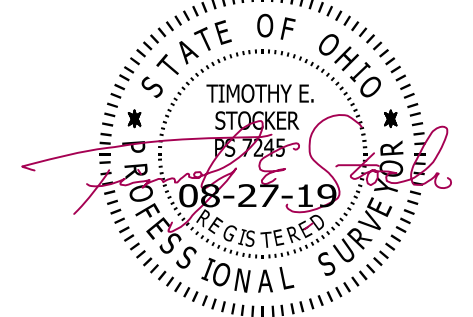

TIMOTHY E. STOCKER, P.S. 7245

**NOTES & REFERENCES**

- ALL IRON PIN SET ARE 5/8" X 30" REBAR WITH CAP "CRABBS 7245".
- DEEDS OF RECORD
- OCCUPATION AGREES WITH TITLE LINES AS PREVIOUSLY MONUMENTED EXCEPT AS SHOWN ON THIS PLAT

**LEGEND**

- IRON PIN FOUND/SET
- ⊙ IRON PIPE
- STONE MONUMENT
- ⊗ MONUMENT BOX
- ⊕ P.K. NAIL FOUND/SET
- DRILL HOLE FOUND
- CALC CALCULATED
- MEAS MEASURED
- OBS OBSERVED
- DEED DEED RECITED
- PLAT PLAT RECITED

PREPARED FOR:  JEFFERSON & DANIELLE BURRY	PROJECT NAME: RESURVEY OF LANDS	PROJECT ADDRESS: 142 GILLETT STREET PAINESVILLE, OHIO
	PROJECT LOCATION: LAKE COUNTY, OHIO	JOB NUMBER: 7499
<b>FOR INQUIRIES CONCERNING THIS SURVEY CONTACT:</b>  <b>CSS</b> CRABBS' SURVEYING SERVICE P.O. BOX 908 PAINESVILLE, OHIO 44077 1-800-488-3968		CHK: T. STOCKER  DRN: S. HUPERTZ REV:
		PAGE 1 OF 1