

BASIS OF BEARINGS ARE TO AN ASSUMED MERIDIAN ALONG THE CENTERLINE OF SOUTH STATE STREET
NORTH 33°-42'-41" WEST

LEGEND

- IRON PIN FOUND/SET
- IRON PIPE
- STONE MONUMENT
- MONUMENT BOX
- P.K. NAIL FOUND/SET
- DRILL HOLE FOUND
- CALC CALCULATED
- MEAS MEASURED
- OBS OBSERVED
- DEED DEED RECITED
- PLAT PLAT RECITED

RESURVEY OF LANDS

ALL THAT CERTAIN LANDS SITUATE IN A PORTION OF SUBLOT 33, AS ILLUSTRATED IN HITCHCOCK'S SURVEY, AS RECORDED IN PLAT VOLUME A, PAGE 90, AND IN LOT 12, TRACT 2, CITY OF PAINESVILLE, TOWNSHIP NUMBER 11 NORTH, RANGE VIII WEST, IN THE CONNECTICUT WESTERN RESERVE SURVEY, COUNTY OF LAKE, STATE OF OHIO. A RESURVEY OF THE LANDS TO DAVID TROBENTER, & ELIZABETH DISANTO, TRUSTEES, AS RECORDED IN DOCUMENT NUMBER 2025R002725, (PPN 15-B-007-0-00-039-0), IN THE OFFICE OF THE COUNTY RECORDER.

ITEMS OF INTEREST

NOTE 1: ADJOINERS WOOD PRIVACY FENCE IS OVER THE LINE AS SHOWN

NOTE 2: SUBJECTS STONE DRIVE IS OVER THE LINE AS SHOWN

#417
D.K. YOUNG
DOC. 2023R008344
PPN 15-B-007-0-00-049-0

#402
D.A. WANCHO
DOC. 2021R038944
PPN 15-B-007-0-00-038-0

#423
P. ESTRADA
DOC. 2009R030292
PPN 15-B-007-0-00-048-0

#408
DAVID TROBENTER & ELIZABETH
DISANTO, TRUSTEES
DOC. 2025R002725
PPN 15-B-007-0-00-039-0

#433
M.N. & K.B. BROWN
VOL. 1053, PG. 255
PPN 15-B-007-0-00-047-0

#414
C.G. & S.M. CAPP
VOL. 584, PG. 928
PPN 15-B-007-0-00-040-0

NOTES & REFERENCES

- ALL IRON PIN SET ARE 5/8" X 30" REBAR WITH CAP "CRABBS 7245".
- DEEDS OF RECORD
- PLAT VOL. A, PG. 90
- SURVEY BY CRABBS' SURVEYING FOR CORLEW, DATED JOB 2021, JOB 8410
- SURVEY BY CRABBS' SURVEYING FOR HYTREE, DATED SEPT 1967
- OCCUPATION AGREES WITH TITLE LINES AS PREVIOUSLY MONUMENTED EXCEPT AS SHOWN ON THIS PLAT

THIS SURVEY WAS PERFORMED TO AN ACCURACY AS SET FORTH IN THE 2003 OHIO ADMINISTRATIVE CODE 4733-37.

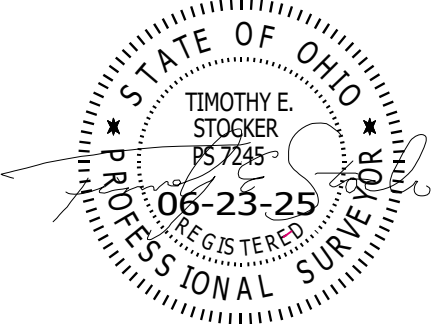

TIMOTHY E. STOCKER, P.S. 7245

PREPARED FOR: TOBENTER & DISANTO	PROJECT NAME: RESURVEY OF LANDS	PROJECT ADDRESS: 408 S STATE STREET PAINESVILLE, OHIO
	PROJECT LOCATION: LAKE COUNTY, OHIO	JOB NUMBER: 10328
FOR INQUIRIES CONCERNING THIS SURVEY CONTACT:		
	CRABBS' SURVEYING SERVICE P.O. BOX 908 PAINESVILLE, OHIO 44077 440-466-2025 / 440-357-5941 crabbssurveyinginc@gmail.com www.crabbssurveying.com	
		
		CHK: T. STOCKER, SR CHK: STOCKER, JR DRN: S. LOVEJOY REV: PAGE 1 OF 1



SCALE: 1" = 30'
SURVEY: JUNE 11, 2025
MAP: JUNE 23, 2025

EAST WALNUT
STREET
60' RW

SOUTH ST CLAIR
STREET
60' RW

SOUTH STATE STREET
60' RW

PAINESVILLE CITY
MON FOUND & USED
WITHIN A MON BOX
ASSEMBLY

5/8" IRON PIN
FOUND & USED
WITHIN A MON
BOX ASSEMBLY