

# RESURVEY OF LANDS

ALL THAT CERTAIN LANDS SITUATE IN A PORTION OF SUBLOT 27, AS ILLUSTRATED IN THE ROCKWELL, MATHEWS & HITCHCOCK ADDITION, RECORDED IN PLAT VOLUME A, PAGE 90, AND IN LOT 12, CITY OF PAINESVILLE, TOWNSHIP NUMBER 11 NORTH, RANGE VIII WEST, IN THE CONNECTICUT WESTERN RESERVE SURVEY, COUNTY OF LAKE, STATE OF OHIO. A RESURVEY OF THE LANDS TO MARIE SWAIM, TRUSTEE, ET AL, AS RECORDED IN DOCUMENT NUMBER 2008R020762, (PPN 15-B-004-0-00-018-0), AND DOCUMENT NUMBER 2008R020763, (PPN 15-B-004-0-00-019-0), IN THE OFFICE OF THE COUNTY RECORDER.

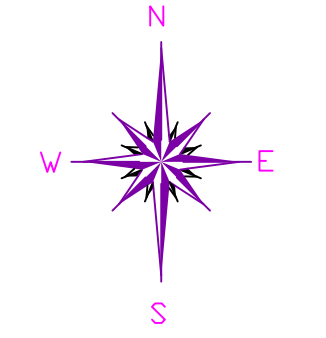

BASIS OF BEARINGS ARE TO AN ASSUMED MERIDIAN ALONG THE CENTERLINE OF SOUTH STATE STREET NORTH 33°-42'-41" WEST



SCALE: 1" = 30'  
 SURVEY: AUGUST 30, 2021  
 MAP: SEPTEMBER 13, 2021

## NOTES & REFERENCES

- ALL IRON PIN SET ARE 5/8" X 30" REBAR WITH CAP "CRABBS 7245".
- DEEDS OF RECORD
- OCCUPATION AGREES WITH TITLE LINES AS PREVIOUSLY MONUMENTED EXCEPT AS SHOWN ON THIS PLAT

## LEGEND

- IRON PIN FOUND/SET
- ⊙ IRON PIPE
- STONE MONUMENT
- ⊠ MONUMENT BOX
- ⊕ P.K. NAIL FOUND/SET
- PAINESVILLE CITY MONUMENT
- CALC CALCULATED
- MEAS MEASURED
- OBS OBSERVED
- DEED DEED RECITED
- PLAT PLAT RECITED

THIS SURVEY WAS PERFORMED TO AN ACCURACY AS SET FORTH IN THE 2003 OHIO ADMINISTRATIVE CODE 4733-37.

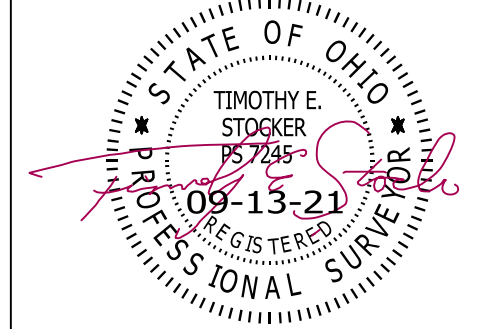

TIMOTHY E. STOCKER, P.S. 7245

PREPARED FOR:		
MARIE SWAIM, TRUSTEE, ET AL		
PROJECT NAME: RESURVEY OF LANDS	PROJECT ADDRESS: 320 328 S STATE ST PAINESVILLE, OHIO	CHK: T. STOCKER DRN: S. LOVEJOY
PROJECT LOCATION: LAKE COUNTY, OHIO	JOB NUMBER: 8351	PAGE 1 OF 1
FOR INQUIRIES CONCERNING THIS SURVEY CONTACT:		
CRABBS' SURVEYING SERVICE P.O. BOX 908 PAINESVILLE, OHIO 44077 1-800-488-3968		

