

LAKE HOSPITAL SYSTEMS
VOL. 790, PG. 96
PPN 15-B-002-0-00-012-0

LAKE COUNTY COMMISSIONERS
VOL. 890, PG. 1057
PPN 15-B-002-0-00-028-0

LAKE COUNTY COMMISSIONERS
VOL. 868, PG. 1110
PPN 15-B-002-0-00-013-0

LAKE COUNTY COMMISSIONERS
VOL. 868, PG. 1110
PPN 15-B-002-0-00-014-0

$S 34^{\circ}52'50" E$
213.30' OBS

CHARLES B. McDONALD
VOL. 495, PG. 813
PPN 15-B-002-0-00-027-0

LEGEND

- CAPPED 5/8" IRON PIN SET
- TYP. IP
- CALC. CALCULATED
- MEAS MEASURED
- OBS OBSERVED
- DEED DEED RECITED
- PLAT PLAT RECITED

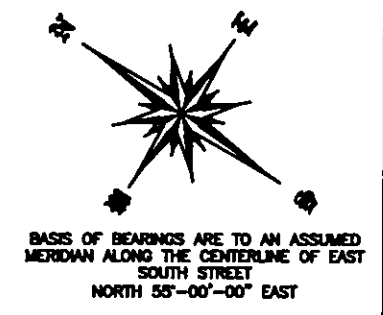

ADJOINERS 6' HIGH CONCRETE WALL

0.0033 ACRES SPLIT

0.0005 ACRES SPLIT

#61

$S 34^{\circ}52'50" E$
47.95' MEAS

$N 34^{\circ}52'50" W$
190.94' OBS

157.94' OBS

LINE	BEARING	DISTANCE
L 1	$S 55^{\circ}00'00" W$	3.00' MEAS
L 2	$N 55^{\circ}00'00" E$	3.00' MEAS
L 3	$N 34^{\circ}52'50" W$	47.95' MEAS
L 4	$S 55^{\circ}00'00" W$	3.00' MEAS
L 5	$N 34^{\circ}52'50" W$	7.41' MEAS
L 6	$S 34^{\circ}52'50" E$	7.41' MEAS

LAKE HOSPITAL SYSTEMS
VOL. 790, PG. 96
PPN 15-B-002-0-00-015-0

HERITAGE APARTMENTS
DOC. 2002R064126
PPN 15-B-002-0-00-026-0

ADJOINERS BLOCK GARAGE
ADJOINERS CONCRETE FOUNDATION WALL, 2' HIGH

319.44' PLAT
33.00' OBS
349.37' OBS
 $N 55^{\circ}00'00" E$

EAST SOUTH STREET - 66' RW

LIBERTY STREET - 60' RW

THIS SURVEY WAS PERFORMED TO AN ACCURACY AS SET FORTH IN THE 2003 OHIO ADMINISTRATIVE CODE 4733-37.

ALL THAT CERTAIN LANDS SITUATE IN LOTS 91 & 115, KERR, COLE AND OTHERS SURVEY AND ADDITION, CITY OF PAINESVILLE, TOWNSHIP NUMBER 11 NORTH, RANGE VIII WEST, IN THE CONNECTICUT WESTERN RESERVE SURVEY, COUNTY OF LAKE, STATE OF OHIO. A LOT SPLIT TAKEN FROM THE LANDS TO LAKE HOSPITAL SYSTEMS, AS RECORDED IN DEED VOLUME 790, PAGE 96 (PPN 15-B-002-0-00-015-0) AND THE LANDS TO HERITAGE APARTMENTS, AS RECORDED IN DOCUMENT NUMBER 2002R064126 (PPN 15-B-002-0-00-026-0) IN THE OFFICE OF THE COUNTY RECORDER.

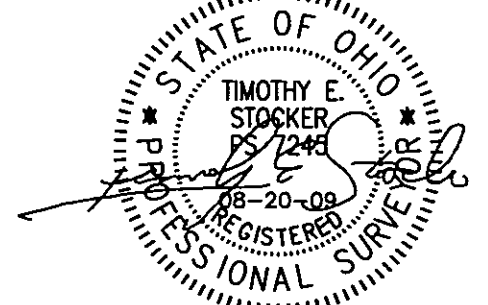

TIMOTHY E. STOCKER, P.S. 7245



SCALE: 1" = 20'
JULY 29, 2009
AUGUST 20, 2009

NOTE 1: #61 GARAGE IS OVER THE LINE 1.0' & 1.4' FOR 41.5'
NOTE 2: #61 CONCRETE DRIVE IS OVER THE LINE FROM 0.1' UP TO 1.0' FOR 6.6'

FOR INQUIRIES CONCERNING THIS SURVEY CONTACT:

CSS
CRABBS' SURVEYING SERVICE
P.O. BOX 908
PAINESVILLE, OHIO 44077
1-800-488-3968

PREPARED FOR:

- CHARLES McDONALD -

PROJECT NAME:

LOT SPLIT OF LANDS

PROJECT LOCATION:

LAKE COUNTY, OHIO

PROJECT ADDRESS:

81 E SOUTH STREET
PAINESVILLE, OHIO

JOB NUMBER: 4774

CHK: T. STOCKER

DRN: S. LOVEJOY

REV:

PAGE 1 OF 1