

BOUNDARY SURVEY PPN. 14-A-019-A-00-009-0

Situated in the the Village of Fairport Harbor, County of Lake and State of Ohio and known as being a part of Lot 3, Tract 4 in Original Painesville Township, further known as being Lot 10 of the proposed Harland Allotment

notes:

1. Basis of bearings: C/L Joughin Street N 89°01'29"E (assumed).
2. (d)=deed,(c)= calculated, (m)=measured
3. rebar set are 5/8" x 30" rebar with "Harrison 7002" survey cap
4. References
 - A. deeds of record
5. No encroachments noted.
6. This plat was prepared without benefit of a title examination and is subject to the results that an independent title examination might reveal.

I, the undersigned, hereby certify that the boundary survey represented by this plat and all monumentation set were conducted in accordance with the specifications set forth in Chapter 4733-37 of the Ohio Administrative Code. Surveyed November, 2024.

Douglas T. Harrison, P.S. 11-18-24

Douglas T. Harrison, P.S.
Registered Surveyor No. 7002, State of Ohio,
for
HARRISON SURVEYS, LLC
236 Burton Street, Fairport Harbor, Ohio 44077
Ph/text 440.477.9525
Email Harrisonsurveysllc@gmail.com

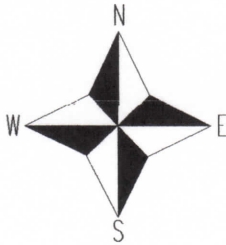
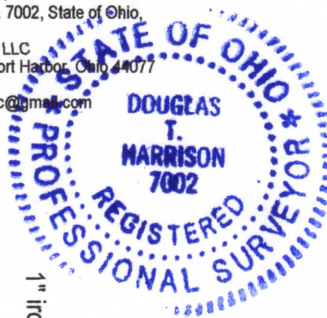

EAST STREET 60'

1" iron pipe fd & used (P.O.B.)

1" iron pipe fd

1" iron pipe fd @ 24.74'

S 00°40'00" E
139.14'
Fairport Harbor Village Corporation Line
Painesville Township

Norfolk Southern Combined Railroad
12-A-999-0-00-300-A
699/436

Travis & Kristen Lee Pokko
14-A-019-A-00-023-0
620 New Fourth St.
2018R013922
SL 9

Nichole C. Couture
14-A-019-A-00-009-0
621 Joughin St.
2006R044121
SL 10
0.128 ac.

Christine A. Biats
14-A-019-A-00-010-0
617 Joughin St.
2010R028374
SL 12

1" iron pipe fd & used

N 88°37'45"E
40.14'

rebar set

N 00°36'54" W
139.14(d) 138.86'(m)

39.84'(m)
236.75'(m)

40.26'
P.P.O.B.

rebar set

JOUGHIN STREET 50' N 89°01'29"E

50.00'

1" iron pipe fd & used

scale 1 inch = 30 feet

