

PAINESVILLE CITY
PAINESVILLE TOWNSHIP

NORFOLK & SOUTHERN COMBINED
RAILROAD
VOL. 11, PG. 92
PPN 11-B-999-00-300-A

N 68°19'52" E
389.08' OBS

0.93 +/- ACRES
REMAINING
#1250
WASIM ABOUNADER
DOC. 2012R026252
PPN 11-A-016-C-01-013-0

194.83' OBS
N 37°42'12" W

5/8" IRON PIN FOUND
N 37°42'12" W, 1.25'
FROM THE CORNER

3/4" IRON PIPE
FOUND & USED
WITHIN A MON
BOX ASSEMBLY

FAIRGROUNDS ROAD
VARIABLE WIDTH

ITEM OF INTEREST
SUBJECTS FENCE IS
LOCATED ON ADJOINERS
PARCEL

5/8" IRON PIN FOUND & USED
FOR REFERENCED S 68°06'24" W,
4.65' FROM THE CORNER

CAPPED 5/8" IRON PIN SET

EX. FENCE

POB

CAPPED 5/8" IRON PIN SET

0.0110
ACRES
SPLIT

MENTOR AVENUE
U.S. ROUTE 20 - VARIABLE WIDTH

383.40' OBS
S 42°22'25" W

405.69' OBS
N 42°22'25" E

STATE OF OHIO
DOC. 2004R025179
PPN 11-B-777-00-044-0

LINE	BEARING	DISTANCE
L 1	N 47°37'35" W	37.96' OBS
L 2	S 68°19'52" W	49.38' MEAS
L 3	S 47°37'35" E	21.62' MEAS
L 4	N 42°22'25" E	44.40' MEAS

LEGEND

●	IRON PIN FOUND/SET
⊙	IRON PIPE
□	STONE MONUMENT
⊠	MONUMENT BOX
⊕	P.K. NAIL FOUND/SET
○	DRILL HOLE FOUND
—	CALC
—	MEAS
—	OBS
—	DEED
—	PLAT
—	DEED RECITED
—	PLAT RECITED



SCALE: 1" = 50'
SURVEY: AUGUST 30, 2017
MAP: SEPTEMBER 8, 2017

LOT SPLIT OF LANDS

ALL THAT CERTAIN LANDS SITUATE IN LOT 52, TRACT 4,
TOWNSHIP OF PAINESVILLE, TOWNSHIP NUMBER 10
NORTH, RANGE IV WEST, IN THE CONNECTCUT
WESTERN RESERVE SURVEY, COUNTY OF LAKE, STATE
OF OHIO. A LOT SPLIT TAKEN FROM THE LANDS TO
WASIM ABOUNADER, AS RECORDED IN DOCUMENT
NUMBER 2012R026252 (PPN 11-A-016-C-01-013-0) IN
THE OFFICE OF THE COUNTY RECORDER.



BASIS OF BEARINGS ARE TO AN
ASSUMED MERIDIAN ALONG
THE CENTERLINE OF MENTOR
AVENUE
NORTH 42°-22'-25" EAST

NOTES & REFERENCES

- ALL IRON PIN SET ARE 5/8" X 30"
REBAR WITH CAP "CRABBS 7245".

- DEEDS OF RECORD

- SURVEY BY BRUCE LANDEG
FOR THE BOARD OF LAKE
COUNTY COMMISSIONERS,
DATED FEB. 2012

- OCCUPATION AGREES WITH
TITLE LINES AS PREVIOUSLY
MONUMENTED EXCEPT AS
SHOWN ON THIS PLAT

THIS SURVEY WAS PERFORMED TO AN
ACCURACY AS SET FORTH IN THE 2003
OHIO ADMINISTRATIVE CODE 4733-37.

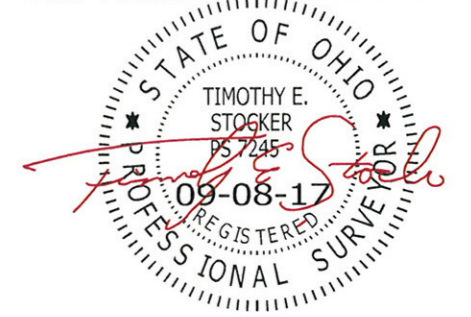

TIMOTHY E. STOCKER, P.S. 7245

PREPARED FOR: WASIM ABOUNADER	PROJECT NAME: LOT SPLIT OF LANDS	PROJECT ADDRESS: 1250 MENTOR AVENUE PAINESVILLE, OHIO
	PROJECT LOCATION: LAKE COUNTY, OHIO	JOB NUMBER: 6879
FOR INQUIRIES CONCERNING THIS SURVEY CONTACT: CSS CRABBS' SURVEYING SERVICE P.O. BOX 908 PAINESVILLE, OHIO 44077 1-800-488-3968		CHK: T. STOCKER DRN: S. HUPERTZ REV: PAGE 1 OF 1