

RESURVEY & COMBINATION OF LANDS

ALL THAT CERTAIN LANDS SITUATE BLOCK A, AS ILLUSTRATED IN THE MILL-MORR SUBDIVISION, RECORDED IN PLAT VOLUME O, PAGE 8 AND IN LOT 43, TRACT 4, TOWNSHIP OF PAINESVILLE, TOWNSHIP NUMBER 11 NORTH, RANGE VIII WEST, IN THE CONNECTICUT WESTERN RESERVE SURVEY, COUNTY OF LAKE, STATE OF OHIO. A RESURVEY & COMBINATION OF THE LANDS TO DIANE L. & PAUL N. DOMANOVICS, AS RECORDED IN DOCUMENT NUMBER 2012R022560 (PPN 11-A-014-D-01-029-0 & PPN 11-A-014-D-01-038-0) IN THE OFFICE OF THE COUNTY RECORDER.

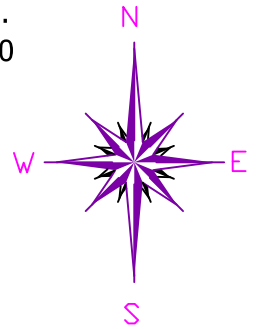

BASIS OF BEARINGS ARE TO AN ASSUMED MERIDIAN ALONG THE EAST LINE OF MILL-MORR SUBDIVISION NORTH 00°-45'-24" WEST

NOTES & REFERENCES

- ALL IRON PIN SET ARE 5/8" X 30" REBAR WITH CAP "CRABBS 7245".
- DEEDS OF RECORD
- PLAT VOL. O, PG. 8
- OCCUPATION AGREES WITH TITLE LINES AS PREVIOUSLY MONUMENTED EXCEPT AS SHOWN ON THIS PLAT

LEGEND

- IRON PIN FOUND/SET
- IRON PIPE
- STONE MONUMENT
- ⊠ MONUMENT BOX
- ⊙ P.K. NAIL FOUND/SET
- DRILL HOLE FOUND
- CALC CALCULATED
- MEAS MEASURED
- OBS OBSERVED
- DEED DEED RECITED
- PLAT PLAT RECITED

THIS SURVEY WAS PERFORMED TO AN ACCURACY AS SET FORTH IN THE 2003 OHIO ADMINISTRATIVE CODE 4733-37.

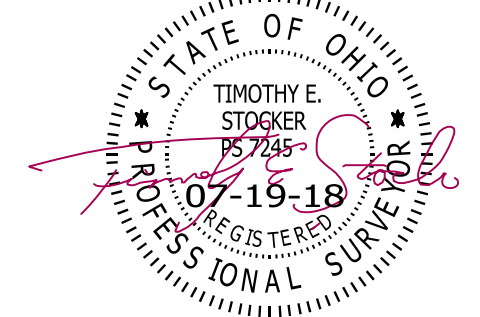

TIMOTHY E. STOCKER, P.S. 7245

PREPARED FOR: DIANE L. & PAUL N. DOMANOVICS	PROJECT NAME: RESURVEY OF LANDS	PROJECT ADDRESS: 220 MILL MORR ROAD PAINESVILLE, OHIO
	PROJECT LOCATION: LAKE COUNTY, OHIO	JOB NUMBER: 7146
FOR INQUIRIES CONCERNING THIS SURVEY CONTACT: CSS CRABBS' SURVEYING SERVICE P.O. BOX 908 PAINESVILLE, OHIO 44077 1-800-488-3968		CHK: T. STOCKER DRN: S. HUPERTZ REV: PAGE 1 OF 1

CURVE DATA	
C 1	
A=102.65'	
R=1852.74'	
Δ=3°10'28"	
N 05°57'50" W	
C=102.64'	
T=51.34'	



SCALE: 1" = 40'
SURVEY: JULY 16, 2018
MAP: JULY 19, 2018

