

LOT 17, TRACT 1

PAUL R. HECKER  
Vol. 862 Pg. 1250  
7-17-79 L.C.R.D.  
P.P.No. BA-9A-13

DEEP MEADOW PARTNERS L.T.D.  
Vol. 1101 Pg. 382  
3-29-95 L.C.R.D.  
P.P.No. BA-8A-14

2007.40 DEED 2008.52 OBS.

417.69 OBS.  
450.15 OBS. S 01° 25' 52" E

LOT 16, TRACT 1

LOT 5, TRACT 1

1115.38'  
3094.08 DEED  
3123.89 CALC. & USED

LOT 6, TRACT 1

1" IRON PIPE SET

1" IRON PIPE FOUND

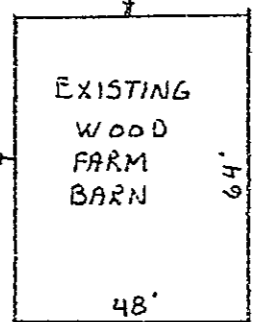

PARCEL NO. "B"  
1.8264 ACRES

NO PLAT REQUIRED  
LOT SPLIT  
Approved by *[Signature]*  
Lake County Planning Commission  
Log No. 4081-00 Date 4.4.02

"MARGARET R. MADSEN"  
Vol. 870 Pg. 1162  
6-22-93 L.C.R.D.  
P.P.No. BA-03-01  
94.5 ACRES DEED  
95.8286 ACRES ACTUAL  
94.0022 ACRES REMAINING

N 88° 30' 56" E

159.13 OBS.

149.87 OBS.

150 DEED

1 1/2" IRON POST FOUND  
4" ABOVE GROUND

1 1/2" IRON POST FOUND  
4" ABOVE GROUND

1 1/2" IRON POST FOUND  
4" ABOVE GROUND

518.33 OBS.  
597 DEED 563.28 OBS. N 01° 07' 36" W

JEFFREY & KARENA A. HEIMZ  
Vol. 331 Pg. 1107  
8-7-87 L.C.R.D.  
P.P.No. BA-03-16  
2.1 ACRES DEED  
2.1807 ACRES ACTUAL

PARCEL "A"

735 DEED 704.42 OBS. S 01° 07' 36" W  
658.95 OBS.

1" IRON PIPE SET

45.47'  
CALC. & USED

THIS SURVEY SATISFIES THE MINIMUM STANDARDS  
FOR BOUNDARY SURVEYS IN THE STATE OF OHIO, AS  
CODIFIED IN CHAPTER 4733-37 OF THE OHIO  
ADMINISTRATIVE CODE.

NOTE

IRON PIPES SET ARE 1" IN DIAMETER  
30" LONG AND HAVE A YELLOW CAP  
STAMPED SCHADE 6008.

*Willard F. Schade, Jr.*  
WILLARD F. SCHADE, JR. PROFESSIONAL SURVEYOR No. 6008 DATE 6008 1-30-02



SCHADE SURVEYING COMPANY		
4043 ERIE STREET WILLOUGHBY, OHIO 44097 440 951-6454		
SCALE: 1" = 40'	APPROVED BY	DRAWN BY FJM
DATE: 12-13-2001		FB 104 8105 DISK - MADSEN.2AK
LOT SPLIT SURVEY FOR: MARGARET MADSEN 12279 GIRDLED ROAD CONCORD TOWNSHIP LAKE COUNTY, OHIO		
P.P.No. BA-03-01	DRAWING NUMBER 01-1413	