

TOTAL 6.476 AC.  
 -R/W 0.290 AC.  
 TOTAL 6.186 AC.

**NOTES:**

- This plat was prepared without the benefit of an abstract of title and is subject to any state of facts revealed by a examination of the same.
- Documents used in preparation of this survey are cited on the plat.
- Occupation is consistent with the title lines except where noted on survey.
- Size of monumentation found or set is noted on plat.
- All iron pins set are 5/8" x 30" and are capped H. JONES PL56343
- Bearings are based upon the centerline of Pinehill Road as being North 36°03'45" West and are used to describe angles only.

*Harry S. Jones Jr.* 4/13/16  
 Harry S. Jones Jr., P.S. #6343 Date

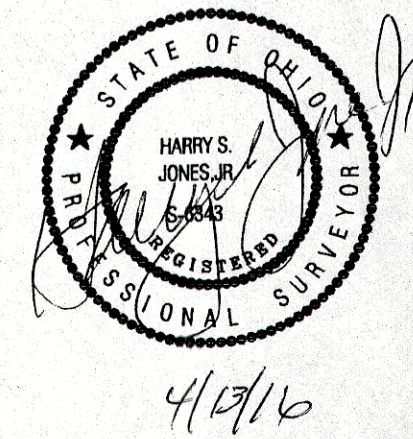

Revisions

**DENNIS BALANTE**  
 LOT No.36, TRACT No. 4  
 CONCORD TWP. - LAKE COUNTY - OHIO

Date: 4/11/2016  
 Scale: Hor. 1"=60'  
 Vert. \_\_\_\_\_  
 Filename: 16-049  
 Tab Name: \_\_\_\_\_  
 Computer: \_\_\_\_\_

**Jones Surveying, LLC**  
 ENGINEERS - SURVEYORS - PLANNERS  
 1924 MENTOR AVE., PAINESVILLE, OHIO  
 (PH.) 440-357-1811 (FAX) 440-357-9173  
 (E-MAIL) hjonesurveying@yahoo.com

Sheet 1 of 1  
 Contract No. 16-049