

Plat of Survey

for
Dianne Crompton
 Kellogg Road
 Lot No. 16, Tract No. 4
 Concord Twp. - Lake County - Ohio
 September 2016 Scale 1"=50'

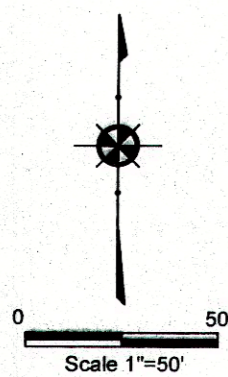

MORLEY ROAD - (VARIES)

RICHARD & SUSAN HANSEN
 2014R027960
 8A-26-36

JOEPH & CHRISTINA BOZIC
 2010R005841
 8A-26-74

| | |
|-------------|-----------|
| ORIGINAL | 1.067 Ac. |
| + SPLIT "A" | 0.597 Ac. |
| BALANCE | 1.664 Ac. |
| -R/W | 0.067 Ac. |
| NET | 1.597 Ac. |

NORVIL & MARY DULANEY
 VOL. 681, PG. 1046
 8A-26-39

DIANNE CROMPTON
 2009R018771
 8A-26-15

SPLIT "A"
 0.597 Ac.

| | |
|-------------|-----------|
| ORIGINAL | 1.931 Ac. |
| + SPLIT "B" | 0.120 Ac. |
| BALANCE | 2.051 Ac. |
| -R/W | 0.083 Ac. |
| NET | 1.968 Ac. |

GINGER LEROUX
 2007R011127
 8A-26-14

SPLIT "B"
 0.120 Ac.

R/W ESTABLISHED FOR HIGHWAY
 PURPOSES AS DESCRIBED IN THE
 APPROPRIATION PROCEEDING AT CIVIL
 DOCKET 7 PG. 117 OF THE RECORDS IN
 THE PROBATE COURT OF LAKE
 COUNTY, OHIO.

KELLOGG ROAD - (VARIES)
 RELOCATED ON VOL. N, PG. 17
 STATE ROUTE 90

NOTES:

This plat was prepared without the benefit of an abstract of title and is subject to any state of facts revealed by a examination of the same.

Documents used in preparation of this survey are cited on the plat.

Occupation is consistent with the title lines except where noted on survey.

Size of monumentation found or set is noted on plat.

All iron pins set are 5/8" x 30" and are capped H. JONES PLS6343

Bearings are based upon the centerline of Morley Road as being North 25°35'15" East and are used to describe angles only.

SURVEY CERTIFICATION

I hereby certify that this plat was prepared from a field survey made under my direct supervision. Monuments were found or set as indicated. Dimensions are expressed in feet and decimal parts thereof. All of which are correct to the best of my knowledge and belief. This plat was prepared in accordance with the provisions of Chapter 4733-37 of the Ohio Administrative Code. All Iron Pins Set are 5/8" x 30" long rebar and capped "H. Jones - 6343".

Harry S. Jones Jr. #6343
 Harry S. Jones Jr. P.S. #6343
 10/3/16
 Date

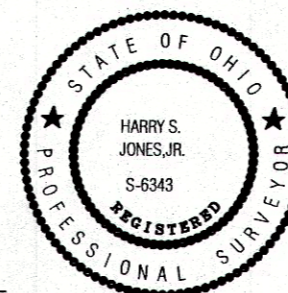

| REVISIONS | | | DRAWN BY | SCALE | DATE | PHONE NO. |
|-----------|-----------|-----|------------|--------|-----------|--------------|
| NO. | DATE | BY | | | | |
| 1 | 10/3/2016 | CAD | GMB | 1"=50' | 9/29/2016 | 440-357-1811 |
| 2 | | CAD | | | | |
| 3 | | | CHKD. | HSJ | | |
| 4 | | | CREW CHIEF | APPD | | |
| 5 | | | | | | 16-212 |



Jones Surveying, LLC

ENGINEERS - SURVEYORS - PLANNERS
 1924 MENTOR AVE., PAINESVILLE, OHIO
 (PH.) 440-357-1811 (FAX) 440-357-9173
 (E-MAIL) tjonessurveying@yahoo.com