

MAP OF SURVEY FOR
GOLDMAN SACHS LENDING PARTNERS LLC,
 as administrative agent
CHICAGO TITLE INSURANCE COMPANY

SITUATED IN THE TOWNSHIP OF CONCORD, COUNTY OF LAKE, AND
 STATE OF OHIO, AND KNOWN AS BEING PART OF ORIGINAL CONCORD
 TOWNSHIP LOT Nos. 12 AND 13, TRACT 3

I HEREBY STATE THAT THIS MAP IS BASED ON AN ACTUAL FIELD SURVEY PREPARED BY ME. THE
 SURVEY IS CORRECT TO THE BEST OF MY KNOWLEDGE, INFORMATION AND BELIEF. PERMANENT
 MONUMENTS WERE FOUND OR SET AT ALL LOCATIONS SHOWN HEREON. ALL DIMENSIONS GIVEN ARE
 EXPRESSED IN FEET AND DECIMAL PARTS THEREOF. BEARINGS ARE BASED ON GRID NORTH OF THE
 OHIO STATE PLANE COORDINATE SYSTEM NORTH ZONE, NAD 83 DATUM.

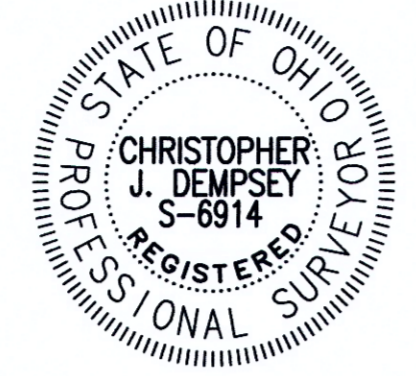

Christopher J. Dempsey
 7/30/2019
 CHRISTOPHER J. DEMPSEY
 PROFESSIONAL SURVEYOR NO. 6914
 JULY 29, 2019

DEMPSEY SURVEYING COMPANY
 215/228-1130 12815 DETROIT AVENUE
 216/228-1131 CLEVELAND, OH 44107-2835

QUAIL HIGHLANDS PHASE III
 VOL. 64, PG. 12 L. C. M. R.

S/L 6
 PPN 08-A-020-A-00-010-0
 CONCORD REAL ESTATE INVESTMENTS, LLC
 DOC. No. 2005R051311 L. C. R.

S/L 7
 PPN 08-A-020-A-00-011-0
 IP VISTA SPRINGS CONCORD PROPCO LLC
 DOC. No. 2016R022524 L. C. R.

PPN
 08-A-020-0-00-031-0
 NANCY W. CHERRY
 DOC. No. 2009R017080
 S 89°21'19" W 30.19'
 L. C. R.
 5/8" IRON PIN FD.
 T. J. NEFF 7065"

ABBREVIATIONS

- Dd. - DEED
- MSD. - MEASURED
- ACT. - ACTUAL
- CALC. - CALCULATED
- OBS. - OBSERVED
- TD. - TURNED
- FD. - FOUND
- ENCR. - ENCROACHES
- CLRS. - CLEARS
- ASPH. - ASPHALT
- CONC. - CONCRETE
- SUBJ. - SUBJECT
- CONT. - CONTIGUOUS
- U.G. - UNDERGROUND
- O.H. - OVERHEAD

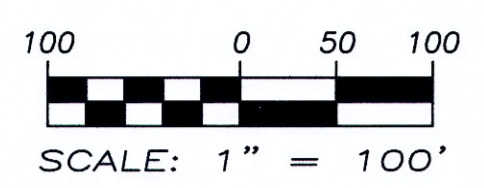

• DENOTES 5/8" IRON PIN SET
 WITH "DEMPSEY P.S. 6914" CAP
 (UNLESS OTHERWISE NOTED)
 X MAG NAIL SET

**LITTLE MOUNTAIN
 COUNTRY CLUB SUBDIVISION**
 VOL. 39, PG. 13 L. C. M. R.

PPN 08-A-020-A-00-011-0
 B. BLOCK "A" LOT 10
 DOC. No. 2017R022519 L. C. R.

RANPAK CORP.
 O. R. VOL. 1190, PG. 1229 L. C. R.
 PART OF PARCEL No. 2

AREA ON O. L. 12 1,325,705 SQUARE FEET 30.4340 ACRES
 AREA ON O. L. 13 512,843 SQUARE FEET 11.7733 ACRES
TOTAL AREA ... 1,838,548 SQUARE FEET ... 42.2073 ACRES
 INCLUDING 11,919 SQUARE FEET (0.2736 ACRE) WITHIN R/W

PPN 08-A-021-0-00-018-0

RANPAK CORP.
 O. R. VOL. 1190, PG. 1229 L. C. R.
 PART OF PARCEL No. 1

PPN 08-A-021-0-00-018-0
 RANPAK CORP.
 DOC. No. 2002R022196 L. C. R.

PPN 08-A-021-0-00-080-0
 B.E. PARTNERSHIP
 DOC. No. 2003R047645 L. C. R.

S/L 20
 PPN 08-A-027-C-00-020-0
 THISTLE HOLDINGS, LLC
 DOC. No. 2010R012512 L. C. R.

PPN 08-A-021-0-00-068-0
 JEFFREY & MICHELE GORMAN
 DOC. No. 2014R015388 L. C. R.

PPN 08-A-021-0-00-074-0
 8090 AUBURN, LLC.
 DOC. No. 2014R025433 L. C. R.

PLACE OF BEGINNING
 SURVEY LEGAL DESCRIPTION
 3/4" IRON PIPE
 FD. & USED
 N 00°44'19" E
 203.98' C. S. R.
 203.90' OBS.
GIRDLED ROAD (60') (PUBLIC)

AUBURN ROAD (60')
 (PUBLIC)
 3196.84' C.S.R. 3196.71' OBS.