

BRIDGECREEK DRIVE
60' RW

CAPPED 5/8" IRON PIN FOUND & USED WITHIN A MON BOX ASSEMBLY "LDC"

S 21°22'44" E
408.94' OBS
PLAT VOL. 50, PG. 3

CAPPED 5/8" IRON PIN FOUND & USED WITHIN A MON BOX ASSEMBLY "LDC"

S 172°5'06" W
1725.06' OBS
S 69°55'53" W
139.72' OBS
PROUTY ROAD
60' RW

1" IRON PIPE FOUND & USED AT 32.53' CL

POB
3/4" IRON PIPE FOUND & USED AT 32.28' CL

3/4" IRON PIPE FOUND & USED AT 32.21' CL

ITEM OF INTEREST
SUBJECTS CHAIN LINK FENCE IS OVER THE LINE AS SHOWN

S 03°03'11" E
919.71' OBS - 919.63' DEED

2.6605 ACRES
#11150
TRACY E. ARCURI
DOC. 2005R032931
PPN 08-A-018-A-00-070-0

873.76' OBS - 873.57' DEED
N 02°45'30" W

#11130
S.E. KRAUSE
DOC. 2005R032931
PPN 08-A-018-A-00-025-0

LINE	BEARING	DISTANCE
L 1	N 65°54'20" E	51.56' DEED MEAS
L 2	N 66°59'53" E	83.92' OBS - 84.01' DEED
L 3	S 21°22'44" E	30.01' PLAT OBS

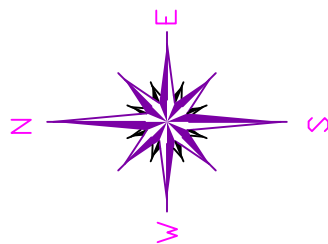

BASIS OF BEARINGS ARE TO AN ASSUMED MERIDIAN ALONG THE CENTERLINE OF PROUTY ROAD NORTH 66°-59'-53" EAST

LAKE METRO PARKS
VOL. 442, PG. 1
PPN 08-A-018-A-00-047-0

#11189
LAKE METRO PARKS
DOC. 1996R044387
PPN 08-A-018-A-00-046-0

#11189
LAKE METRO PARKS
DOC. 1996R044387
PPN 08-A-018-A-00-045-0

OBS 98.28'
DEED 131.84'
OBS 131.50'
DEED 131.50'
S 86°25'53" W

1" IRON PIPE FOUND & USED

3/4" IRON PIPE FOUND & USED

1" IRON PIPE FOUND S 03°03'11" E, 0.16' FROM THE CORNER

LEGEND

- IRON PIN FOUND/SET
- ⊙ IRON PIPE
- STONE MONUMENT
- ⊠ MONUMENT BOX
- ⊙ P.K. NAIL FOUND/SET
- DRILL HOLE FOUND
- CALC CALCULATED
- MEAS MEASURED
- OBS OBSERVED
- DEED DEED RECITED
- PLAT PLAT RECITED

NOTES & REFERENCES

- ALL IRON PIN SET ARE 5/8" X 30" REBAR WITH CAP "CRABBS 7245".
- DEEDS OF RECORD
- OCCUPATION AGREES WITH TITLE LINES AS PREVIOUSLY MONUMENTED EXCEPT AS SHOWN ON THIS PLAT

THIS SURVEY WAS PERFORMED TO AN ACCURACY AS SET FORTH IN THE 2003 OHIO ADMINISTRATIVE CODE 4733-37.

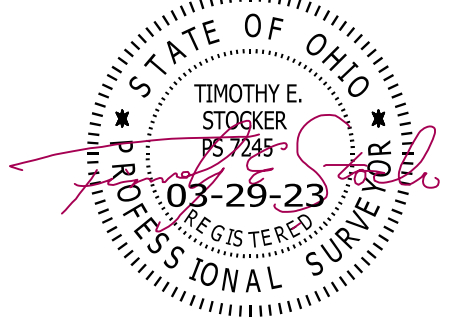

TIMOTHY E. STOCKER, P.S. 7245



SCALE: 1" = 100'
SURVEY: MARCH 28, 2023
MAP: MARCH 29, 2023

PREPARED FOR: TRACY E. ARCURI	PROJECT NAME: RESURVEY OF LANDS	PROJECT ADDRESS: 11150 PROUTY ROAD CONCORD, OHIO
	PROJECT LOCATION: LAKE COUNTY, OHIO	JOB NUMBER: 9157
FOR INQUIRIES CONCERNING THIS SURVEY CONTACT: CSS CRABBS' SURVEYING SERVICE P.O. BOX 908 PAINESVILLE, OHIO 44077 440-466-2025		CHK: T. STOCKER, SR CALC: T. STOCKER, JR SIT DRN: S. HUPERTZ REV:
PAGE 1 OF 1		