

DEVONSHIRE SUBDIVISION  
VOL. 22 - PG. 4

S/L No. 13  
HENRY M. & ELIZABETH A. COVETTA  
No. 1997R030061  
8A-15J-13

DANIEL J. & CHERYL L. GILLESPIE  
VOL. 943 - PG. 278  
8A-18A-16

TINA KAVAL &  
MICHAEL J. WOODIN  
No. 2006R016958  
8A-18A-15

MICHAEL D. SHULTZ & JUDY RAE SHOCKEY  
No. 2003R074245  
8A-18A-14

TOTAL - 4.260 Ac.  
R/W - 0.094 Ac.  
NET - 4.166 Ac.

CHARLES D. SHULTZ Jr. & RUTH ANN SHULTZ  
No. 2011R028653  
8A-18A-13

TOTAL - 1.001 Ac.  
R/W - 0.065 Ac.  
NET - 0.936 Ac.

RICHARD & JUDITH L. CARLISLE  
VOL. 137 - PG. 842  
8A-18A-12

BRIDGE CREEK DRIVE - 60'

PROUTY ROAD - 60'

2" IRON PIPE FND

N 81°36'38" E 254.44'

1" IRON PIPE FND

S 19°08'12" E 413.35'

5/8" IP FND "BABCOCK, JONES & ASSOC."

S 69°09'30" W 100.00'

5/8" IP FND "BABCOCK, JONES & ASSOC."

S 19°08'12" E 382.15'

5/8" IP FND "BABCOCK, JONES & ASSOC."

S 69°09'30" W 94.08'

5/8" IP FND "BABCOCK, JONES & ASSOC."

N 19°08'12" W 463.60'

N 19°08'12" W 463.60'

5/8" IP FND "BABCOCK, JONES & ASSOC."

5/8" IP FND "BABCOCK, JONES & ASSOC."

S 69°09'30" W 1169.51'

S 69°09'30" W 136.00'

S 69°09'30" W 94.08'

5/8" IP FND "BABCOCK, JONES & ASSOC."

INGRESS & EGRESS EASEMENT  
0.020 Ac.

S 19°08'12" E 268.00'

N 32°01'12" W 89.66'

N 79.99'

5/8" IP FND "BABCOCK, JONES & ASSOC."

1" IRON PIPE FND

30.41'

180.00'

88.00'

20.00'

GRAPHIC SCALE

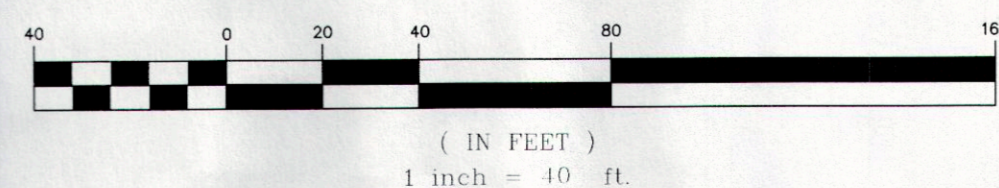

NOTE: ALL IRON PINS SET ARE  
5/8" X 30" AND ARE CAPPED  
BABCOCK LAND SURVEYORS

EXISTING UTILITIES NOTE:  
THE SIZE AND LOCATION, BOTH HORIZONTAL AND VERTICAL  
OF THE UNDERGROUND UTILITIES SHOWN HEREON, HAVE BEEN  
OBTAINED BY A SEARCH OF AVAILABLE RECORDS.  
VERIFICATION BY FIELD OBSERVATION HAS BEEN CONDUCTED  
WHERE PRACTICAL. HOWEVER, BABCOCK LAND SURVEYORS  
DOES NOT GUARANTEE THE COMPLETENESS NOR ACCURACY  
THEREOF.

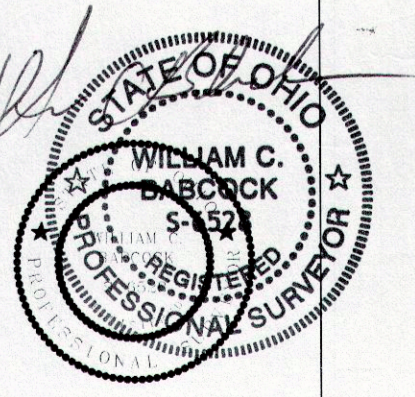

BABCOCK LAND SURVEYORS  
SURVEYORS & LAND PLANNERS  
PAINESVILLE OHIO 44077  
babcocklandsurveyors@yahoo.com

11/5/12
W.B.
B.P.
W.B.
R.B.

PLAT OF SURVEY  
FOR  
MICHAEL D. SHULTZ & JUDY RAE SHOCKEY  
PART OF LOT No. 4 - TRACT No. 2 & LOT'S No. 6 & 7, TRACT No. 3  
PROUTY ROAD (P.P.#S 8A-18A-14 & 8A-18A-13)  
CONCORD TOWNSHIP LAKE COUNTY STATE OF OHIO

1"=40'
12-31
1 / 1