

BEARINGS ARE BASED ON  
NAD 83, OHIO STATE PLANE NORTH 3401,  
1986 ADJUSTMENT AND ARE INTENDED TO DENOTE THE  
RELATIONSHIP BETWEEN ANGLES  
ONLY.

# PLAT OF SURVEY FOR THE

## CONCORD TOWNSHIP TRUSTEES

SITUATE IN THE TOWNSHIP OF CONCORD, COUNTY OF LAKE  
AND STATE OF OHIO AND PART OF ORIGINAL LOT NUMBERS 4 AND 11,  
TRACT NUMBERS 1 AND 2 OF TOWNSHIP 10 NORTH, RANGE 8 WEST  
IN THE CONNECTICUT WESTERN RESERVE

IT IS THE INTENT OF THIS SURVEY TO SPLIT 1 ACRE OUT OF P.P.N. 08A-014-0-00-008-0.

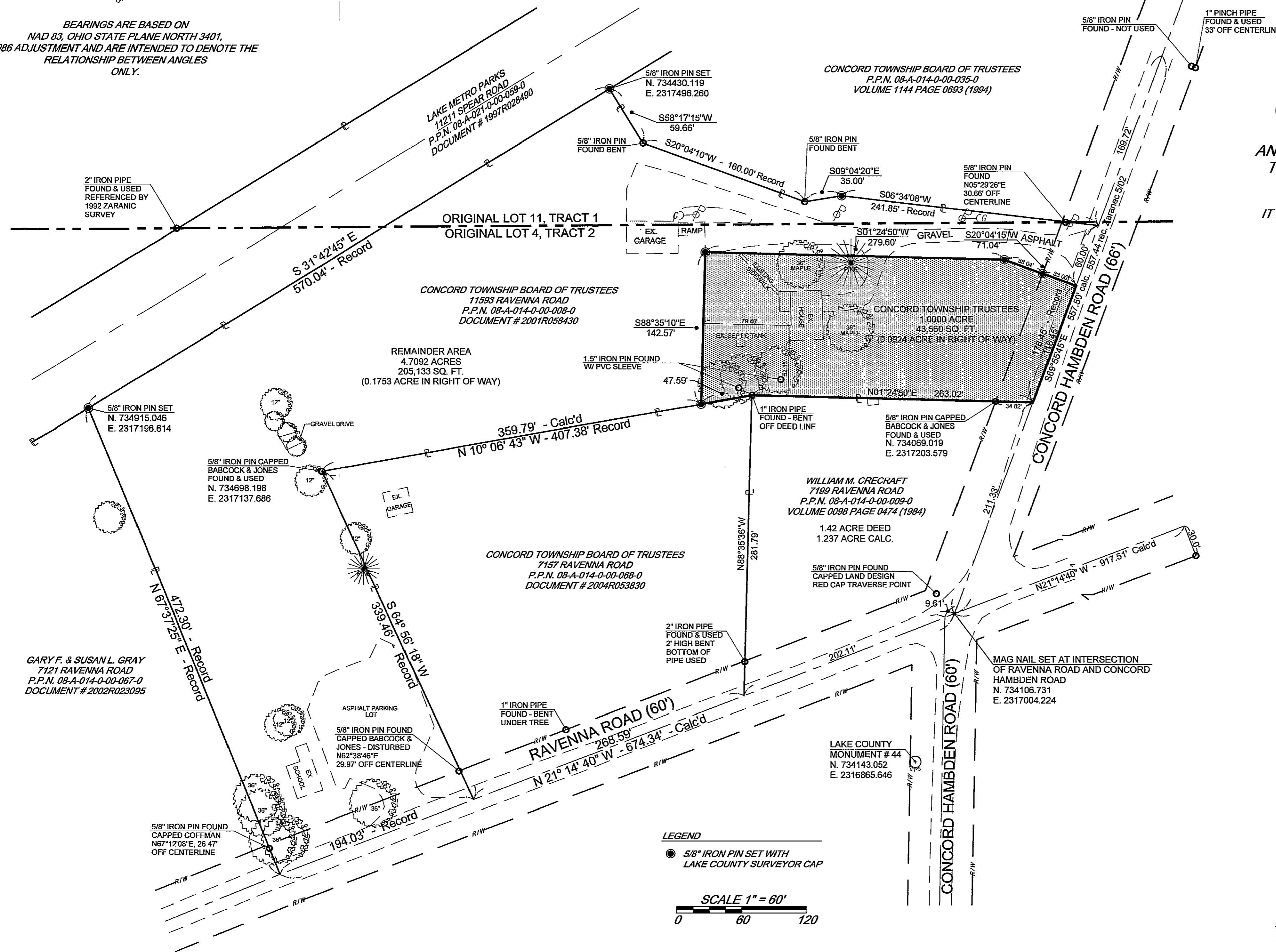

This Plat represents a field survey made under the supervision  
of the office of the Lake County Engineer's Survey Department.  
It is an opinion based upon recorded deeds and the existing evidence  
found in the field. All distances are expressed in feet and decimal parts  
thereof in accordance with Ohio Administrative Code 4733-37.  
Monuments were found or set as indicated.

*Mitchell A. Ferguson*  
Date: May 25, 2006  
Mitchell A. Ferguson, P.S. 7627  
Chief Surveyor for the Lake County Engineer

LEGEND  
● 5/8" IRON PIN SET WITH LAKE COUNTY SURVEYOR CAP

SCALE 1" = 60'  
0 60 120