

Lot Split Plat

Situated in the Township of Concord, County of Lake and State of Ohio. Known as being part of Original Township Lot 8, Tract 1, Further being a combination of sublots 31 & 32 and then subsequent lot splits in the Cali Woods Subdivision No.2 recorded in volume 31, page 4 of Lake County Plat Records.

July, 2005

● Denotes 5/8" Iron Pin Set
 (S/L) Denotes Recorded Sublot No. from plat

CURVE TABLE						
CURVE	LENGTH	RADIUS	DELTA	TANGENT	CHORD	BEARING
C-7	671.95	500.00	77°00'00"	397.72	622.51	S15°14'00"E
C-7A	335.98	500.00	38°30'00"	174.61	329.69	N04°01'00"E
C-7C	329.32	530.00	35°36'03"	170.17	324.05	N05°27'58"E
C-25	25.52	530.00	2°45'32"	12.76	25.52	S21°53'14"W
C-26	105.26	530.00	11°22'45"	52.80	105.09	S14°49'06"W
C-27	102.46	530.00	11°04'35"	51.39	102.30	S03°35'26"W
C-28	96.08	530.00	10°23'13"	48.17	95.95	S07°08'27"E

I hereby certify that this plat was prepared from a field survey made under my direct supervision. Monuments were found or set as indicated. Dimensions are expressed in feet and decimal parts thereof. Bearings used hereon refer to the plat of Cali Woods Subdivision No. 2 recorded in volume 31, page 4 of LCPR. All of which are correct to the best of my knowledge and belief. This plat was prepared in accordance with the provisions of Chapter 4733-37 of the Ohio Administrative Code. This plat was prepared without the benefit of an abstract of title and is subject to any state of facts revealed by an examination of the same.

James R. Pegoraro, Jr. 8-205
 James R. Pegoraro, Jr., P.S.#8150

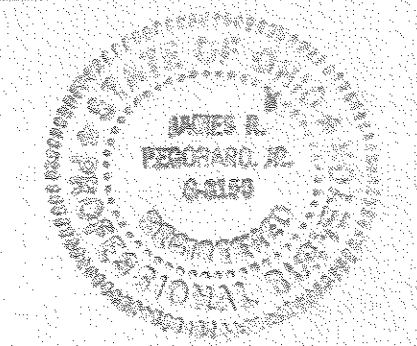

Area Tabulation

Combined Parcel 8A-4D-31 & 32
 = 3.7605 Ac. (163,806 sf) Total

- Split 31A= 1.0113 Ac. 44,053 sq.ft.
- Split 31B= 1.0142 Ac. 44,178 sq.ft.
- Split 32A= 1.1031 Ac. 48,052 sq.ft.
- Remainder= 0.6319 Ac. 27,523 sq.ft.
 (To be combined with PPI 8A-4D-33)

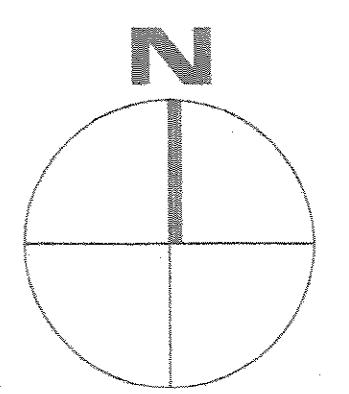
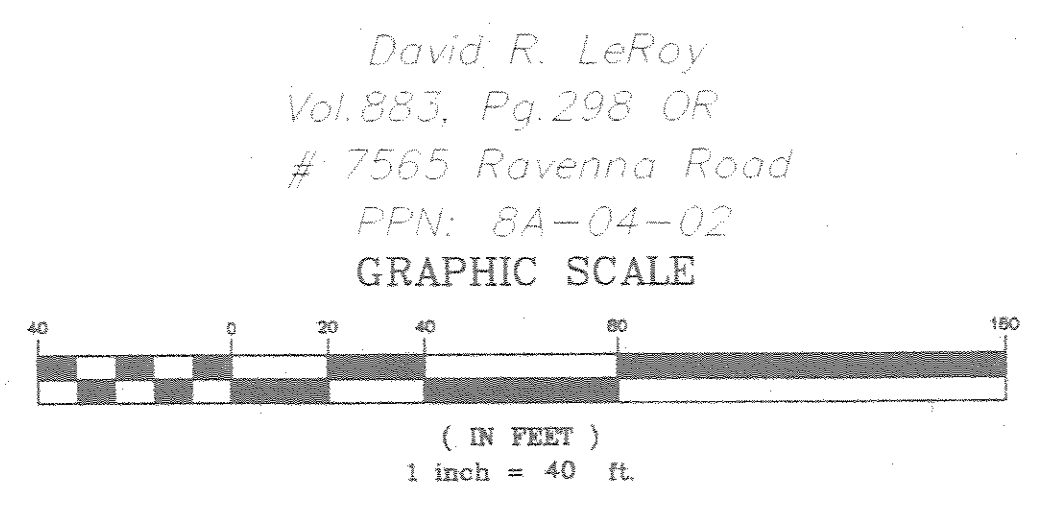

REV. No.	DATE	BY	CHKD	 LAND DESIGN consultants www.LDCinc.net ENGINEERS PLANNERS SURVEYORS 8885 East Avenue, Mentor, Ohio 44060 1502 Lear Ind. Park, Suite 1A, Avon, 44011 TEL: (440) 255-8963 (440) 961-1410 TEL: (440) 937-6601 (440) 937-6602 (440) 254-8938 FAX: (440) 255-9676 FAX: (440) 937-6602	Cali Woods Subdivision No.2 Sublot 31 & 32 Concord Township - Lake County - Ohio	DATE 7/27/05	SHEET 1 OF 1 Lot Split Plat - 3 CONTRACT No. Acket1-0301
						SCALE: HOR 1"=40'	
						VERT. _____	
						FILENAME Resubplat	
						COMPUTER S. _____ TAB NAME split-3	