

REV. NO.	COMMENTS	DATE	BY
1	Rename Parcels "A" & "B", Add Parcels "C" & "D" Per LCTM	11/14/17	RAT
2	Minor Changes to Parcels A,B,C, & D Per LCTM	11/30/17	RAT

# Plat of Lot Split for Joseph Madachy

Known as Being a part of Lot 7, Tract 1, Original Concord Township 10 North,  
Range 8 West of the Connecticut Western Reserve  
Concord Township - Lake County - Ohio  
Nov. 2017 Scale 1"=100'

● = 5/8 X 30 INCH IRON PIN  
SET W/YELLOW I.D.  
CAP STAMPED "POLARIS S-7087"

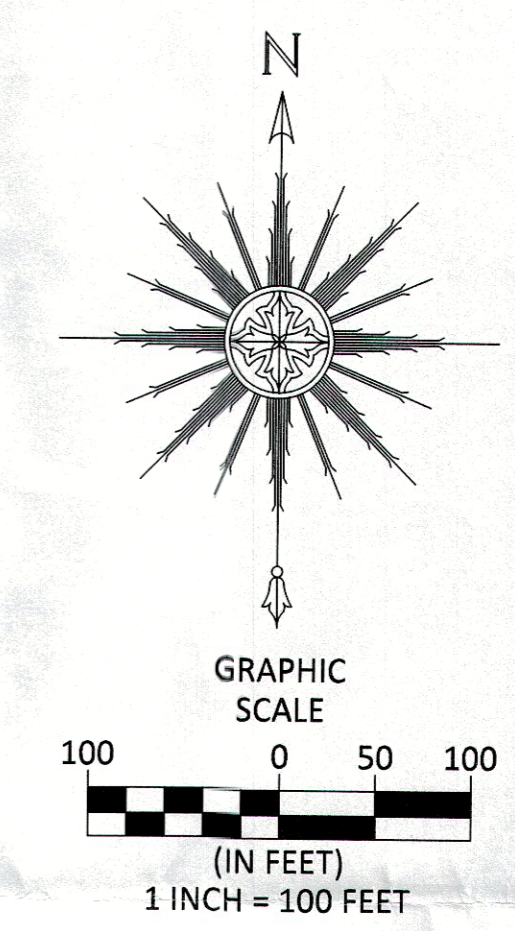

**BOUNDARY CERTIFICATION:**

I HEREBY CERTIFY THAT I HAVE SURVEYED THE PREMISES AND PREPARED THE ATTACHED PLAT IN ACCORDANCE WITH THE PROVISIONS OF CHAPTER 4733-37 OF THE OHIO ADMINISTRATIVE CODE AND THE DIMENSIONS ARE IN FEET AND DECIMAL PARTS THEREOF, ALL OF WHICH ARE CORRECT TO THE BEST OF MY KNOWLEDGE AND BELIEF. IRON MONUMENTS OR PINS AS INDICATED WERE FOUND OR SET AS SHOWN HEREON. THE TERM CERTIFY AS USED IN THIS STATEMENT IS UNDERSTOOD TO BE THE PROFESSIONAL OPINION OF THE SURVEYOR WHICH IS FORMULATED ON HIS BEST KNOWLEDGE, INFORMATION AND BELIEF, AND AS SUCH, IT DOES NOT CONSTITUTE A GUARANTEE OR WARRANTY, EITHER EXPRESSED OR IMPLIED. THIS PLAT WAS PREPARED WITHOUT THE BENEFIT OF AN ABSTRACT OF TITLE AND IS SUBJECT TO ANY STATE OF FACTS REVEALED BY AN EXAMINATION OF THE SAME. ALL IRON PINS SET ARE 5/8" X 30" LONG REBAR WITH A PLASTIC CAP STAMPED "POLARIS". BEARINGS REFER TO THE OHIO COORDINATE SYSTEM OF 1983 - NORTH ZONE 1986 ADJUSTMENT.

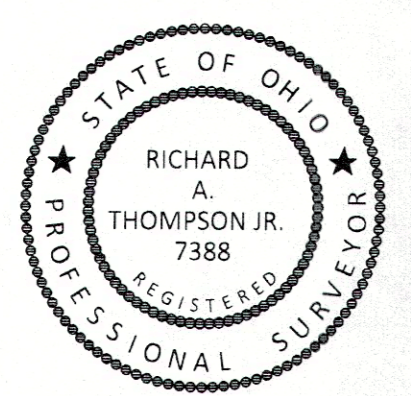

*Richard A. Thompson Jr.*  
RICHARD A. THOMPSON, JR.  
OHIO PROFESSIONAL SURVEYOR #7388

DATE: 11/30/17  
SCALE: HOR. 1"=100'  
VERT. 1"=00'  
FOLDER: Survey  
FILE: Survey Base  
TAB: Lot Split Ph. 1  
DRAWN: CAD

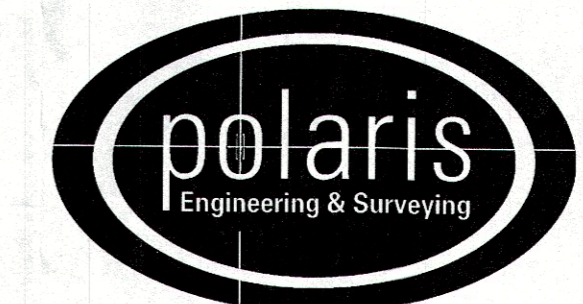

POLARIS ENGINEERING  
and SURVEYING, INC.  
34600 CHARDON ROAD - SUITE D  
WILLOUGHBY HILLS, OHIO 44094  
(440) 944-4433 (440) 944-3722 (Fax)  
www.polaris-es.com

CONTRACT	
17009	
SHEET	OF
01	01