

Lot Split Parcel #1
 1.5000 Acres
 (65,340.10 S.F.)
 (58,814.29 S.F. or
 1.3502 Acres Ex. R/W)
 Add.#6421 Vrooman Road

Remaining Parcel
 8.4965 Acres
 (370,107.40 S.F.)
 (368,307.4 S.F. or
 8.4552 Acres Ex. R/W)

- LEGEND-SURVEY**
- IPS IRON PIN SET W/CAP
 - IPF IRON PIN FOUND
 - IPPS IRON PIPE SET
 - IPPF IRON PIPE FOUND
 - DHF DRILL HOLE FOUND
 - DHS DRILL HOLE SET
 - SMNS "SURVEY MARK" NAIL SET
 - SMNF "SURVEY MARK" NAIL FOUND
 - IPMF IRON PIN MONUMENT FOUND
 - RPS REFERENCE PIN SET
 - RPF REFERENCE PIN FOUND
 - RRSS RAILROAD SPIKE SET
 - RRSF RAILROAD SPIKE FOUND
 - MNS "MAG" NAIL SET
 - MNF "MAG" NAIL FOUND
 - PKS "PK" NAIL SET
 - PKF "PK" NAIL FOUND
 - MON MONUMENT
 - FND FOUND
 - D. DEED
 - R/REC RECORD
 - M/MSD MEASURED
 - O/OBS OBSERVED
 - C/CALC CALCULATED
 - ACT. ACTUAL
 - U. USED
 - D.R. DEED RECORD
 - C/L CENTERLINE
 - ENC. ENCROACHMENT
 - CLR. CLEAR

SURVEYOR CERTIFICATION

I HEREBY CERTIFY THAT I HAVE SURVEYED THE PREMISES AND PREPARED THE ATTACHED PLAT IN ACCORDANCE WITH THE PROVISIONS OF CHAPTER 4733-37 OF THE OHIO ADMINISTRATIVE CODE AND THE DIMENSIONS OF THE LOTS AND ROAD ARE IN FEET AND DECIMAL PARTS THEREOF, ALL OF WHICH ARE CORRECT TO THE BEST OF MY KNOWLEDGE AND BELIEF. IRON MONUMENTS OR PINS AS INDICATED WERE FOUND OR SET AS SHOWN HEREON.

DANIEL LAUX P.S. #7087 DATE _____

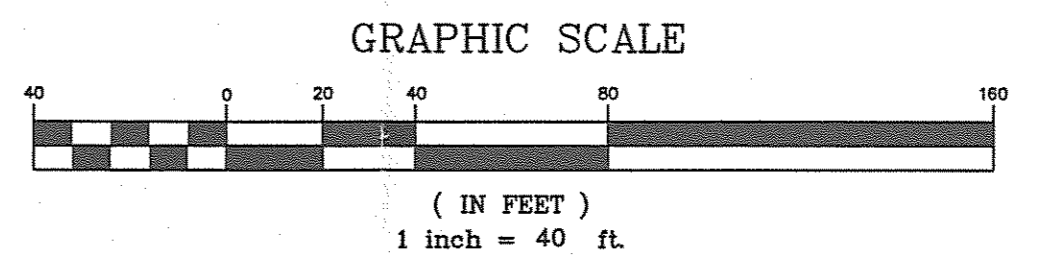
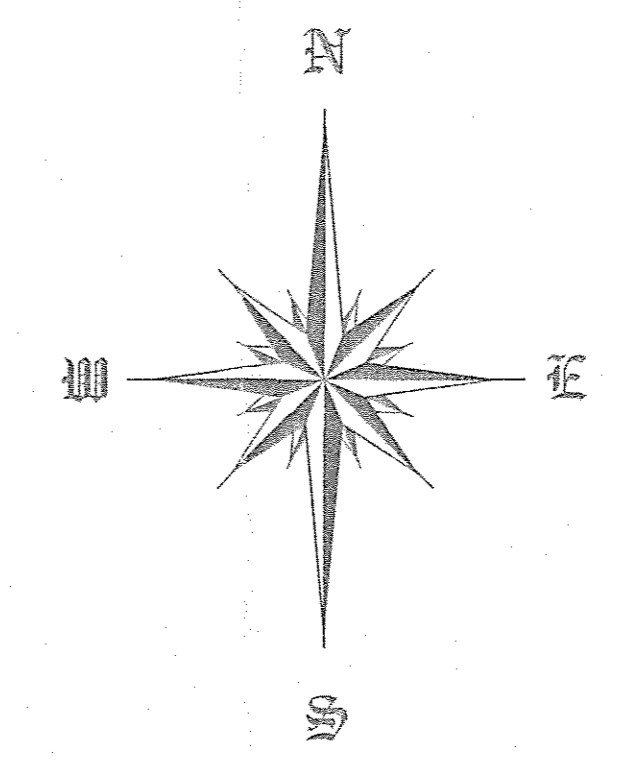
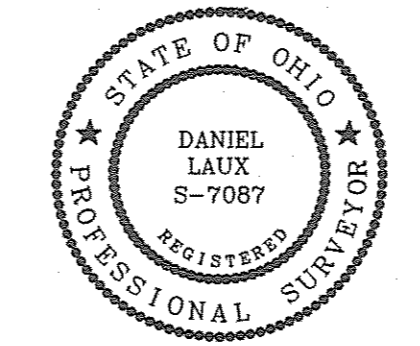

Basis Of Bearings:
 Basis Of Bearings Refer To The Centerline Of Vrooman Road, As Described In The Legal Description For Subject Parcel, And Recorded In Doc.#199957387 Of L.C.R.

DATE: 6-25-06
 SCALE: HOR. 1"=40'
 VERT. _____
 FOLDER: Plats
 FILENAME: Lot_Split.dwg
 TAB: Lot_Split_Plat
 DRAWN: G.S.V.

Lands Shown Are Known As Being Part Of Original Leroy Township Lot No.45, Situated Now In The Township Of Leroy, County Of Lake, State Of Ohio.

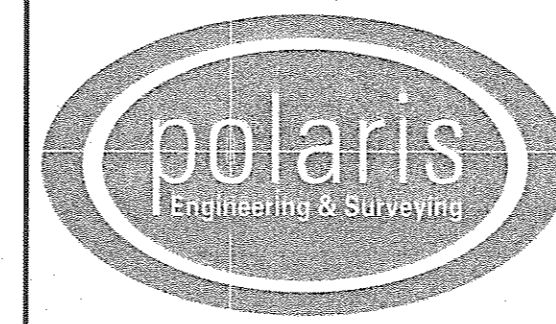

POLARIS ENGINEERING & SURVEYING, INC.
 34600 CHARDON ROAD - SUITE D
 WILLOUGHBY HILLS, OHIO 44094
 (440) 944-4433 (440) 944-3722 (Fax)
 www.polaris-es.com

Plat Of Lot Split

CONTRACT No.	
06018	
SHEET	OF
1	1