

**LOT SPLIT FROM PP# 05A-017-0-00-050-0**

BEING PART OF ORIGINAL PERRY TOWNSHIP LOT 111 IN THE VILLAGE OF NORTH PERRY  
 COUNTY OF LAKE - STATE OF OHIO

*LOCKWOOD ROAD (FKA LAKE ROAD) 60' WIDE*

MON. BOX  
 W/ 1/2" IRON F

**GRAPHIC SCALE**



DISTANCES ARE GIVEN IN FEET AND DECIMAL PARTS THEREOF UNLESS OTHERWISE NOTED. SURVEYED DEC., 2023 THIS PLAT WAS PREPARED UNDER MY SUPERVISION AND IS CORRECT TO THE BEST OF MY KNOWLEDGE AND BELIEF AND IN ACCORDANCE WITH THE PROVISIONS OF CHAPTER 4733-37 OF THE OHIO ADMINISTRATIVE CODE.

*David A. Rapp* 02/06/24

DAVID A. RAPP P.S. No. 7597

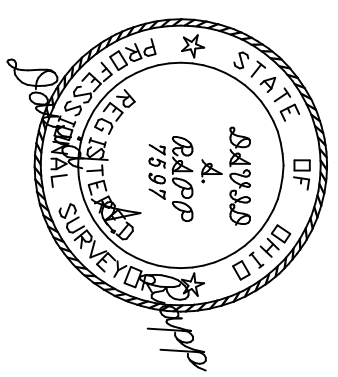

EMILY AND FREDERICK HARRELL  
 PP#05A-017-0-00-023-0  
 DOC. No. 2022R024144

SOURCES:  
 DEEDS AND PLATS AS NOTED

ALL IRON PINS SET ARE 5/8" (30" OF LENGTH) AND ARE IDENTIFIED BY A PLASTIC CAP BEARING THE IMPRINT "7597".

DAVID RAPP SERVICES

dave@usaqeq.com

(440) 983-1607

5/8" IRON PIN FD.

N 88°36'34" E 355.06'

5/8" IRON PIN FD. @ 25.00'

SAMUEL G. AND SARAH J. KLCO  
 PP#05A-017-0-00-050-0  
 DOC. No. 2022R027381

RESIDUAL PARCEL

60,124 sq.ft.  
 1.3803 acres  
AREA IN R.O.W.  
 4,250 sq.ft.  
 0.0976 acres

N 02°19'48" W 168.72'

5/8" IRON PIN SET

S 88°48'56" W 355.08'

PARCEL "A"  
 35,501 sq.ft.  
 0.8150 acres  
AREA IN R.O.W.  
 2,501 sq.ft.  
 0.0574 acres

5/8" IRON PIN FD.

S 88°48'56" W 355.08'

5/8" IRON PIN SET @ 25.00'

S 02°19'48" E 1366.76'

S 02°19'48" E 100.00'

*MADISON TOWNSHIP*

*50' R/W*

*TOWNSHIP ROAD*

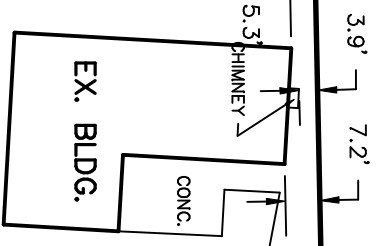
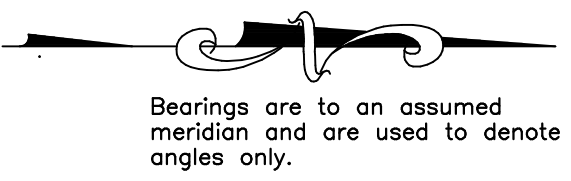

STONE DRIVE

SIDEWALK

EX. PAVEMENT

GREENHOUSE (TYP.)

43069