

Plat of Lot Split

Being a part of Original Lot 66 of Original Perry
 Township 11 North, Range 7 West of the Connecticut Western Reserve
 Village of Perry - Lake County - Ohio
 Sept. 2016 Scale 1"=50'

BOUNDARY CERTIFICATION:

I HEREBY CERTIFY THAT I HAVE SURVEYED THE PREMISES AND PREPARED THE ATTACHED PLAT IN ACCORDANCE WITH THE PROVISIONS OF CHAPTER 4733-37 OF THE OHIO ADMINISTRATIVE CODE AND THE DIMENSIONS ARE IN FEET AND DECIMAL PARTS THEREOF, ALL OF WHICH ARE CORRECT TO THE BEST OF MY KNOWLEDGE AND BELIEF. IRON MONUMENTS OR PINS AS INDICATED WERE FOUND OR SET AS SHOWN HEREON. THE TERM CERTIFY AS USED IN THIS STATEMENT IS UNDERSTOOD TO BE THE PROFESSIONAL OPINION OF THE SURVEYOR WHICH IS FORMULATED ON HIS BEST KNOWLEDGE, INFORMATION AND BELIEF, AND AS SUCH, IT DOES NOT CONSTITUTE A GUARANTEE OR WARRANTY, EITHER EXPRESSED OR IMPLIED. THIS PLAT WAS PREPARED WITHOUT THE BENEFIT OF AN ABSTRACT OF TITLE AND IS SUBJECT TO ANY STATE OF FACTS REVEALED BY AN EXAMINATION OF THE SAME. ALL IRON PINS SET ARE 5/8" X 30" LONG REBAR WITH A PLASTIC CAP STAMPED "POLARIS". BEARINGS REFER TO THE OHIO COORDINATE SYSTEM OF 1983 - NORTH ZONE 1986 ADJUSTMENT.

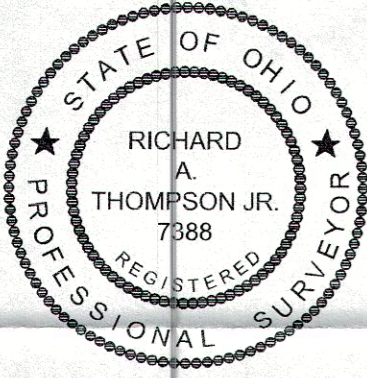

RICHARD A. THOMPSON, JR.
 OHO PROFESSIONAL SURVEY #7388

● = 5/8 X 30 INCH IRON PIN
 SET W/YELLOW I.D.
 CAP STAMPED "POLARIS 5-7087"

*Surveyed by Crabbs Surveying
 (4-2001)*

*Surveyed by Benchmark
 Surveying
 (9-2004)*

FIFTH THIRD BANK
 DOCUMENT: 2010R021512
 P.P.N. 04-A-036-0-00-001-0
 #3770 CENTER RD

RICHARD W DAME
 DOCUMENT: 2004R052048
 P.P.N. 04-A-036-0-00-039-0
 # 3754 CENTER RD

VILLAGE OF PERRY
 VOL. 798, PG. 1083 D.R.
 P.P.N. 04-A-036-0-00-030-0
 #3758 CENTER RD

FIFTH THIRD BANK
 DOCUMENT: 2010R021512
 P.P.N. 04-A-036-0-00-001-0
 #3770 CENTER RD

MAURICE R JR & SYBIL
 BELLINGER CHAMPION
 P.P.N. 04-A-036-0-00-032-0
 DOCUMENT: 2006R043576
 #3800 CENTER RD

CAROLE ANN CHAMPION
 DOCUMENT: 2002R041168
 P.P.N. 04-A-036-0-00-033-0
 #3822 CENTER RD

TIMOTHY J. SR TR & FRANCÉE
 L. MORSE
 DOCUMENT: 2006R001204
 P.P.N. 04-A-036-0-00-002-0

TIMOTHY J SR TR & FRANCÉE
 L MORSE
 P.P.N. 04-A-036-0-00-005-0
 #3830 CENTER RD
 DOCUMENT: 2006R001204

PERRY BRD OF EDUCATION
 VOL. 87, PG. 256
 P.P.N. 04-A-036-0-00-006-0

PERRY BRD OF EDUCATION
 P.P.N. 04-A-036-0-00-029-0

(AFN) = AUTOMATIC FILE NUMBER	(OBS.) = OBSERVED DISTANCE
(ACT.) = ACTUAL DISTANCE	(O.L.) = ORIGINAL LOT LINE
(CALC.) = CALCULATED DISTANCE	(RP) = RECORDED PLAT
(CL) = CENTERLINE	(O.R.) = OFFICIAL RECORD
(C.S.R.) = CITY SURVEY RECORDS	(P.P.N.) = PERMANENT PARCEL NUMBER
(Dd.) = RECORDED DEED DISTANCE	(P.C.) = POINT OF CURVATURE
(DOC.) = RECORDED DOCUMENT	(P.T.) = POINT OF TANGENCY
(ENCR.) = ENCROACHMENT	(POB) = PLACE OF BEGINNING
(FD.) = FOUND IN FIELD	(PPOB) = PRINCIPAL PLACE OF BEGINNING
(INST.) = INSTRUMENT	(REC.) = RECORD DISTANCE
(MEAS.) = MEASURED DISTANCE	(RW) = RIGHT-OF-WAY
(MON) = MONUMENT	(TRN) = TURNED ANGLE
(MON. BOX) = MONUMENT BOX ASS'LY	(S/L) = SUBLOT

BEARINGS REFER TO THE OHIO
 COORDINATE SYSTEM OF 1983 -
 NORTH ZONE 1986 ADJUSTMENT

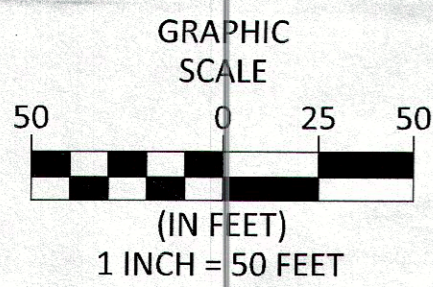
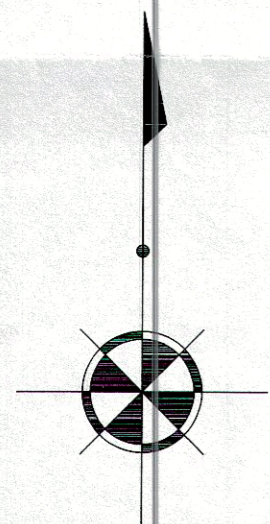

DATE: 11/14/16
 SCALE: HOR. 1"=50'
 VERT. 1"=00'
 FOLDER: Survey
 FILENAME: Survey Base
 TAB: 01 - Plat of Survey
 DRAWN: CAD

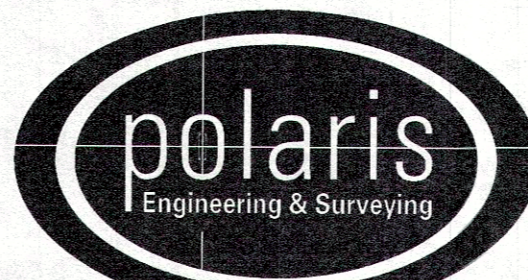

POLARIS ENGINEERING & SURVEYING, INC.
 34600 CHARDON ROAD - SUITE D
 WILLOUGHBY HILLS, OHIO 44094
 (440) 944-4433 (440) 944-3722 (Fax)
 www.polaris-es.com

CONTRACT No.	
16199	
SHEET	OF
01	01

*Vicky Stebbins
 Perry Village
 Mayor*