

BASIS OF BEARING
BEARING ARE BASED ON THE OHIO STATE PLANE COORDINATES SYSTEM,
NORTH ZONE (3401), NAD83 (2011), 2010.0 EPOCH, AS DERIVED FROM
GNSS OBSERVATIONS PER THE O.D.O.T. RTN (REAL-TIME-NETWORK).

M A T C H L I N E (S E E S H E E T 1)

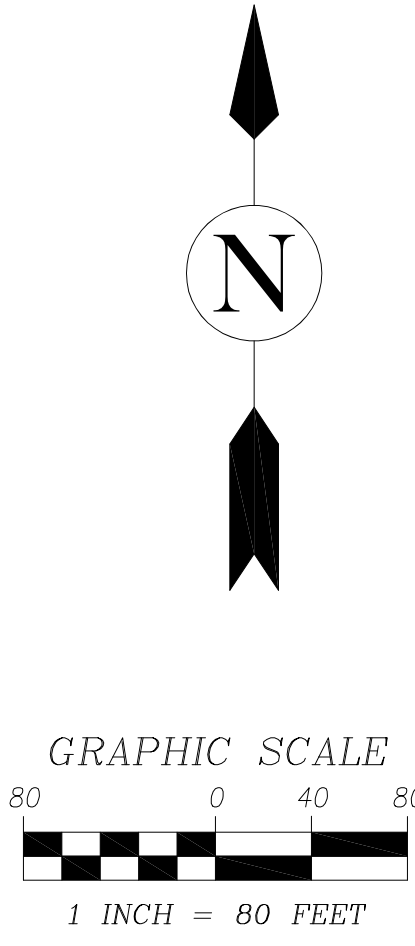

PPN 03-A-013-0-00-009-0
HJL STUBB, LLC
DOC. #2011R027367 L.C.D.R.

PPN 03-A-013-0-00-010-0
MKFK II, LLC
DOC. #2020R035106 L.C.D.R.
29.622 ACRES
(0.129 ACRES WITHIN NORTH RIDGE ROAD R/W)

PPN 03-A-019-0-00-001-0
WEST J. WEST, TRUSTEE
DOC. #2008R025893 L.C.D.R.

LOT 69
LOT 59
N 89°38'42" E 825.80' OBS. & USED
479.07' REC. & USED
324.26' REC. & USED
324.33' CALC. & USED
1" IRON PIPE W/ ID CAP (SCHADE) FD. & USED FOR LINE

N 217°29' W
1758.68' CALC. & USED (1760.19' REC.)

S 89°42'43" W
696.63' CALC. & USED (692.31' REC.)

1955.99' CALC. & USED
S 1°40'37" E

LOT 69
LOT 59
N 89°15'16" E 772.83' CALC. & USED (772.20' REC.)
153.04' REC. & USED
1" IRON PIPE FD. (0.36' SE.)

LOT 68
LOT 58
802.78' REC. & USED
380.80' CALC. & USED (380.82' REC.)

2" IRON PIPE FD. (0.46' S.)

MAP OF SURVEY
FOR
2918 NORTH RIDGE ROAD
KNOWN AS BEING PART OF LOT NO. 69, NOW SITUATED IN THE

TOWNSHIP OF PERRY
COUNTY OF LAKE - STATE OF OHIO

McSteen
LAND SURVEYORS
1415 East 286th Street Wickliffe, OH 44092
Phone: 440.585.9800 www.mcsteen.com

PPN 03-A-013-0-00-006-0
BEARDSLEE NURSERY, LLC
DOC. #2014R005615 L.C.D.R.

PPN 03-A-013-0-00-005-0

PPN 03-A-013-0-00-004-0
FAITH BAPTIST CHURCH
DEED VOL. 509, PAGE 246 L.C.D.R.

PPN 03-A-013-0-00-003-0

PPN 03-A-013-0-00-002-0
LOIS M. MORSE
DEED VOL. 121, PAGES 658 L.C.D.R.
DOC. #2009R023661 L.C.D.R.

S 0°19'14" E 928.49' CALC. & USED (928.16' REC.)

S 0°49'53" E 926.76' CALC. & USED (926.24' REC.)

S 0°00'39" W 917.13' REC. & USED

LEGEND

- REBAR FOUND AS NOTED
- ⊙ 5/8" DIAMETER X 30" LONG REBAR WITH "MCSTEEN CA 02236" ID CAP SET
- ⊠ MONUMENT BOX FOUND AS NOTED
- PIPE FOUND AS NOTED
- ⊕ CENTERLINE
- R/W RIGHT-OF-WAY
- CALC. CALCULATED DISTANCE OR ANGLE
- REC. RECORD DISTANCE OR ANGLE
- FD. FOUND
- MON. MONUMENT
- L.C.M.R. LAKE COUNTY MAP RECORDS
- L.C.D.R. LAKE COUNTY DEED RECORDS

1.5" IRON PIPE IN CONC. FD. & USED FOR ROW

5/8" REBAR FD. (0.34' N.)

5/8" REBAR FD. & USED

NARROWS ROAD (60')