

- 1" PIN FD.
- PIPE FD.
- 1" PIN SET
- MON. FD.
- RW TAKEN BY STATE

SITUATED IN PERRY TOWNSHIP, LAKE COUNTY STATE OF OHIO AND KNOWN AS BEING A PART OF LOT No. 69, TOWNSHIP 11 N. AND RANGE 8 W.

CERTIFICATION:
 I HEREBY CERTIFY THAT AN ACTUAL BOUNDARY SURVEY WAS PREPARED BY ME ON THE 14th DAY OF NOVEMBER 2011, AND THAT THE SURVEY IS IN ACCORDANCE WITH THE OHIO REVISED CODE CHAPTER 4733-37, MINIMUM STANDARDS FOR BOUNDARY SURVEYS IN THE STATE OF OHIO. PERMANENT MONUMENTS WERE FOUND, OR SET AT ALL LOCATIONS SHOWN HEREON. ALL DIMENSIONS GIVEN ARE EXPRESSED IN FEET OR DECIMAL PARTS THEREOF. BEARINGS ARE TO AN ASSUMED MERIDIAN AND ARE SHOWN TO INDICATE ANGLES ONLY. ALL PINS SET ARE 5/8" DIA., 30" LONG REBAR WITH CAP MARKED "NOVAK 7507".

I HEREBY CERTIFY THAT, THIS PLAT WAS PREPARED BY ME AND IS CORRECT TO THE BEST OF MY KNOWLEDGE, INFORMATION AND BELIEF.

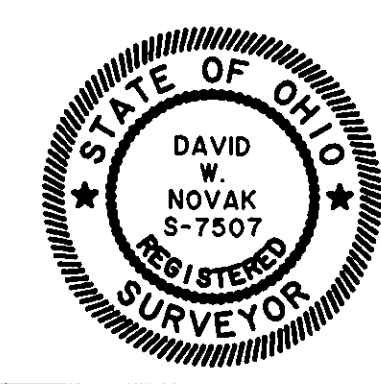

DAVID W. NOVAK, P.A. No. 7207

REVISIONS	BY

Barrington
 CONSULTING GROUP, INC.
 9114 TYLER BLVD., MENTOR, OHIO 44060
 PHONE 440.205.1260 FAX 440.205.1262
 www.BarringtonCGL.com

Deming Enterprises, Inc.
 Barry T. Deming
 PO BOX 21
 PERRY, OHIO 44081
 440-358-9440

BOUNDARY SURVEY
 PPN 03A013000090 NORTH RIDGE ROAD
 PERRY TWP., OHIO 44081
MOLNAR-UNDERWOOD PROPERTIES, LLC

DRAWN DWN
CHECKED DWN
DATE NOV. 11, 2011
SCALE 1" = 100'
JOB NO. 11083
SHEET 1/1