

I, WILLIAM C. BABCOCK P.S. #6528, DO HEREBY CERTIFY THAT THE SURVEY PERFORMED IS PURSUANT TO THE STATE OF OHIO ADMINISTRATIVE CODE STANDARDS SET FORTH AS PER ARTICLE NUMBER 4733-37.

*William C. Babcock* 10/22/14  
 WILLIAM C. BABCOCK, P.S. #6528 DATE:

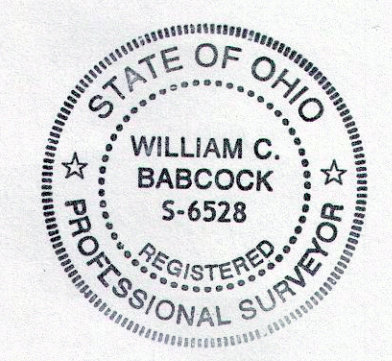

PP#01B094A000300  
 SALIDA INVESTMENT GROUP LIMITED  
 HUBBARD RD  
 DOC NO. 2011R028734

SURVEY REFERENCE:  
 PLAT OF SURVEY BY BABCOCK & JONES  
 DECEMBER 2004

BASIS OF BEARINGS  
 CENTERLINE OF HUBBARD ROAD BEING  
 N03°50'00"E

NORTH RIDGE ROAD WIDTH VARIES  
 N77°36'30"W

5/8" IPF &  
 USED IN MON  
 BOX

POB

HUBBARD ROAD 60'  
 N03°50'00"E 709.06' OBS

PP#01B094A000260  
 WILSON LAND PROPERTIES LLC  
 2737 HUBBARD ROAD  
 DOC NO 2014R002597

N86°10'00"W  
 20.00'

N03°50'00"E  
 100.00'

N86°10'00"W 150.00'

N03°50'00"E  
 50.00'  
 50.00'

PP#01B094B000570  
 FRANK M GERGER  
 HUBBARD RD  
 DOC NO. 226-PG. 869

N86°10'00"W 150.00'

PP#01B094B000320  
 FRANK M GERGER  
 GARDEN RD  
 DOC. NO. 2002R052304

PP#01B094B000310  
 FRANK M GERGER  
 GARDEN RD  
 DOC. NO. 2002R002309

HUBBARD ROAD ASSOCIATION  
 PP#01B094B000560  
 DOC. NO. 2006R010196

N03°50'00"E  
 50.00'

PP#01B094B000220  
 TONY LARICCIA, ET AL.  
 VOL. 1050 PG 1178

N86°10'00"W 200.00'

PPOB B

PPOB A

1"IPPF & USED

1"IPPF &  
 USED

S03°50'00"W  
 150.00' OBS  
 & MSD

1" IPPF IN  
 CLAY TILE  
 & USED

N86°10'00"W 150.00'

PP#01B094B000210  
 GEORGIANN MC COY  
 NORWOOD DR  
 DOC. NO. 2012R032909  
 0.712 AC

N86°10'00"W 150.00'

PP#01B094B000200  
 GEORGIANN MC COY  
 2750 NORWOOD DR  
 DOC. NO. 2012R032909  
 0.712 AC

N86°10'00"W 150.00'

PP#01B094B000190  
 DOC. NO. 2012R032909  
 0.712 AC

N86°10'00"W 150.00'

PP#01B094B000180  
 TONY 1/3 & FRED M 1/3; LARICCIA ETAL  
 NORWOOD DR  
 VOL. 1030 PG. 1148

N86°10'00"W 150.00'

PP#01B094B000170  
 TONY 1/3; & FRED M 1/3; LARICCIA ETAL  
 NORWOOD DR

1"IPPF & USED

S03°50'00"W  
 150.00'

PP#01B094A000270  
 ELEANOR GERAK  
 NORWOOD DR  
 DOC. NO. 2003R043800

1"IPPF & USED

1"IPPF BENT

1"IPPF & USED

IPS

IPS

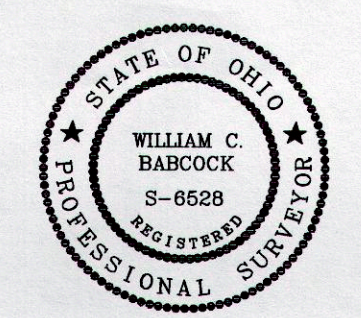

REV NO.	DESCRIPTION	DATE	BY	CHK'D

**BABCOCK LAND SURVEYORS**  
 SURVEYORS & LAND PLANNERS  
 PAINESVILLE OHIO 44077  
 babcocklandsurveyors@yahoo.com

DATE: 5/5/14  
 DESIGN BY: W.B.  
 DRAWN BY: LML  
 APPROVED BY: W.B.  
 CREW CHIEF: R.B.

PLAT OF SURVEY  
 FOR  
 GEORGIANN MC COY  
 2750 NORWOOD DRIVE  
 MADISON TOWNSHIP LAKE COUNTY STATE OF OHIO

SCALE: 1"=30'  
 JOB No. 14-27  
 SHEET 1 OF 1