

# LOT SPLIT SURVEY FOR ROSE M. & TONY J. DEBEVC

TOWNSHIP OF MADISON, COUNTY OF LAKE, STATE OF OHIO KNOWN AS BEING PART OF LOT 3 IN  
TRACT 13 IN MADISON TOWNSHIP, BEING IN TOWNSHIP 11, RANGE 6, OF THE CONNECTICUT WESTERN RESERVE  
FEBRUARY 2008



BEARINGS ARE NEITHER TRUE  
NOR MAGNETIC, AND ARE USED  
TO DENOTE ANGLES ONLY

BASIS FOR BEARING IS THE ASSUMED  
CENTERLINE OF DOTY ROAD (60' R/W).  
NORTH 88°39'52" WEST

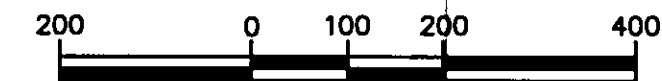

1 INCH = 200 FT.

**REFERENCE DOCUMENTS:**

SURVEYS OF RECORD ON FILE AT THE  
LAKE COUNTY ENGINEER'S OFFICE.  
  
DEEDS OF RECORD ON FILE AT THE  
LAKE COUNTY RECORDER'S OFFICE.

D.R. = LAKE COUNTY DEED RECORD  
O.R. = LAKE COUNTY OFFICIAL RECORD  
IPS = 5/8" DIAMETER X 30" LONG REBAR SET WITH  
● A PLASTIC CAP STAMPED "PEZAR PS 7772".

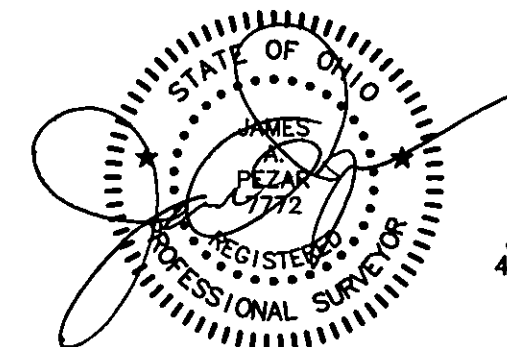

Prepared By:  
**JAMES A. PEZAR, P.S.**  
4670 WHITE ANGEL DR.  
PERRY OHIO 44081  
(440) 259-5725

**SURVEYORS STATEMENT**

THIS PLAT WAS PREPARED BY ME AND IS TRUE AND CORRECT  
TO THE BEST OF MY KNOWLEDGE AND BELIEF. THE SURVEY  
MEETS THE MINIMUM STANDARDS FOR BOUNDARY SURVEYS  
IN THE STATE OF OHIO AS SPECIFIED IN THE OHIO  
ADMINISTRATIVE CODE CHAPTER 4733-37.

*James A. Pezar*  
JAMES A. PEZAR, P.S. OHIO #7772

2-6-08  
DATE

DONIELLA & LARRY WINCHELL  
O.R. VOL. 124, PG. 1009  
PP# 01-A-058-0-00-001-0

