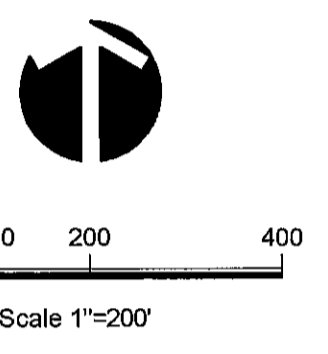

TABLE OF ABBREVIATIONS

| | | | |
|------|--------------------------|------|-----------------|
| RD | ROAD | C/L | CENTERLINE |
| BLVD | BOULEVARD | R/W | RIGHT OF WAY |
| AVE | AVENUE | P/L | PROPERTY LINE |
| WV | WATER VALVE | ELEC | ELECTRIC |
| GV | GAS VALVE | REC | RECORD |
| CONC | CONCRETE | N | NORTH |
| S/L | SUBLOT | S | SOUTH |
| CB | CATCH BASIN | E | EAST |
| DS | DOWNSPOUT | W | WEST |
| ATM | AUTOMATIC TELLER MACHINE | DEG | DEGREES |
| | | ' | MINUTES OR FEET |
| | | \"/> | |

LEGEND

| | | | |
|---|----------------------|-----|--|
| ● | IRON PIN FOUND | □ | R R SPIKE SET |
| ■ | R R SPIKE FOUND | ⊗ | DRILL HOLE SET |
| ✕ | P K NAIL FOUND | △ | BREAK POINT |
| ⊠ | STONE FOUND | --- | FENCE LINE |
| ● | FENCE POST FD & USED | ○ | 5/8 DIA X 30' LENGTH REBAR CAPPED SET BOCK & CLARK |
| ⊠ | SIGN | ⊠ | GAS VALVE |
| ⊠ | CATCH BASIN | ⊠ | WATER VALVE |
| ⊠ | POWER POLE | ⊠ | FIRE HYDRANT |
| ⊠ | LIGHT POLE | ⊠ | CONCRETE PARKING STOP |
| ⊠ | DOWNSPOUT | ⊠ | PARKING METER |
| | | ⊠ | WATER METER |



SURVEY OF LANDS

HELEN CONE & CLAUDIA U. HEMPHILL

VOLUME 759
PAGES 1111-1115
& VOLUME 669
PAGE 1086
LCDR

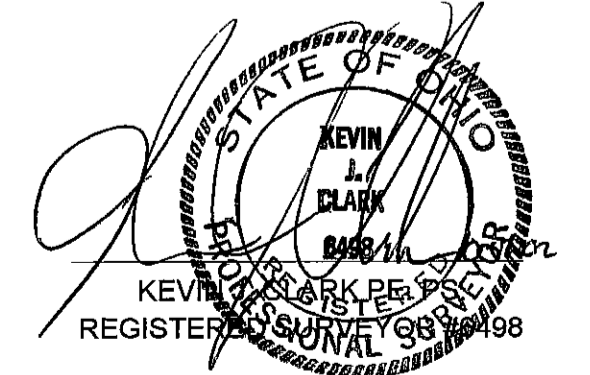

Date of Survey JANUARY 17, 1995
Date of Last Revision 10-01-2002

PROJECT NO 1073

SHEET 1 OF 1

BOCK & CLARK'S NATIONAL SURVEYORS NETWORK
ENGINEERS & SURVEYORS (800-787-8396) (FAX 216-350-9074)
8 NORTH STATE STREET, SUITE 102, PAINESVILLE, OHIO 44077

DIMENSIONS ON THIS PLAT ARE EXPRESSED IN FEET AND DECIMAL PARTS THEREOF UNLESS OTHERWISE NOTED BEARINGS ARE REFERRED TO AN ASSUMED MERIDIAN AND ARE USED TO DENOTE ANGLES ONLY MONUMENTS WERE FOUND OR SET AT POINTS INDICATED HEREON

BASIS OF BEARINGS USED IS THE NORTHERLY LOT LINE BETWEEN TRACT 6 LOTS 5 & 6 AND TRACT 7 LOTS 4 & 5 BEING S 87° E PER DEED VOLUME 759 PAGE 1111-1115 AS RECORDED IN LCDR

NOTE ALL IRON PINS SET ARE 5/8" DIAMETER BY 30" LENGTH STEEL REBAR WITH PLASTIC CAP BEARING THE NAME BOCK & CLARK ON THE CAP

COPYRIGHT 1994 by Bock & Clark
This product style and format is protected by Copyright The use of this style and format is strictly prohibited without the written consent and permission of Bock & Clark