

Coordinates of Harbor Line Points			Coordinates of Reference Points		
Point	North	East	Point	North	East
A	6,666.00	6,101.59	200	8,166.02	6,093.39
B	3,463.80	6,183.34	201	8,665.46	6,110.12
C	4,176.05	3,679.56	202	8,434.81	6,078.43
D	3,909.33	3,885.19	203	3,343.33	5,779.23
E	2,892.81	5,905.93	204	3,850.67	6,629.20
			205	2,907.24	5,029.61
			29	3,892.72	6,185.24
			31	3,121.47	6,026.53
			33	4,445.31	5,868.53
			35	3,153.23	5,641.36
			37	2,706.53	6,001.03
			39	2,273.35	6,200.65
			43	3,263.32	5,748.78
			47	4,734.49	6,626.34
			14	10,000.00	5,000.00
			16	6,326.64	5,063.94
			17	9,420.36	6,077.77

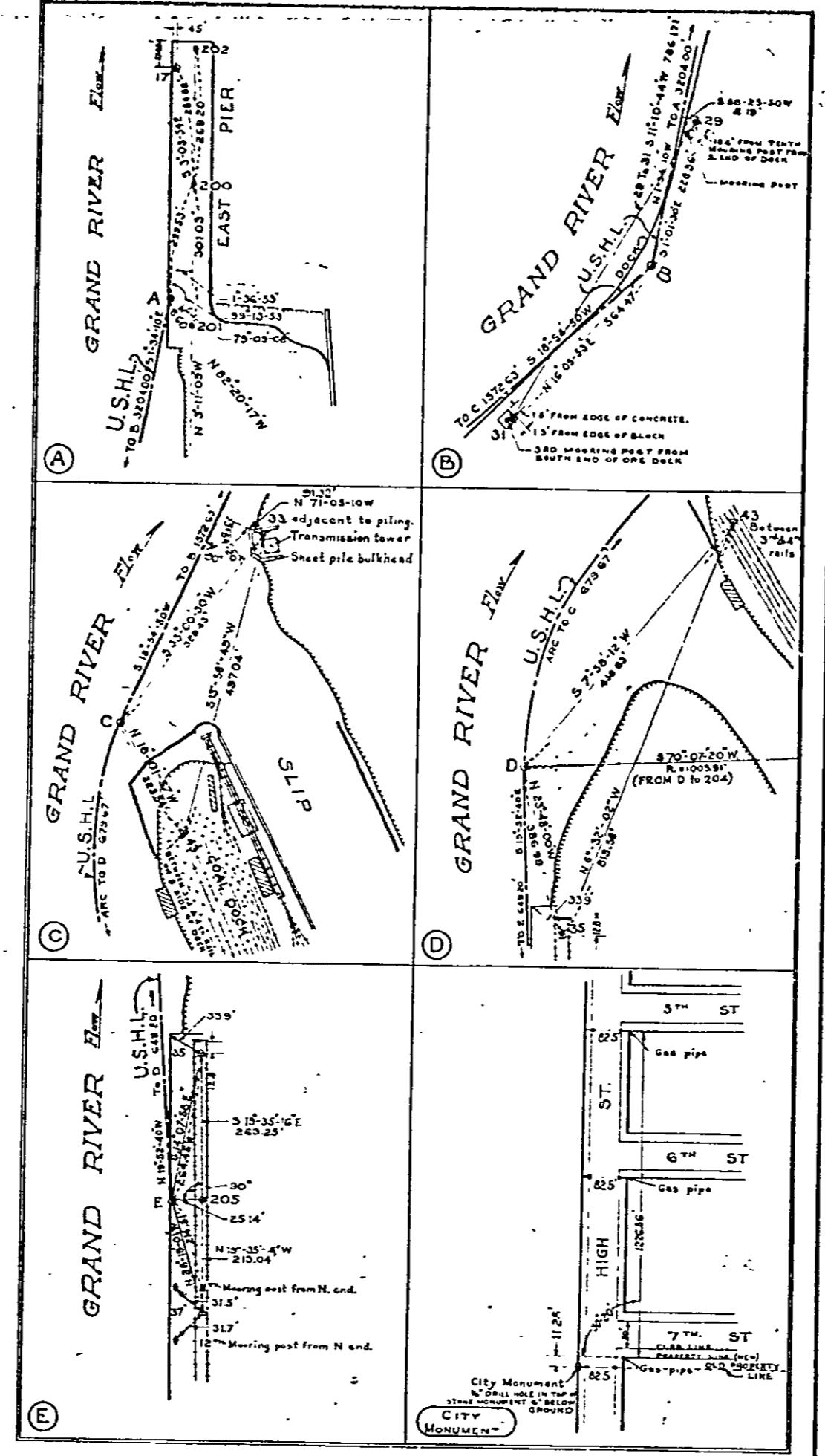
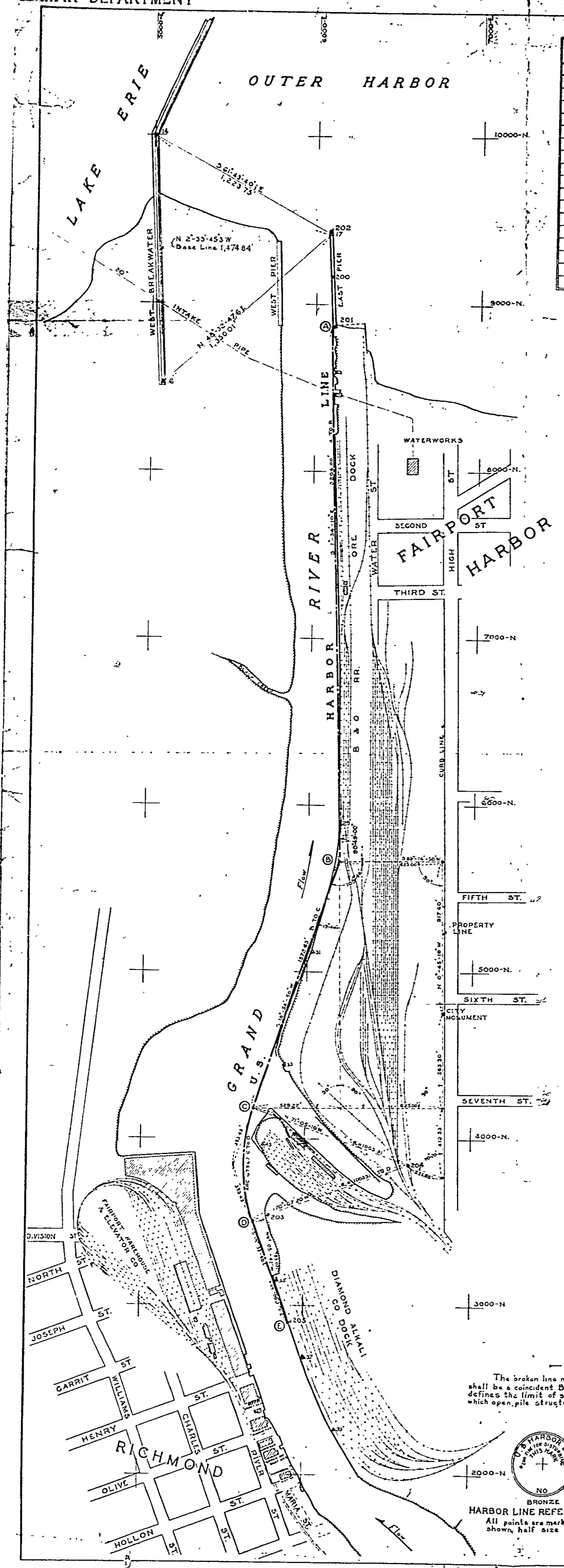
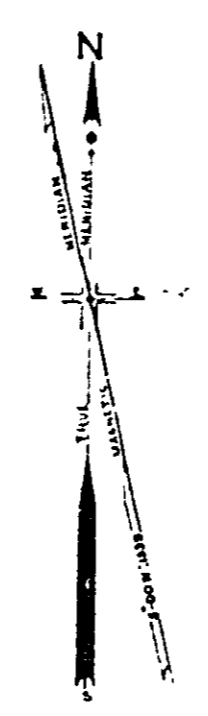

NOTE: All bearings are referred to true meridian.  
True bearing of line A16 to A16 established by observation on Polaris from A16.

WAR DEPARTMENT  
OFFICE, CHIEF OF ENGINEERS  
WASHINGTON, D. C., OCT. 10, 1940

It is recommended that the harbor lines as shown on this map be established by the Secretary of War by his approval hereon subject to the provisions of section 11 of the River and Harbor Act approved March 3, 1839, this map to supersede all harbor line maps for these shores previously approved by the Secretary of War.

*R. H. Taylor*  
Major General, Chief of Engineers

WAR DEPARTMENT  
WASHINGTON, D. C., Oct. 11, 1940

Approved  
*Henry H. Henshaw*  
Secretary of War

NOTE—  
The broken line marked "U.S. Harbor Line" shall be a coincident Bulkhead and Pierhead line which defines the limit of pier filling and the limit to which open pile structures may be built.

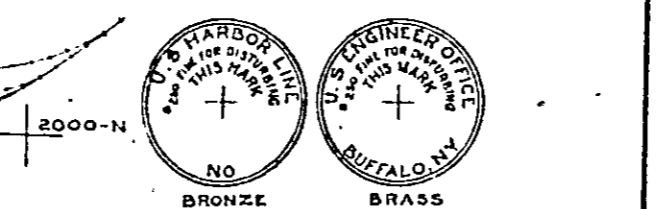

HARBOR LINE REFERENCE POINT MONUMENTS  
All points are marked by disks of the designs shown, half size above, set in concrete.

FAIRPORT HARBOR, OHIO  
U. S. HARBOR LINE MAP  
—1939—

IN ONE SHEET SCALE OF FEET SCALE 1"=300'

U.S. ENGINEER OFFICE, BUFFALO, N.Y. JUNE 27, 1939

Submitted by: *James J. ...* Approved by: *Philip ...*  
SENIOR ENGINEER SENIOR ENGINEER

Drawn by: D.J.G. Checked by: C.T. File No. 60-A-75