

ROOF DRAINS SHALL DISCHARGE TO SPLASH BLOCKS.

APPROVED

- AS NOTED
- AS SUBMITTED
- NOT APPROVED

JW 4-22-04
SIGNATURE

Stormwater Management Plan
Approved as shown and/or noted
JAMES R. GILLES, P.E.
County Drainage Engineer
By *L.S.* Date 5/3/04

BENCHMARK
INVERT OF EXISTING SANITARY MANHOLE
STA. 4+20, 19' RT. DUGAN'S LANDING
ELEV. 685.40
RIM ELEV. 697.46

SITE PLAN GENERAL NOTES:
SEE IMPROVEMENT PLANS FOR THE LANDING AT DUGAN'S FARM CONDO, PHASE 1, FOR EROSION CONTROL AND GRADING ITEMS.

THE CONDOMINIUM BOUNDARY MUST BE STAKED TO CONFIRM BUILDING LOCATIONS.

DRIVEWAYS SHALL BE 6" THICK AND HAVE 3' FLARES ON EACH SIDE.

F.G. = ELEVATION OF GARAGE FLOOR AT FRONT OF GARAGE.

000.00 = SPOT ELEVATIONS

Back-Up Power Source for Sump Recommended

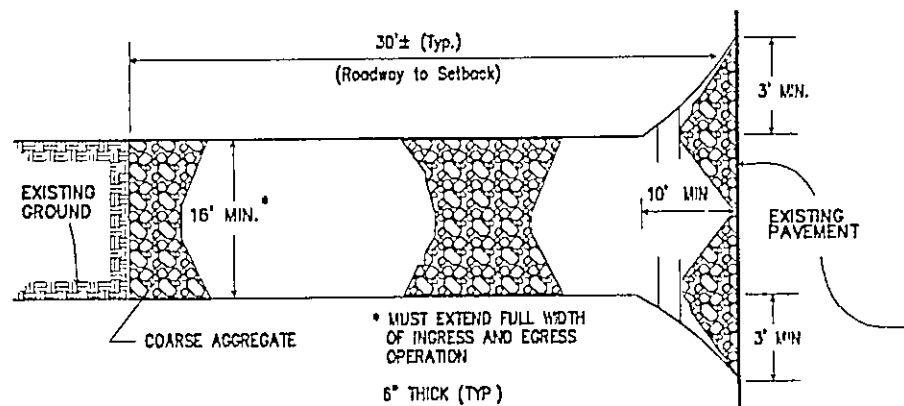

STONE CONSTRUCTION ENTRANCE

NO SCALE

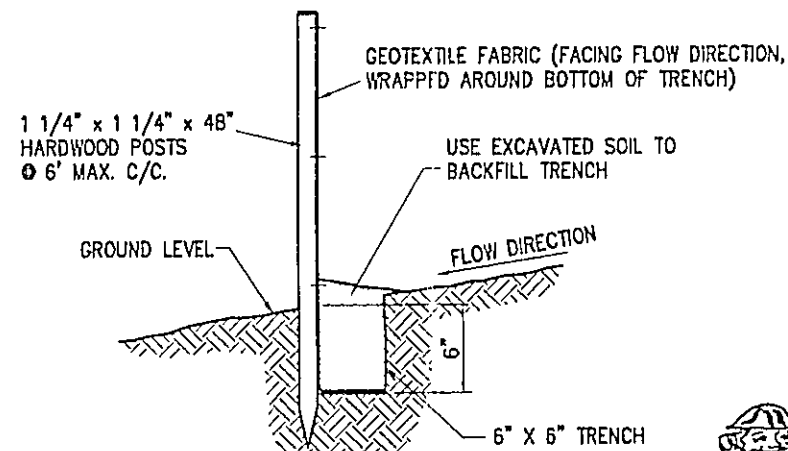

SILT FENCE
TYPICAL CROSS SECTION

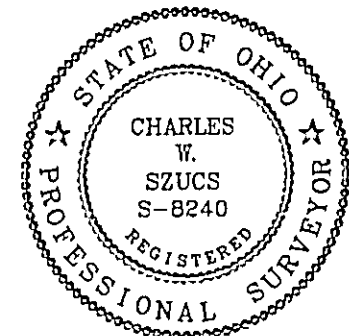
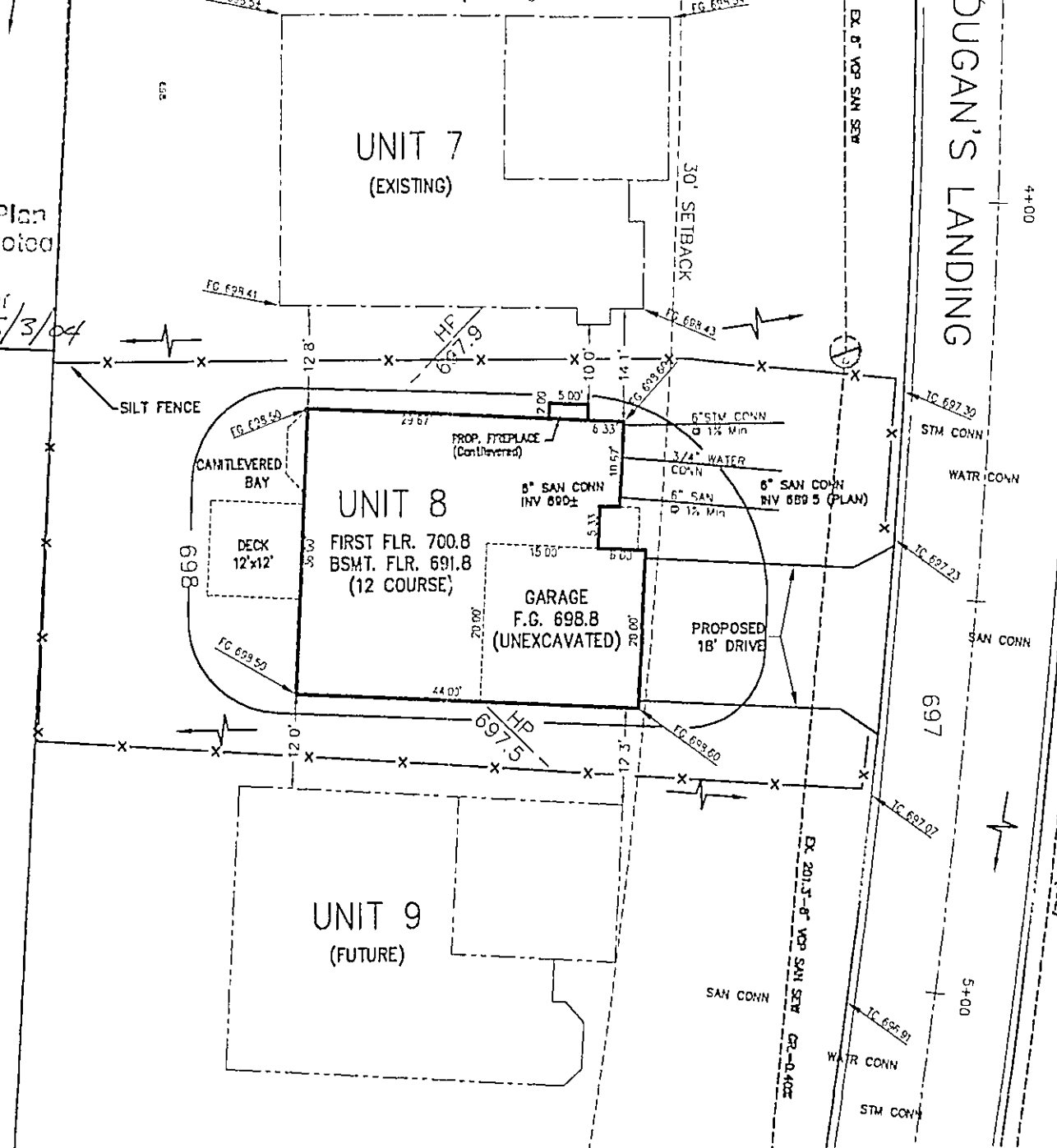

I, THE UNDERSIGNED, HEREBY CERTIFY THAT THIS TOPOGRAPHY, INDICATED BY 6", 1', OR 2' CONTOURS, AND ELEVATIONS SHOWN HEREON, REPRESENT AN ACTUAL FIELD SURVEY MADE BY ME ON THE 26th DAY OF SEPTEMBER, 2003, AND THAT THE ELEVATIONS WERE TAKEN AT APPROPRIATE INTERVALS AND THAT AS OF THAT DATE, THEY EXISTED AS INDICATED HEREON.

CHARLES W. SZUCS, P.S. # 8240

2 WORKING DAYS BEFORE YOU DIG
CALL TOLL FREE 800-362-2764
OHIO UTILITIES PROTECTION SERVICE
NON-MEMBERS MUST BE CALLED DIRECT

EXISTING UNDERGROUND UTILITIES NOTE:
THE SIZE AND LOCATION, BOTH HORIZONTAL AND VERTICAL OF THE UNDERGROUND UTILITIES SHOWN HEREON, HAVE BEEN OBTAINED BY A SEARCH OF AVAILABLE RECORDS. VERIFICATION BY FIELD OBSERVATION HAS BEEN CONDUCTED WHERE PRACTICAL HOWEVER, POLARIS ENGINEERING & SURVEYING, INC. DOES NOT GUARANTEE THE COMPLETENESS NOR ACCURACY THEREOF.

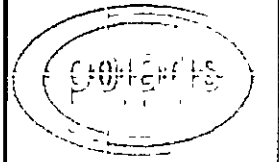

POLARIS ENGINEERING & SURVEYING, INC.
34600 CHARDON ROAD
SUITE D
WILLOUGHBY HILLS, OH 44094
(440) 944-4433
(440) 944-3722 (Fax)
www.polaris-es.com

DATE: 04/20/04
SCALE: HOR 1"=20'
VERT. none
FILENAME: Siteplan-Boss
COMPUTER: ES
CREW CHIEF: xxx

SITE PLAN FOR:
SUBLOT No. 8
(3892 Dugan's Landing)
**The Landing At Dugan's Farm
Condo, Phase 1**
PERRY VILLAGE - LAKE COUNTY - OHIO

OWNER:
DUGAN'S LANDING, LLC
P.O. BOX 949
CHARDON, OHIO 44024
PHONE: (440) 354-6401
FAX: (440) 354-5780
CONTACT:
Bill Johnson

CONTRACT No.	
03519	
SHEET	OF
1	1