

# PROPOSED SITE PLAN FOR DOERR CONSTRUCTION

S/L 13 HEMLOCK RIDGE SUB.  
VOL. 29, PG. 23  
INSTRUMENT #200001738

BEING PART OF LOT 48 & 64  
LEROY TOWNSHIP  
COUNTY OF LAKE, STATE OF OHIO  
APRIL 2, 2004

THIS SITE PLAN WAS DRAWN ON APRIL 2, 2004  
IN ACCORDANCE WITH CHAPTER 4733-37 OF THE ADMINISTRATIVE CODE,  
FOR MINIMUM STANDARDS FOR BOUNDARY SURVEYS

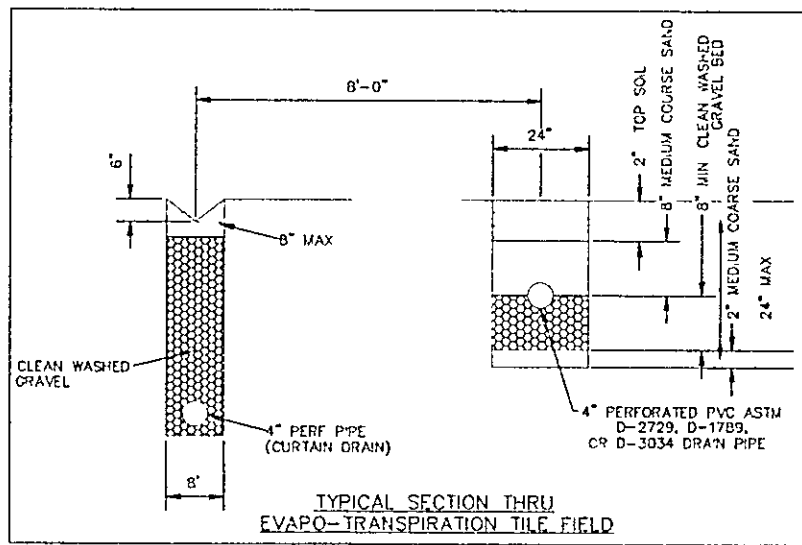

NOTE ALL DISTURBED AREAS TO BE  
TEMPORARY SEEDED.

REVIEWED AND ACCEPTED  
LAKE COUNTY GENERAL  
HEALTH DISTRICT

Date 4-5-04 BY  
David B. Morris

SEWAGE DISPOSAL PERMIT MUST BE  
OBTAINED BY A LAKE COUNTY LICENSED  
INSTALLER BEFORE INSTALLATION IS  
STARTED

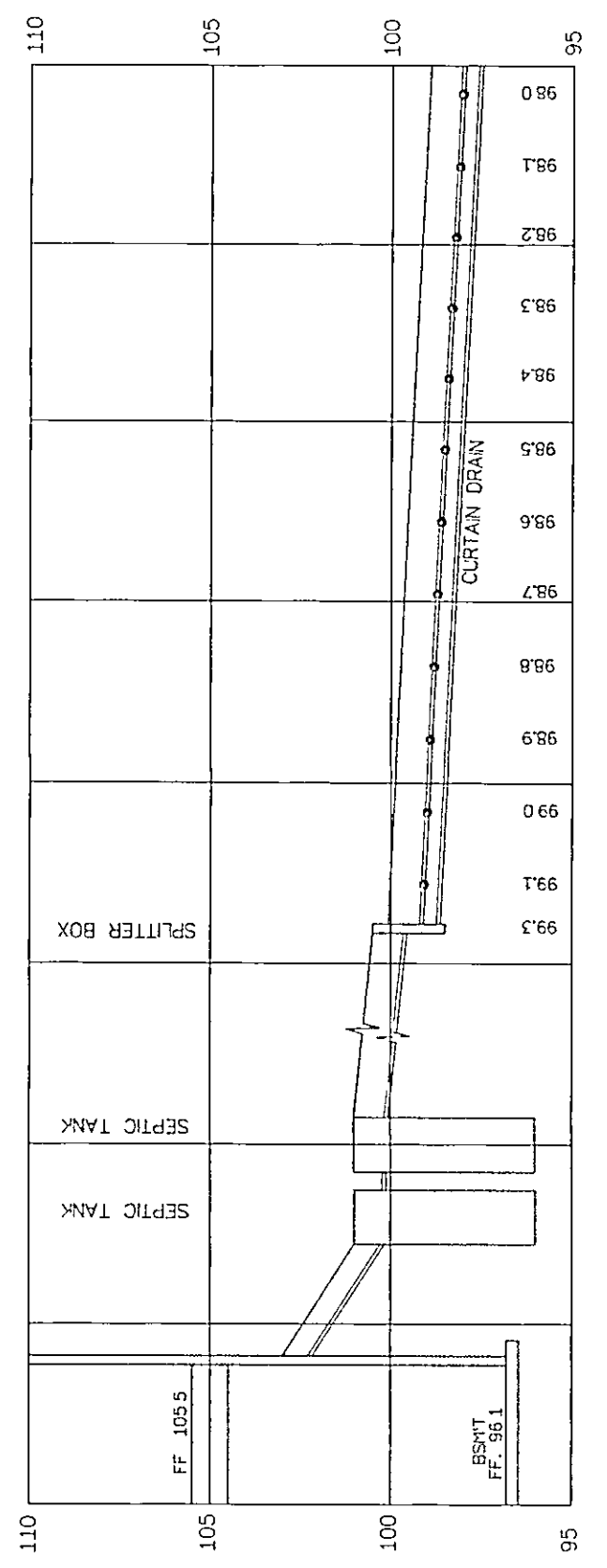
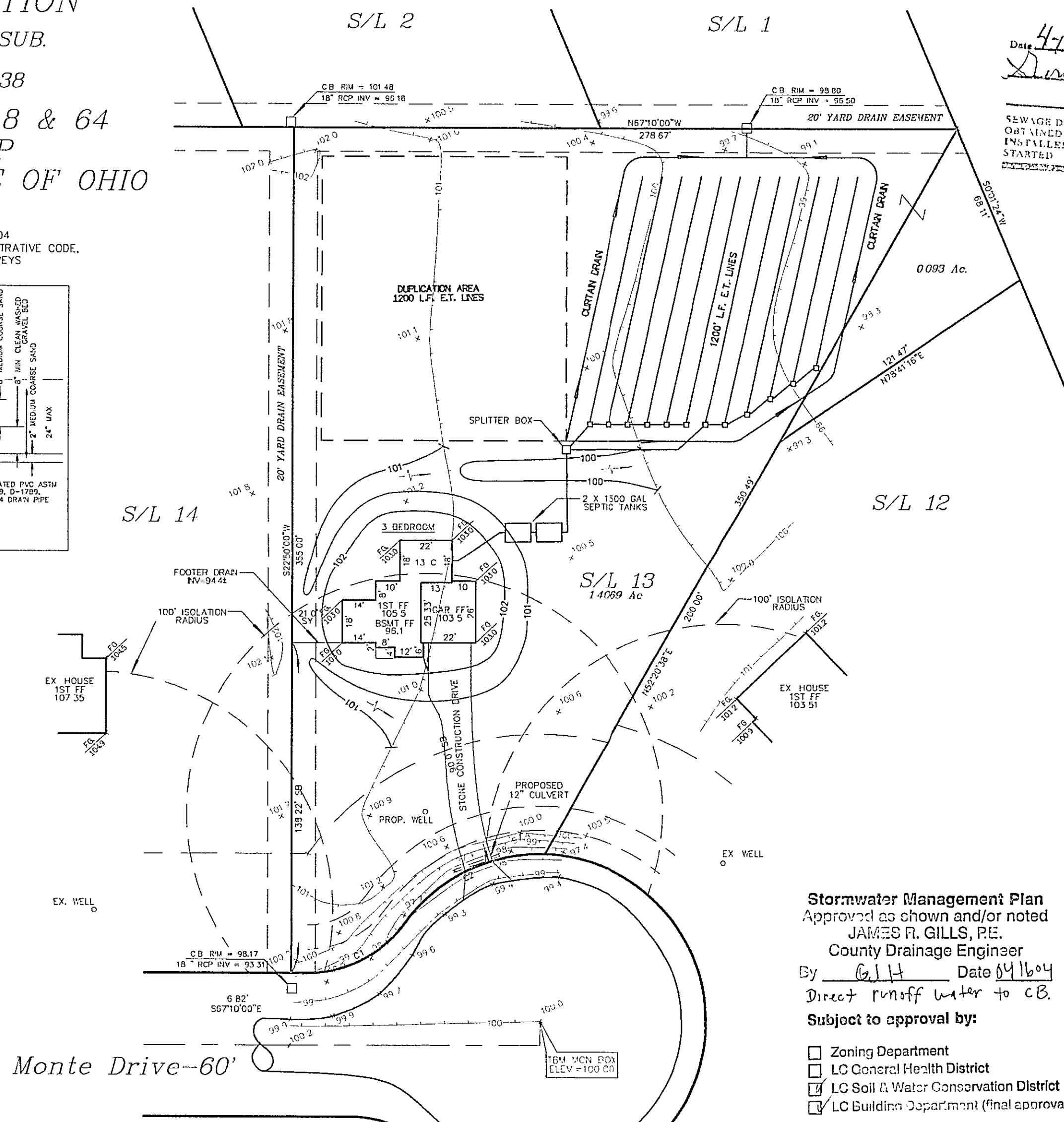
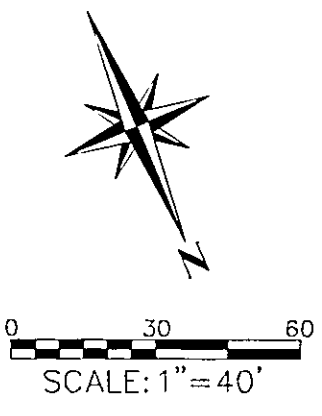

**Stormwater Management Plan**  
Approved as shown and/or noted  
**JAMES R. GILLS, P.E.**  
County Drainage Engineer  
By G.J.H. Date 04/16/04  
Direct runoff water to C.B.  
**Subject to approval by:**

- Zoning Department
- LC General Health District
- LC Soil & Water Conservation District
- LC Building Department (final approval)

"I, the undersigned hereby certify that  
this topography indicated by 6", 1', or 2'  
contours, and elevations shown hereon  
represent an actual field survey made by  
me on the 29th day of Mar., 2004  
and that the elevations were taken at  
appropriate intervals and that as of that  
date they existed as indicated hereon."

Name Keith B. Jones #7794  
Reg. No.

**KEITH B. JONES**  
REGISTERED LAND SURVEYOR #7794  
AAA Land Surveying, Inc.  
100 Center Street, Suite 150  
Chardon, OH 44024  
(440) 286-2393

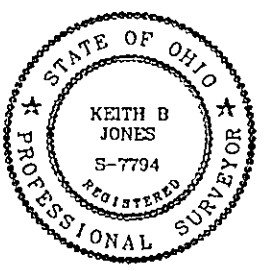

CURVE DATA

NUM	DELTA	ARC	RADIUS	BEARING	DISTANCE
C1	54°18'52"	47.40	50.00'	S85°40'34"W	45.64'
C2	55°44'04"	68.09'	70.00'	N86°23'09"E	65.44'

1688-028-918 1/22/04 11/21/04 11/22/04