

Rye	3	4 bushel
Tall Fescue	1	40 lb.
Annual Ryegrass	1	40 lb.
Wheat	3	2 bushel
Tall Fescue	1	40 lb.
Annual Ryegrass	1	40 lb.
Perennial Ryegrass	1	40 lb.
Tall Fescue	1	40 lb.
Annual Ryegrass	1	40 lb.

eding Use mulch only, sodding practices or dormant seeding.

eed species may be substituted

#### Silt Fence Detail

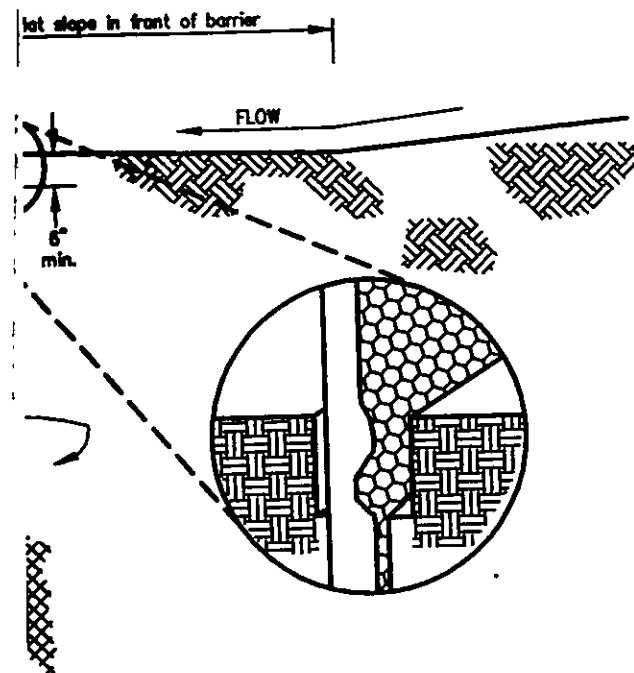

#### Temporary Seeding Specifications

Y THAT THIS PLAN  
PREPARED BY ME AND  
FACT TO THE BEST OF  
KNOWLEDGE AND BELIEF

*Cheniering*  
SURVEYOR #6356

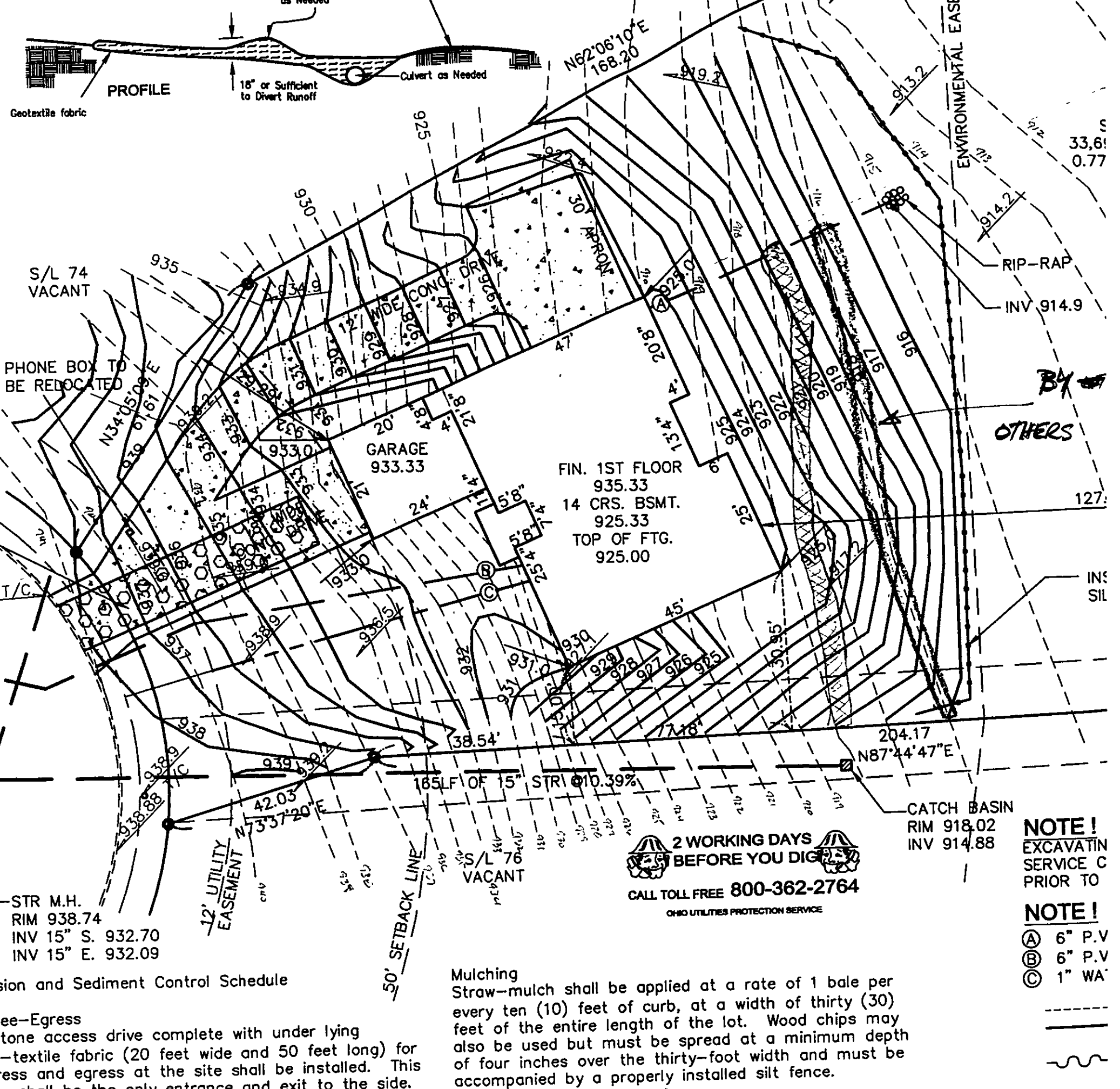

#### Erosion and Sediment Control Schedule

Ingress-Egress  
A stone access drive complete with under lying geo-textile fabric (20 feet wide and 50 feet long) for ingress and egress at the site shall be installed. This drive shall be the only entrance and exit to the side.

Mulching  
Straw-mulch shall be applied at a rate of 1 bale per every ten (10) feet of curb, at a width of thirty (30) feet of the entire length of the lot. Wood chips may also be used but must be spread at a minimum depth of four inches over the thirty-foot width and must be accompanied by a properly installed silt fence.

**NOTE!**  
EXCAVATION  
SERVICE C  
PRIOR TO

**NOTE!**  
(A) 6" P.V.  
(B) 6" P.V.  
(C) 1" WA