

CERTIFICATION :
 I THE UNDERSIGNED HEREBY CERTIFIES THAT THIS TOPOGRAPHY
 INDICATED BY 1 FOOT CONTOURS AND ELEVATION SHOWN
 HEREON REPRESENTS AN ACTUAL SURVEY MADE BY ME ON THE
 17th DAY OF NOVEMBER, 2011 AND THE ELEVATIONS WERE TAKEN
 AT AN APPROPRIATE INTERVAL AND AS OF THAT DAY THEY
 EXISTED AS INDICATED HEREON.

"I HEREBY CERTIFY THAT THIS PLAN WAS PREPARED BY ME AND IS
CORRECT TO THE BEST OF MY KNOWLEDGE AND BELIEF"

David W. Novak 1/4/2012

DAVID W. NOVAK, P.S. No. 7507

CERT-12802



TEMPORARY SEEDING SPECIFICATIONS			
SEEDING DATES	SPECIES	LB./1000 FT.	PER AC.
MARCH 1 TO AUGUST 16	OATS	3	4 BUSHEL
	TALL FESCUE	1	40 LB.
	ANNUAL RYEGRASS	1	40 LB.
	PERENNIAL RYEGRASS	1	40 LB.
	TALL FESCUE	1	40 LB.
	ANNUAL RYEGRASS	1	40 LB.
AUGUST 16 TO NOVEMBER 1	RYE	3	2 BUSHEL
	TALL FESCUE	1	40 LB.
	ANNUAL RYEGRASS	1	40 LB.
	WHEAT	3	2 BUSHEL
	TALL FESCUE	1	40 LB.
	ANNUAL RYEGRASS	1	40 LB.
	PERENNIAL RYEGRASS	1	40 LB.
	TALL FESCUE	1	40 LB.
ANNUAL RYEGRASS	1	40 LB.	
NOVEMBER 1 TO SPRING SEEDING	USE MULCH ONLY, SODDING PRACTICES OR DORMANT SEEDING.		

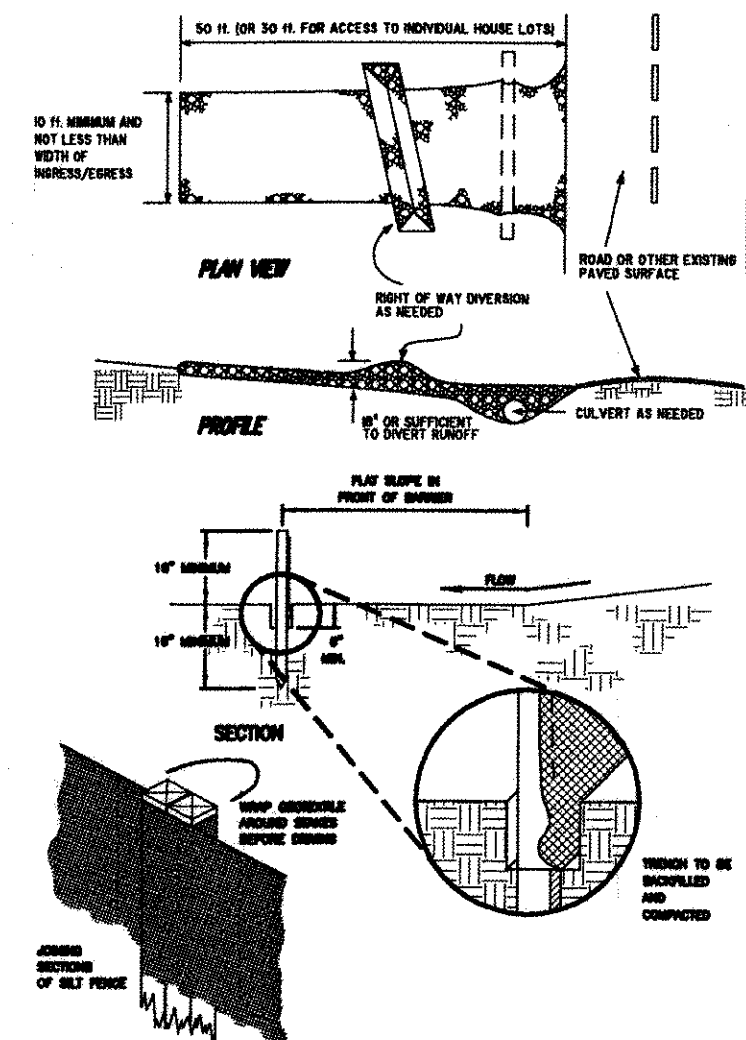

GENERAL NOTES:

1. BENCHMARK - TOP STEP OF EXISTING FIRE HYDRANT LOCATED AS SHOWN IN SITE PLAN, ELEVATION = 992.30.
2. DRIVEWAY APPROX TO BE 6" THICK CONCRETE.
3. ALL DOWNSPOUTS TO BE OUTLETTED TO SPLASH BLOCKS.
4. CONTRACTOR RESPONSIBLE FOR CONTACTING THE OHIO UTILITY PROTECTION SERVICE (1.800.392.2784) AND ALL UTILITY COMPANIES A MINIMUM OF 48 HOURS PRIOR TO CONSTRUCTION.
5. THE LOCATION BOTH HORIZONTAL AND VERTICAL OF EXISTING UNDERGROUND UTILITIES SHOWN HEREON, HAVE BEEN OBTAINED BY A DILIGENT AND COMPREHENSIVE SEARCH OF AVAILABLE RECORDS. VERIFICATION BY FIELD OBSERVATION HAS BEEN CONDUCTED WHERE PRACTICAL, HOWEVER, BARRINGTON CONSULTING GROUP, INC. DOES NOT GUARANTEE THE COMPLETENESS, NOR ACCURACY THEREOF.
6. CONTRACTOR SHALL VERIFY ELEVATIONS OF LATERAL INVERTS IN THE FIELD PRIOR TO FOUNDATION EXCAVATION.

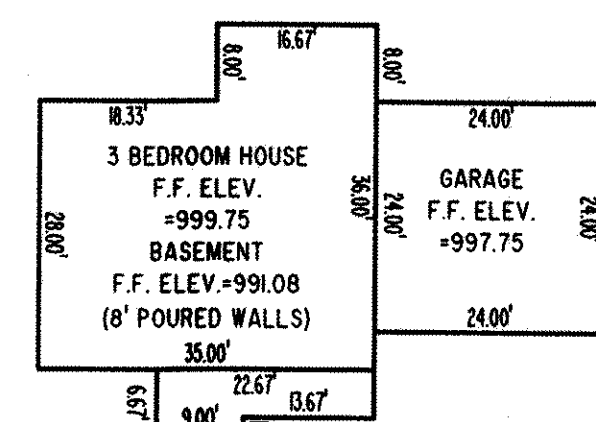
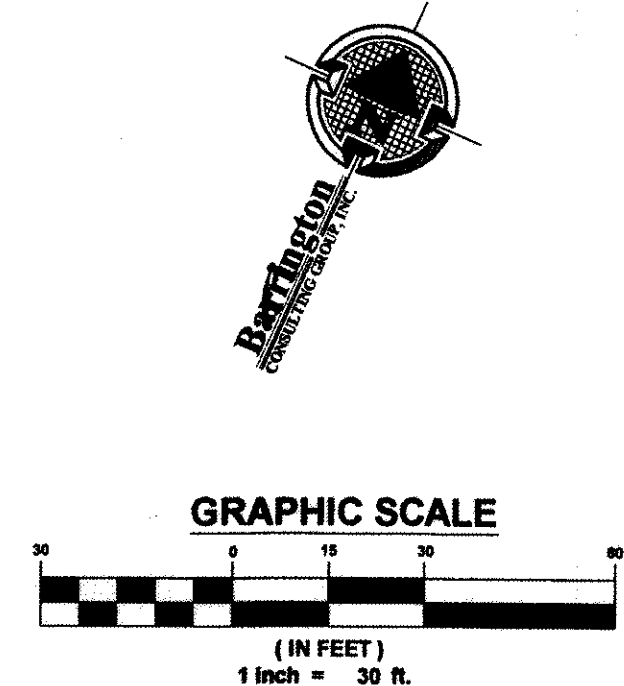

Stormwater Management Plan
Approved as shown and/or noted
JAMES R. GILLS, P.E.
County Drainage Engineer
By J.S. Date 1/26/2012

[illegible]

Barrington
CONSULTING GROUP, INC.
9114 TYLER BLVD., MENTOR, OHIO 44060
PHONE 440.205.1260 FAX 440.205.1262
www.BarringtonCGI.com

W.R. DAWSON CONSTRUCTION, LLC.
BILL DAWSON Jr.
759 LAKESHORE BLVD. UNIT F
PAINESVILLE, OHIO 44077
PH: 440.223.4446/FAX 440.639.9775

SITE PLAN

DRAWN WSO
CHECKED DWN
DATE NOV. 23, 2011
SCALE 1" = 30'
JOB NO. 11103
SHEET

OF SHEETS