

# Record of Surveys,

# Lake County, Ohio

Plat of Survey No. 170, Madison Town 12, Range 6

Survey made July 29<sup>th</sup> 1881, at the request of Township Trustees  
For the purpose of locating boundaries of the road.

by H. N. Munson County Surveyor.

### DESCRIPTION.

Beginning at a piece of stone pump in the center of the Main road, from which the stone parapet on the south end of the culvert bears N. 79° E. 48 3/4 ft., and the parapet at the North end of culvert bears N. 46 3/4° E., 49 ft. distant, said piece of stone pump being also N. 63° E. 142.5 ft. from a point in said Main road, from which the Northeast corner of J. Hodges' farm bears S. 63 3/4° E. 70 links distant, thence from said piece of stone pump N. 21 1/2° E. 3 chains + 25 links to a stone in the angle of the road, thence N. 23 3/4° E. 11 chains + 26 links to an iron bolt from which the stone abutment to the culvert on the Lake Shore Ry. bears N. 11 1/2° E. 148.6 ft. distant. Also road from said piece of stone pump Southward bears S. 13 3/4° E. 7 chains + 88 links to a stone.

### CALCULATIONS.

Sta.	Course.	Distance.	Latitude.		Departure.		Double Longitude.	Double Areas.		REMARKS.
			North.	South.	East.	West.		North.	South.	

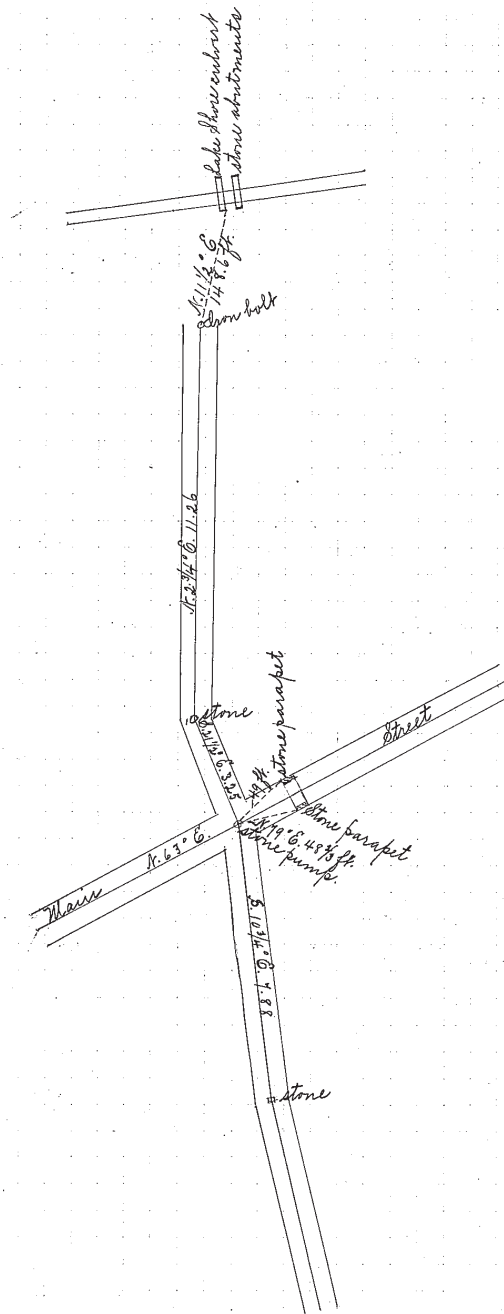

I, H. N. Munson, County Surveyor of Lake County, Ohio, do hereby certify, that I have surveyed and subdivided Lot No. 3, 4, 7, 8 in Tract No. 4 Township of Madison in accordance with the statutes of Ohio, and the laws of the United States.

Surveyed pursuant to the application of Township Trustees and July 29<sup>th</sup> A. D. 1881

\_\_\_\_\_ } Flagmen.  
 \_\_\_\_\_ }  
 \_\_\_\_\_ } Markers.  
 \_\_\_\_\_ }  
 \_\_\_\_\_ }  
 \_\_\_\_\_ } Tapemen.