

No. 61

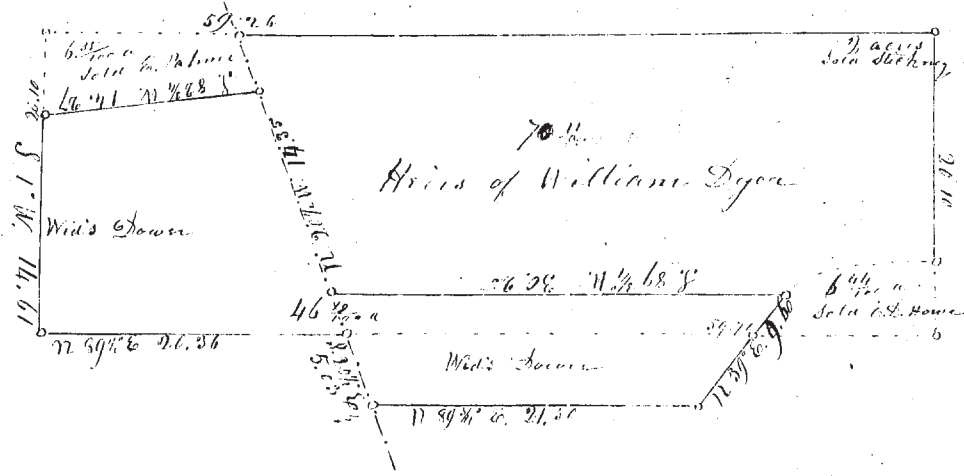

Survey of the Widow's Dower in the Real estate of William Dyer late of Concord deceased, Beginning in the center of the State Road from Plainville to Wren at the corner of land sold by said deceased to Erastus Palmer - thence S 82 1/4 W 11.27 links to a post in the west line of Tract No 2 in said Concord - thence by the line of said Tract S 1 1/2 W 11.61 lks to a post at the corner of Land of Lois Manly - thence N 89 1/2 E 20.36 lks to the center of said State Road - thence S 20 1/2 E by said Road 5.03 lks. - thence N 89 1/2 E 21.50 lks to a post on the top of the high bank - thence N 39 E 60 to a post - thence S 89 1/2 W 30.05 lks to the center of the State Road - thence by said N 20 1/2 W 11.35 lks to the place of beginning - containing Forty six acres and nineteen hundredths of an acre of land - the whole being part of Lot No 5 in Tract No 2 in said Concord -

Richmond Colapitt }  
Joseph Tuttle } Chairman (Sworn)

Jan 14, 1850 M. S. Harvey Co. Surveyor

No. 62

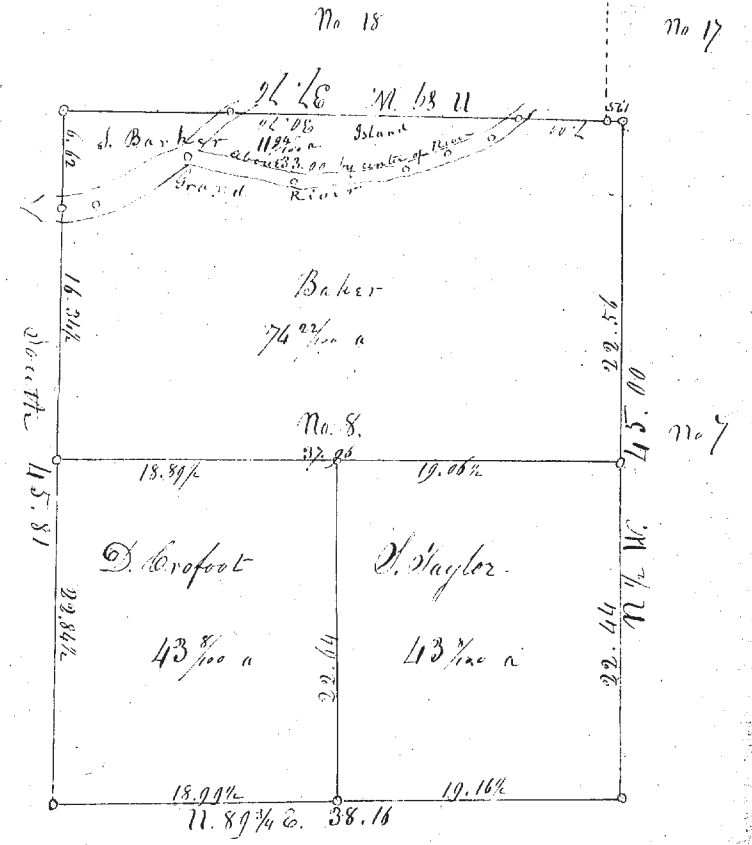

Survey and Subdivision of Lot No 8 in the North part of Le Roy being No. 11 in the 7th Range of Townships (Formerly Perry) - Beginning at the Southeast corner of said Lot thence around said Lot according to the courses & distances as laid down in the above plat. Subdivided according to the distances laid down within the Lot lines. The whole lot containing 172 3/10 acres

Cyrus Houston }  
Samuel Ray } (Chairman) (Sworn)

Dec. 1849

M. S. Harvey Surveyor Le Roy