

Survey of fifteen acres of land from the North westerly part, of the Middle part, of Lot No. 26 in tract No. in Township No. 10 in the 7 Range of Townships of the Connecticut Western Reserve - Being land sold for taxes By E. Corning, Treasurer of Lake County, Ohio on the 26 day of December AD 1842 To Enos Jew for the sum of eleven dollars, sixty one cents, ten mills, the amount of taxes, interest and penalty due for the year 1841 & 1842 on 165 acres of land, valued at 393 dollars and entered for taxation in the name of George & Richard Lord in the said Middle part of Lot No. 26 -

Commencing at <sup>a post standing at</sup> the N. W. corner of the Middle part of said Lot No. 26. Thence run N. 89 $\frac{1}{2}$ ° E. on the N. line of said Middle part of Lot No. 26, 12 chains 25 links to a post. Thence S.  $\frac{1}{2}$ ° E. 12 chains & 25 links to a post. Thence S. 89 $\frac{1}{2}$ ° W. 12 chains and 25 links to a post standing in the West line of said Middle part of Lot No. 26 - Thence N.  $\frac{1}{2}$ ° W. 12 chains and 25 links to the place of beginning containing fifteen acres of land -

Surveyed at the request of Enos Jew  
Feb. 24 - 1845

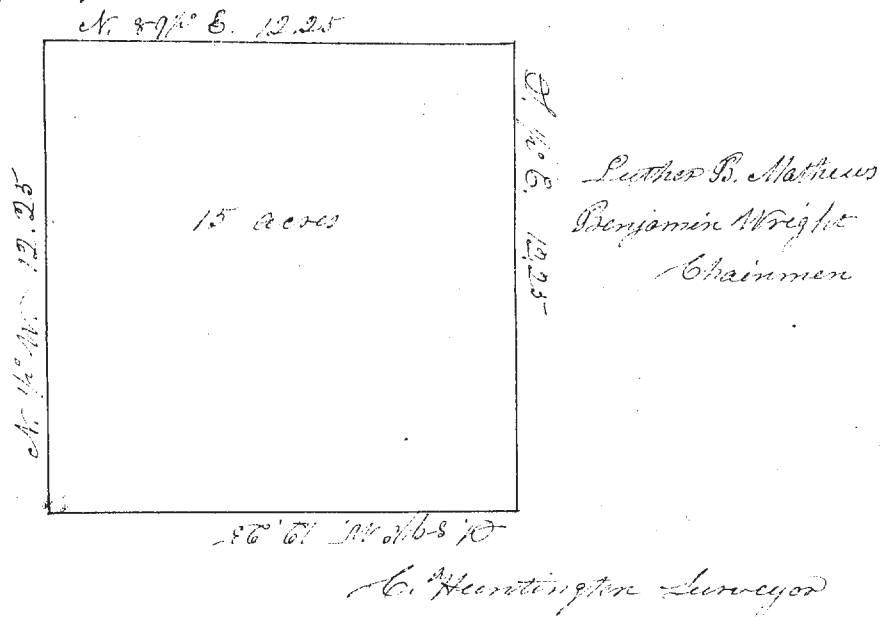

No. 19 Survey and plat of 10 acres of land sold by E. Corning, Treasurer of Lake County, to Rufus Marley for the sum of 3 dollars, 98 cents, 9 mills, the amount of taxes, interest and penalty due for the years 1841 & 1842 on 39 acres of land, valued at 124 dollars, and entered for taxation in the name of George & Richard Lord in the North part of Lot No. 28 in tract No. in Township No. 10 - (Peray) in the 7 Range of Townships - Sold December 26 - 1842.

Surveyed February 24, AD, 1845, at the request of Luther P. Mathews, assignee of Rufus Marley; as follows; commenced at a post standing in the N. W. corner of the N. part of Lot No. 28 - Thence run S.  $\frac{1}{2}$ ° E. along the W. line of said Lot 10 chains to a post in the centre of the N. & S. road, Thence N. 89 $\frac{1}{2}$ ° E. 10 chains to a post. Thence N.  $\frac{1}{2}$ ° W. 10 chains to a post standing in N. line of said Lot, being also in the centre of the E. & W. road running through the centre of the Township, Thence S. 89 $\frac{1}{2}$ ° W. along the centre of said E. & W. road 10 chains to the place of beginning containing 10 acres of land.

