

No. 15
 Survey and plot of the middle part of Lots No. 107 & 108 ~~new~~ survey in the town of Painesville - as follows - commence at the S. E. corner of William Herrs Lot, being the N. part of said Lots No. 107 & 108. Thence run Southwesterly on the west line of State Street forty feet to the N. E. corner of Colberts Huntington's part of Lots No. 107 & 108 - Thence Westerly on the N. line of said Huntington's lot one hundred fifteen and a half feet to the East line of James Root's part of Lot No. 108. Thence Northwesterly on the E. line of said Root's part of Lot No. 108 and parallel with State Street forty feet to the S. line of William Herrs Lot aforesaid. Thence Easterly along the South line of William Herrs Lot one hundred fifteen and a half feet to the place of beginning.

Surveyed at the request of Lyman Root, and in compliance with the Auditor's certificate of sale Painesville Sept 11 - 1844

Lewis M. Wilson
 Christopher S. Bartlet } Chairman

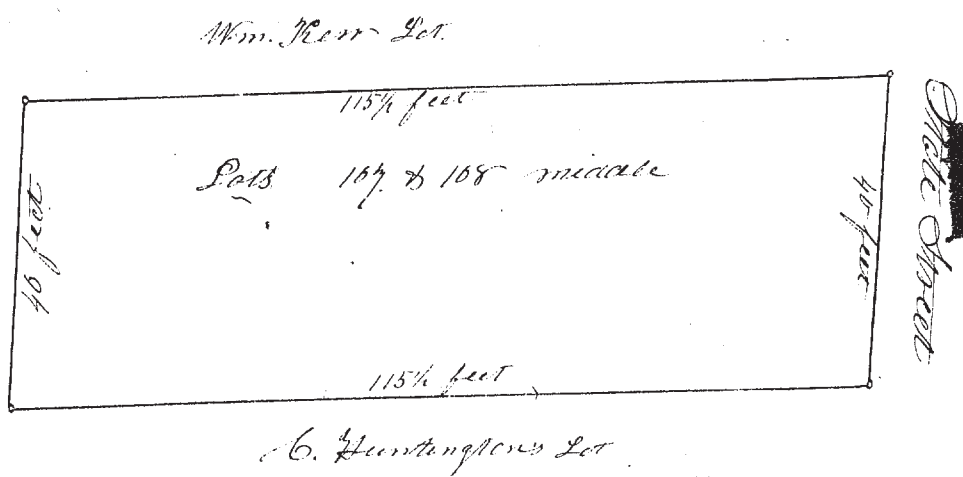

I certify the above to be a true survey
 Sept. 11 - 1844
 C. Huntington Surveyor of Lake Co. Ohio

No. 16
 Survey and plot of the dividing line between Jonathan Harrington and Samuel W. Heath's land in Lot No. 97 in the South Easterly part of the Township of Kirtland, Lake County, Ohio. viz - Began at a point in the N. line of said Lot No. 97 from which a black tree, eighteen inches in diameter, bears N. 74° West 29 links distant - Also another black tree sixteen inches diameter bears N. 54° E. 50 1/2 links distant. Being the place where the original stake stood as the N. W. corner of Jonathan Harrington's part of said Lot No. 97 and also the N. E. corner of Samuel W. Heath's part of said Lot No. 97 - and planted a stake and stone at said point, as the true corner, agreeably to the depositions of Jeri Sperry, Daniel S. Sperry jun. and Lewis Sperry. Thence run South 1 1/4° E. 9 chains 43 links to the centre of the road running from Chardon to Clearland.

Persons present at fixing said corner and running said line, beside the deponents. John Morse, Daniel Gow, Jenison Clark, Chairman - Willard Prince, Josiah Clark, Alfred Phelps, John A. Sweet, Jonathan Harrington, Samuel W. Heath, and Harlan Burlingame.

Kirtland October 5th 1844

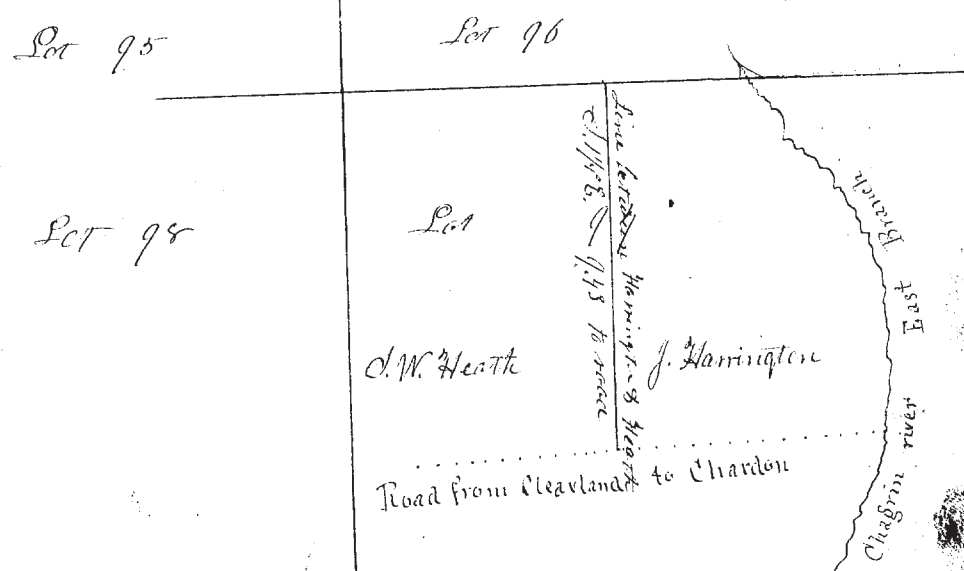

I certify the above to be a true survey and plot as made by me on the 5 day of Oct. 1844
 C. Huntington Surveyor of Lake Co. Ohio