

THE UNDERGROUND UTILITIES ARE SHOWN ACCORDING TO INFORMATION FURNISHED BY THE UTILITIES CONCERNED. THEIR ACCURACY IS NOT GUARANTEED, THEREFORE THEY SHOULD BE RECHECKED BEFORE UNDERGROUND CONSTRUCTION BEGINS.

PROP. SIGN

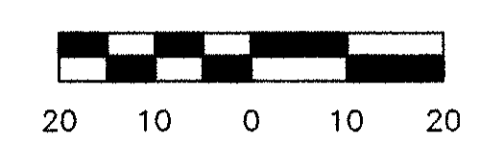

R-72 E
18" x 18"
QTY. = 4

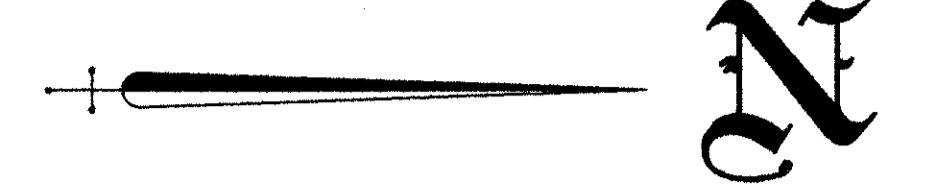

SCALE

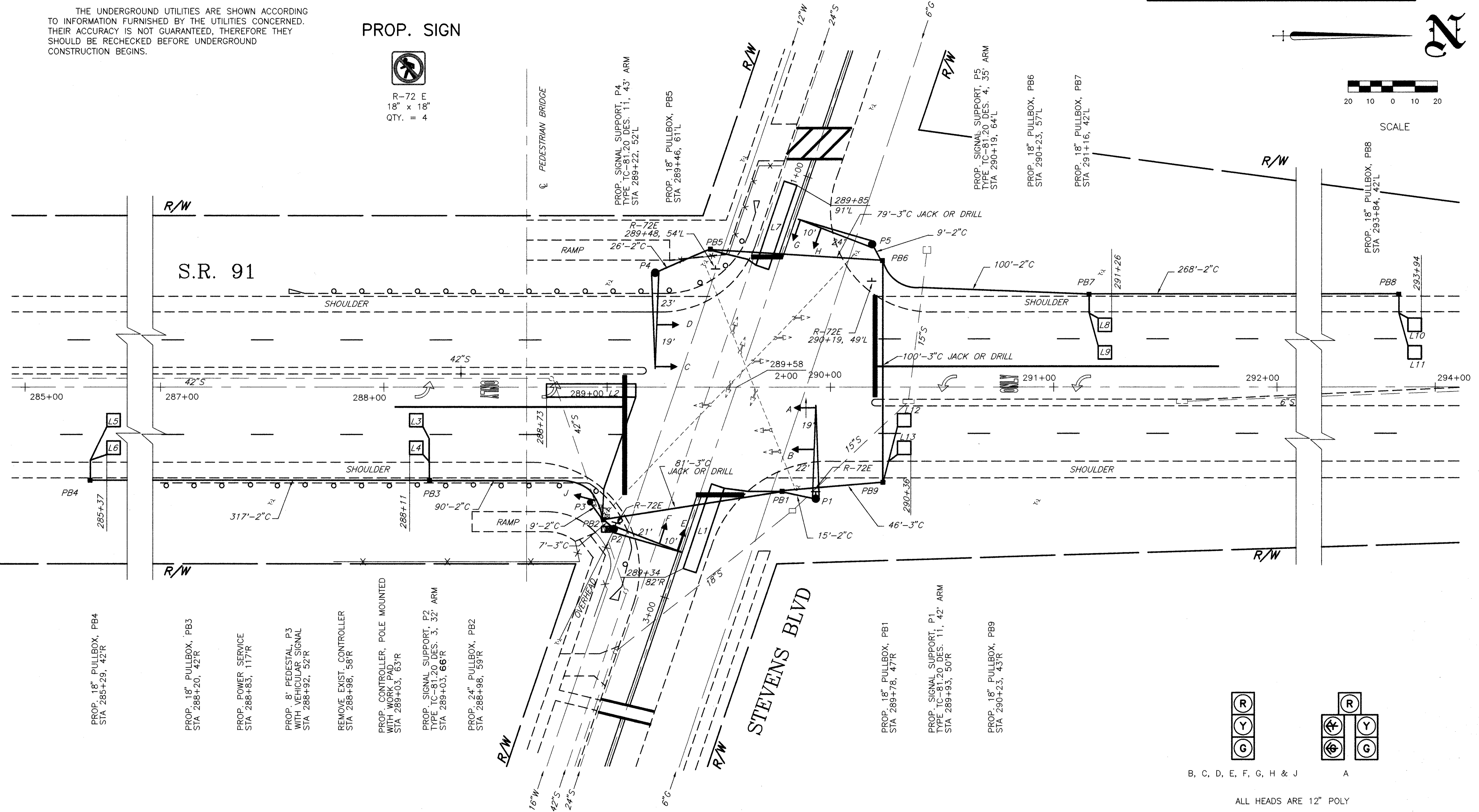

PROP. 18" PULLBOX, PB4
STA 285+29, 42'R

PROP. 18" PULLBOX, PB3
STA 288+20, 42'R

PROP. POWER SERVICE
STA 288+83, 117'R

PROP. 8' PEDESTAL, P3
WITH VEHICULAR SIGNAL
STA 288+92, 52'R

REMOVE EXIST. CONTROLLER
STA 288+98, 58'R

PROP. CONTROLLER, POLE MOUNTED
WITH WORK PAD
STA 289+03, 63'R

PROP. SIGNAL SUPPORT, P2
TYPE TC-81.20 DES. 3, 32' ARM
STA 289+03, 66'R

PROP. 24" PULLBOX, PB2
STA 288+98, 59'R

PROP. 18" PULLBOX, PB1
STA 289+78, 47'R

PROP. SIGNAL SUPPORT, P1
TYPE TC-81.20 DES. 11, 42' ARM
STA 289+93, 50'R

PROP. 18" PULLBOX, PB9
STA 290+23, 43'R

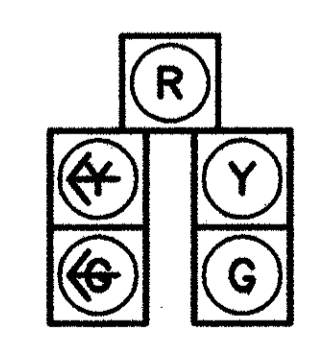
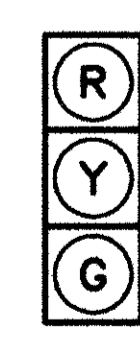

B, C, D, E, F, G, H & J A

ALL HEADS ARE 12" POLY

SIGNALS

REVISED 11-29-94