

ESTIMATED QUANTITIES

ITEM	ITEM EXT.	TOTAL	UNIT	DESCRIPTION	GENERAL	ABUT.	PIER	SUPER.	AS PER PLAN REFERENCE SHEET NO.
TRAFFIC CONTROL									
202	54101	61	Each	Raised Pavement Marker Removed For Storage, As Per Plan	61				2/7
621	00200	67	Each	Raised Pavement Marker, Installation Only	67				
632	26500	4	Each	Detector Loop #	4				
828	10000	0.60	Mile	Edge Line	0.60				
828	10100	0.15	Mile	Lane Line	0.15				
828	10300	260	Lin.Ft.	Channelizing Line	260				
828	20300	3 4	Each	Lane Arrow	3 4				
828	20400	3 2	Each	Word on Pavement, 72"	3 2				
ROADWAY									
202	23500	406	Sq.Yd.	Wearing Course Removed	406				
202	38001	100	Lin.Ft.	Guardrail Removed, As Per Plan ☒	100				3/7
202	47001	4	Each	Bridge Terminal Assembly Removed, As Per Plan	4				3/7
407	10000	31	Gal.	Tack Coat	31				
448	50001	34	Cu.Yd.	Asphalt Concrete Surface Course, Type 1H, As Per Plan	34				2/7
448	46040	20	Cu.Yd.	Asphalt Concrete Intermediate Course, Type 2, PG64-28	20				
448	47020	14	Cu.Yd.	Asphalt Concrete Surface Course, Type 1, PG64-22	14				
606	13000	100	Lin.Ft.	Guardrail, Type 5 ☒	100				
606	35120	4	Each	Bridge Terminal Assembly, Type 3	4				
STRUCTURE QUANTITIES									
SPECIAL	51267510	375	Sq.Yd.	Sealing Concrete Surfaces (Epoxy-Urethane) (See Proposal Note)		2	21	352	
509	20001	200	Pound	Reinforcing Steel, Replacement of Existing Reinforcing Steel, As Per Plan ☒				200	4/7
516	11800	2	Lin.Ft.	Vertical Extension of Structural Expansion Joint				2	
517	73008	646	Lin.Ft.	Railing (Thrie Beam Rail), Misc.: Bridge Retrofit Railing				646	
519	11101	200	Sq.Ft.	Patching Concrete Structure, As Per Plan		16	184	243	2/7
SPECIAL	51911704	243	Lin.Ft.	Patching Concrete Structure, Misc.: Curb Repair				243	2/7
SPECIAL	53001300	589	Lin.Ft.	Structure, Misc.: Sealing Concrete Wearing Surface Construction Joints With HMWM Resin				589	
601	20500	25	Cu.Yd.	Crushed Aggregate Slope Protection ▲	25				
848	10001	2,163	Sq.Yd.	Micro Silica Modified Concrete Overlay Using Hydro-Demolition (2 1/4 Inch Thick), As Per Plan				2,163	3/7
848	20001	2,163	Sq.Yd.	Surface Preparation Using Hydro-Demolition, As Per Plan				2,163	3/7
848	30001	78	Cu.Yd.	Micro-Silica Modified Concrete Overlay (Variable Thickness), Material Only, As Per Plan				78	3/7
848	50000	136	Sq.Yd.	Hand Chipping				136	
848	50100	Lump Sum		Test Slab	Lump				
848	50201	9	Cu.Yd.	Full Depth Repair, As Per Plan				9	3/7
848	50321	2,163	Sq.Yd.	Existing Concrete Overlay Removed (1 1/4 Inch LMC), As Per Plan				2,163	3/7
848	50340	1,250	Sq.Yd.	Removal Debonded or Deteriorated Existing Variable Thickness Concrete Overlay				1,250	
614	11000	Lump Sum		Maintaining Traffic	Lump				
614	22000	1.12	Mile	Temporary Edge Line, Class I, 740.06, Type 1	1.12				
614	20200	0.50	Mile	Temporary Lane Line, Class I, 740.06, Type 1	0.50				
Special	61411200	784	Hour	Law Enforcement Officer	784				
624	10000	Lump Sum		Mobilization	Lump				

ITEM 509 - REINFORCING STEEL REPLACEMENT OF EXISTING REINFORCING STEEL, AS PER PLAN
 THIS PAYMENT ITEM SHALL BE USED FOR REPLACING DETERIORATED REINFORCING STEEL BARS IN THE DECK AND CURBS WHERE DIRECTED BY THE ENGINEER. BARS SHALL BE GRADE 60, UNCOATED AND MATCH THE SIZE THEY ARE REPLACING. SPLICE LENGTHS TO EXISTING REINFORCING SHALL BE 18" MIN. INSTALLATION SHALL BE INCIDENTAL TO THE UNIT PER POUND PRICE BID FOR ITEM 509.

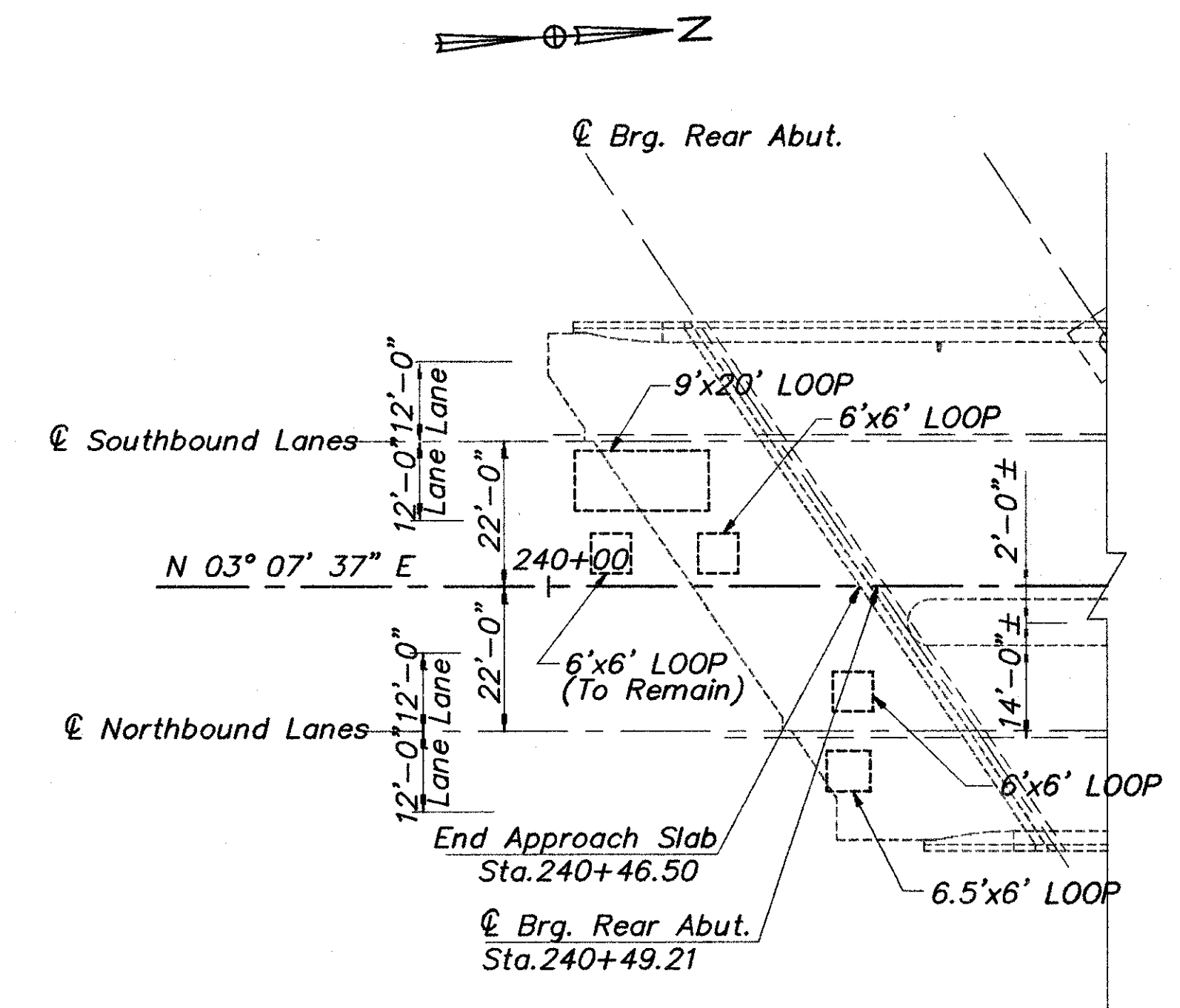

EXISTING LOOP DETECTOR LOCATIONS

NOTES:

- # - Replace Existing Detector Loop in its Original Location After Completion of Resurfacing Operations. (See Detail Above). Detector Loop Wire Shall be Spliced to Loop Detector Lead-in Cable at the Nearest Pull Box.
- ▲ - Crushed Aggregate Slope Protection Shall be Placed on the Bare Area Near the South Abutment As Directed by the Engineer.
- ☒ - To Be Used As Directed By Engineer.

MATERIAL FURNISHED BY THE DEPARTMENT - INSTALLATION ONLY

DESCRIPTION	TWO-WAY WHITE-RED	TWO-WAY YELLOW-RED
RAISED PAVEMENT MARKER, INSTALLATION ONLY	47	20
TOTAL BY COLOR	47	20

	TOTAL	NUMBER OF CONVENTIONAL HIGH PROFILE	NUMBER OF TAPERED LOW PROFILE
RAISED PAVEMENT MARKER, INSTALLATION ONLY	67	67	

NOTE:

THE CONTRACTOR SHALL FIELD LOCATE AND RECORD THE LOCATIONS OF THE EXISTING RAISED PAVEMENT MARKINGS PRIOR TO BEGINNING REMOVAL WORK. THIS INFORMATION SHALL BE USED FOR INSTALLING THE RECYCLED RPM'S IN THE SAME LOCATIONS AS EXISTING.

NO.	REVISIONS	BY	DATE
1	ASPHALT MATERIAL TYPE	JPR	8/3/00
2	TEMPORARY PAVEMENT MARKING TYPE	JPR	8/3/00
3	PAVEMENT MARKING QUANTITIES	JPR	8/3/00

H:\2000\00063\CAD\0006302.DWG PLOT SCALE: 1:48