

NO.	REVISIONS	BY	DATE
1	DELETE SIGN	JPR	8/3/00
2	DELETE SIGNAL TIMING NOTE	JPR	8/3/00

DURING EACH PHASE OF CONSTRUCTION, THE CONTRACTOR SHALL TEMPORARILY MODIFY THE SIGNAL TIMING AT EACH RAMP AS DIRECTED BY THE ENGINEER. AFTER COMPLETION OF CONSTRUCTION, THE CONTRACTOR SHALL RETURN THE CONTROLLER TO THE ORIGINAL SETTINGS. THE COST OF SIGNAL MODIFICATION SHALL BE INCLUDED IN THE UNIT PRICE BID FOR ITEM 614 MAINTENANCE OF TRAFFIC.

ALL CONFLICTING SIGNAGE SHALL BE COVERED. ALL CONFLICTING PAVEMENT MARKINGS SHALL BE COVERED WITH TEMPORARY TAPE.

NOTE: ALL SIGNS SHALL BE LOCATED PER THE STANDARD CONSTRUCTION DRAWINGS. S.R. 91 LANE CLOSURES SHALL BE PER MT-95.30 WITH ADDITIONAL SIGNAGE AS INDICATED.

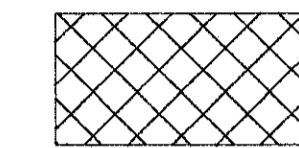

WORK AREA - PHASE I

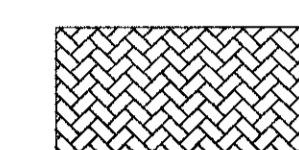

WORK AREA - PHASE III

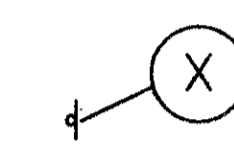

CONSTRUCTION SIGNING
(REFER TO SIGNING LEGEND FOR REQUIRED SIGNS)

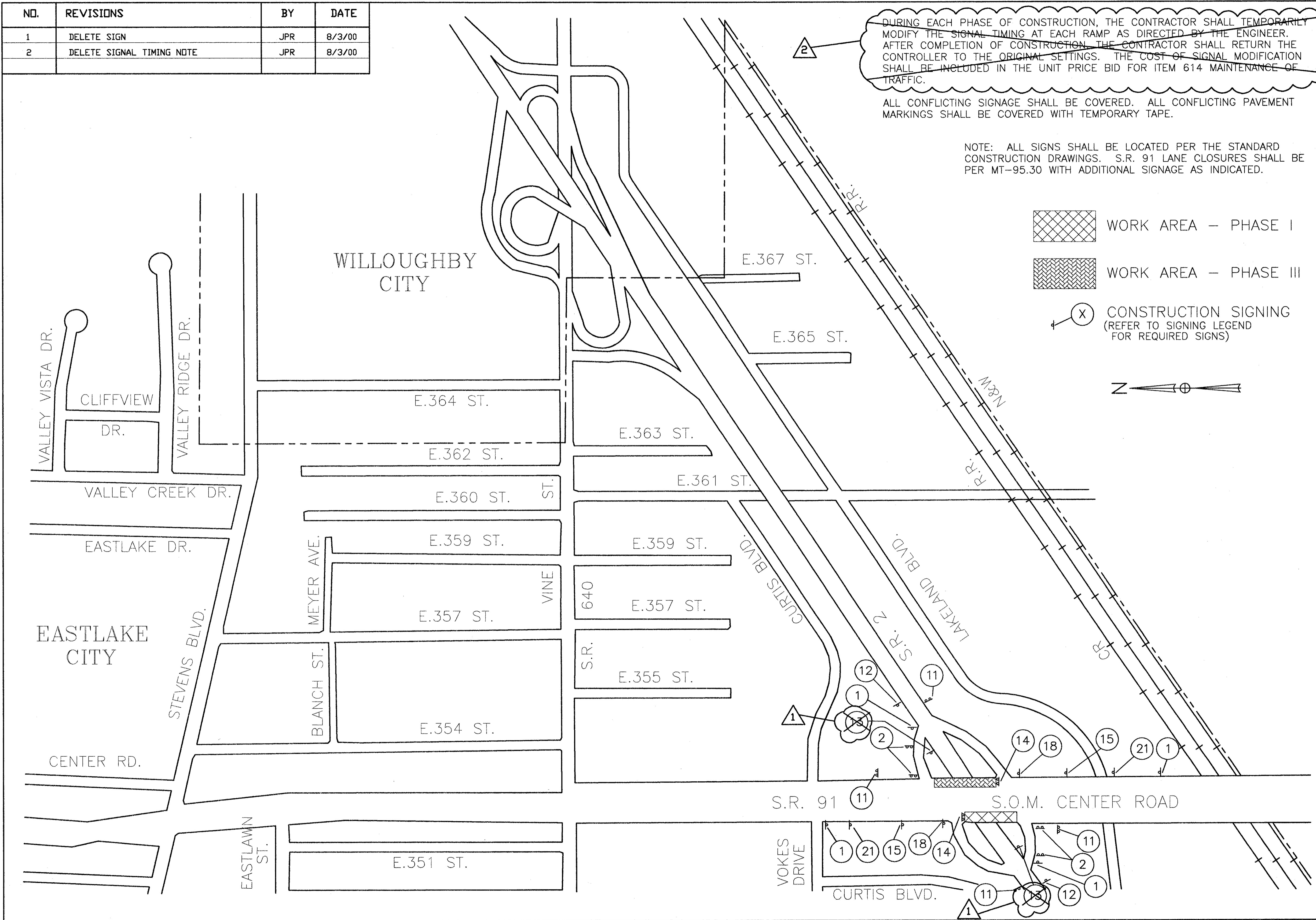
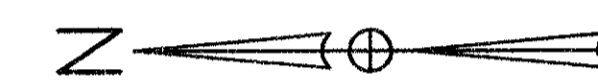

H:\2000\00063\CAD\TRAFFIC\063MOT.DWG PLOT SCALE 1:12