

PLOTTED BY: fkonopka  
 PLOTTED FROM: i:\Users\bkruse\p09864\p09864gpk.dgn  
 09864GPK.DGN  
 PLOT SUBMITTED: 09-OCT-1998 09:18

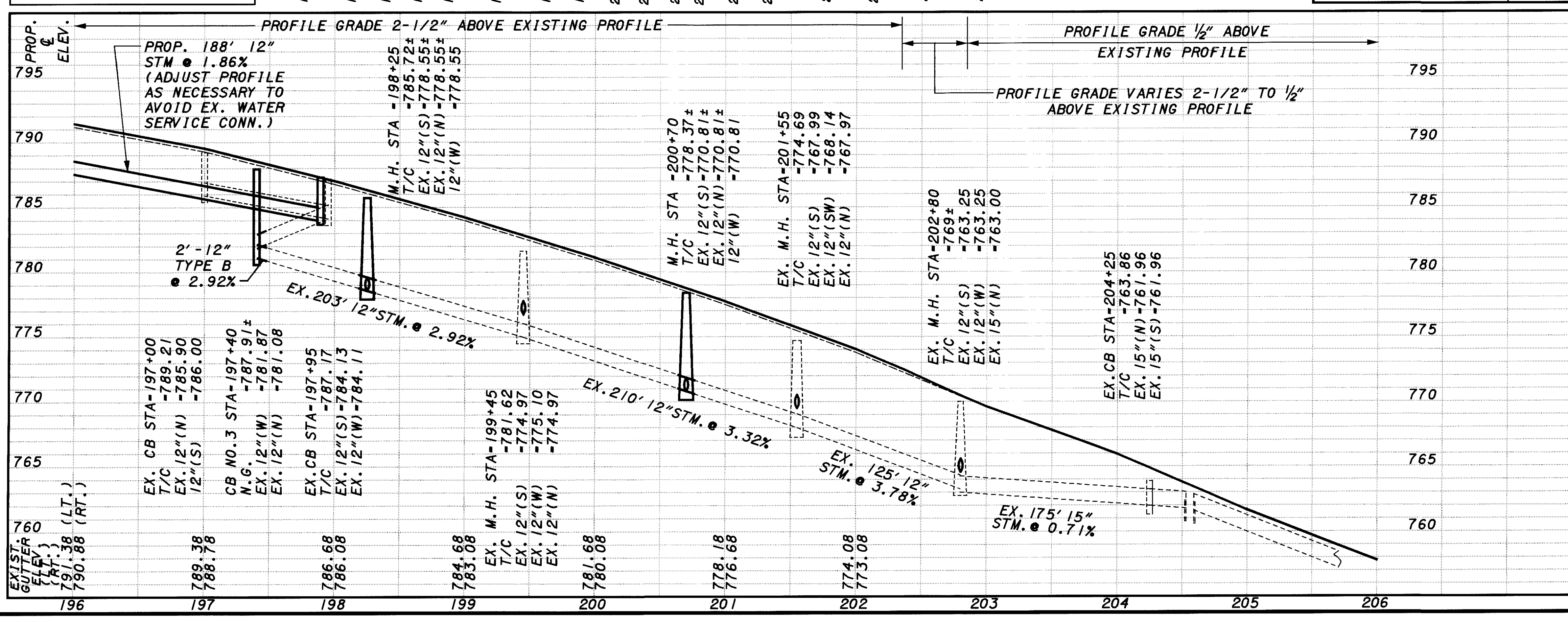
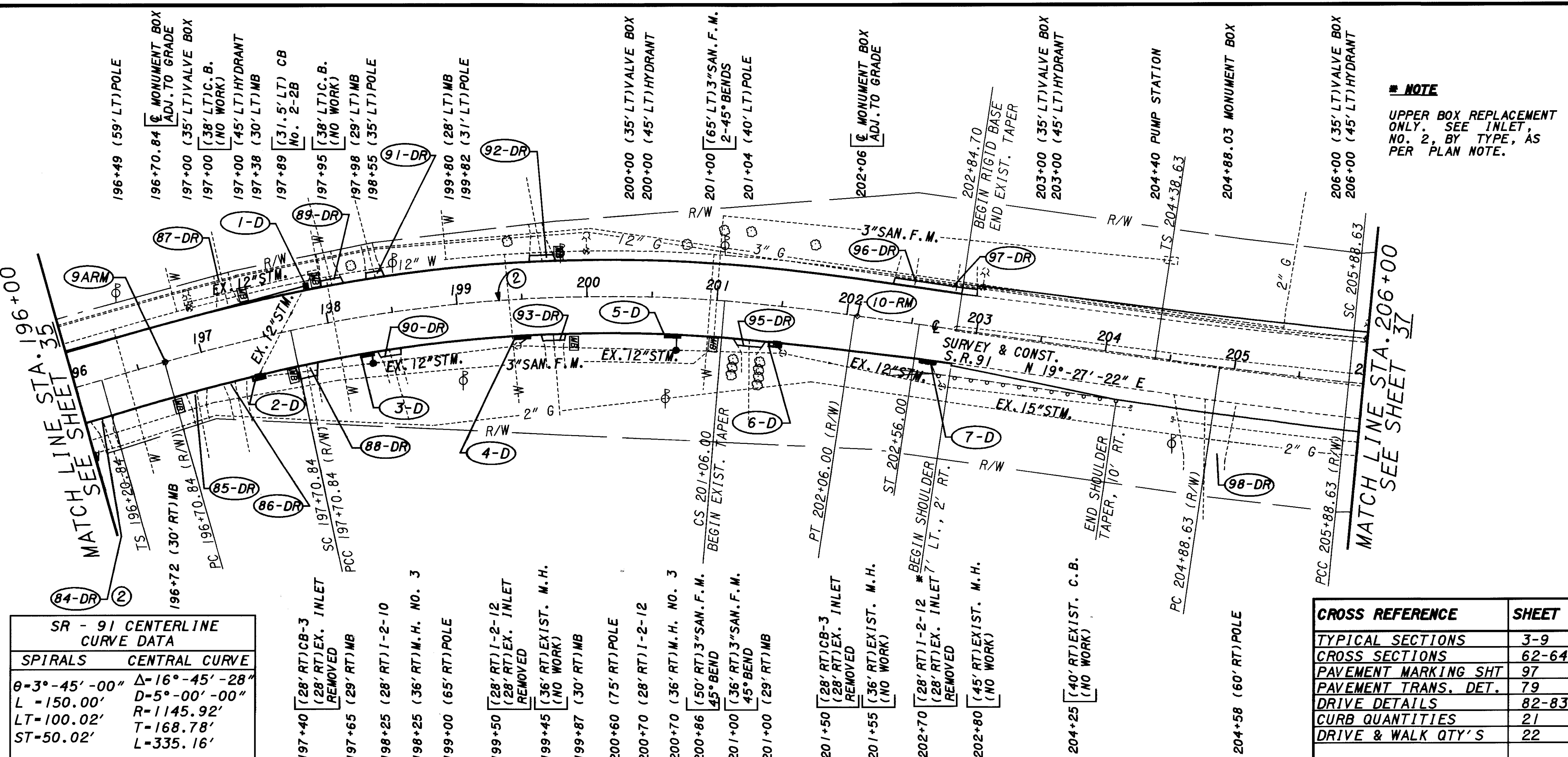

**SR - 91 CENTERLINE CURVE DATA**

SPIRALS		CENTRAL CURVE
$\theta = 3^\circ - 45' - 00''$	$\Delta = 16^\circ - 45' - 28''$	
$L = 150.00'$	$D = 5^\circ - 00' - 00''$	
$ST = 50.02'$	$R = 1145.92'$	
	$T = 168.78'$	
	$L = 335.16'$	

**CROSS REFERENCE SHEET**

CROSS REFERENCE	SHEET
TYPICAL SECTIONS	3-9
CROSS SECTIONS	62-64
PAVEMENT MARKING SHT	97
PAVEMENT TRANS. DET.	79
DRIVE DETAILS	82-83
CURB QUANTITIES	21
DRIVE & WALK QTY'S	22

**\* NOTE**  
 UPPER BOX REPLACEMENT ONLY. SEE INLET, NO. 2, BY TYPE, AS PER PLAN NOTE.

REF. NO.	STATION TO STATION	CONDUIT TYPE			CATCH BASIN NO. 2-2B	CATCH BASIN NO. 3	INLET NO. 2-6	INLET NO. 2-10	INLET NO. 2-12 AS PER PLAN	INLET NO. 2-12, MANHOLE, NO. 3
		B 12" 12"	C 12" 12"	F 6"						
1-D	196+00 LT TO 197+89 LT.	192								
2-D	197+40 RT.	2		10						
3-D	198+25 RT.			10						
4-D	199+50 RT.			10						
5-D	200+70 RT.									
6-D	201+50 RT.									
7-D	202+70 RT.									
TOTALS CARRIED TO DRAINAGE SUB-SUMMARY		194	42	30	1	2	1	2	1	2