

Sta. 134+93 Remove 30' of 8" vit. pipe & build std. 12" enc. vit. pipe culvert 60' long, 2-12" 12" 15. Extend each T with 12" of 12" enc. vit. pipe, build 4 hws.
Quantities
80 lin. ft. 12" vit. pipe 2-12" 12" 15.
4 cu. yds. 1-2-3/4 conc. 9' cu. yds.
1-3-5 conc. 10 cu. yds. excav. 130 lbs. steel

Sta. 148+66 Build std. 15" encased vit. pipe culvert 44' long & 2 hws.
Quantities
44'-15" vitrified pipe
5.7 cu. yds. 1-3-5 conc.
2.3 cu. yds. 1-2-3/4 conc.
10 cu. yds. excavation 70 lbs. steel
Sta. 137+62 Extend present 10" pipe 6' 6" L & build 1 hw.
Quantities
6'-10" vit. pipe 1 cu. yd. exc.
1 cu. yd. 1-2-3/4 conc.
32 lbs. steel

Sta. 156+50 Build std. 10" encased vit. pipe culvert 18' long & 2 inlet basins
Quantities
18'-10" vit. pipe 2 inlet basins
1.9 cu. yds. 1-3-5 conc. 5 cu. yds. excav.
Sta. 159 Build std. 10" encased vit. pipe culvert 18' long & 2 inlet basins
Quantities
18'-10" vit. pipe 2 inlet basins
1.9 cu. yds. 1-3-5 conc. 5 cu. yds. excav.
Sta. 156+50 to Sta. 162+25 on right of E. Build 575'-12" vit. pipe sewer
Quantities 575'-12" vit. pipe

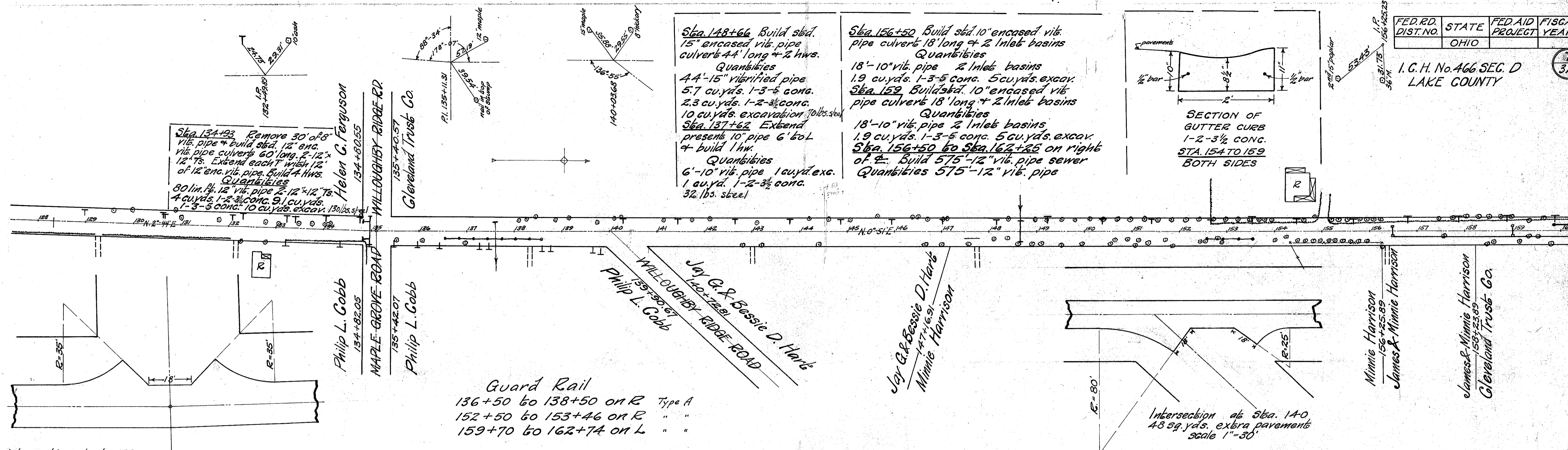
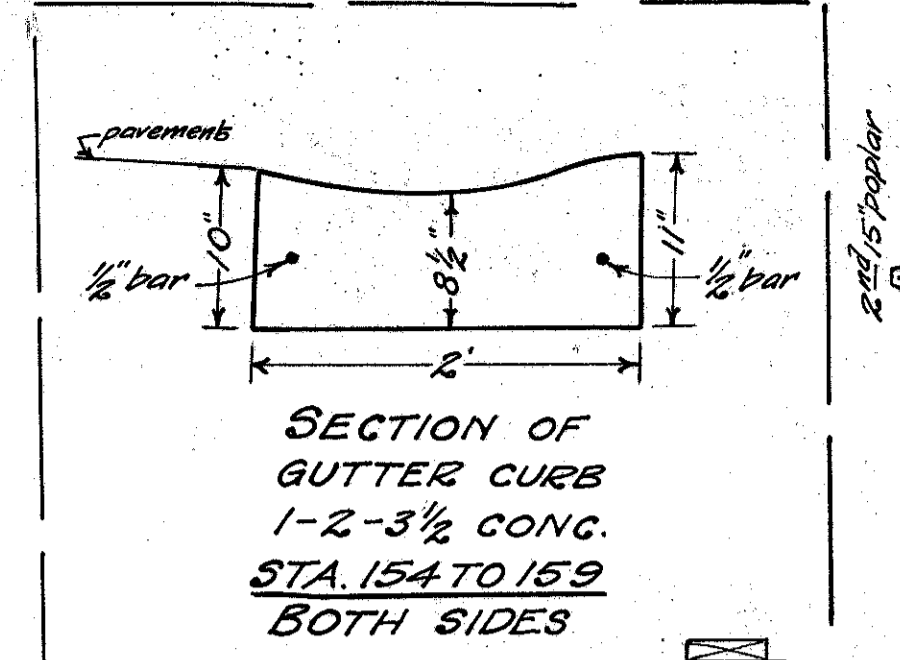

Guard Rail
136+50 to 138+50 on R Type A
152+50 to 153+46 on R " "
159+70 to 162+74 on L " "

Intersection of Sta. 155+11, 29 sq. yds. extra pavement
Scale 1" = 20'

B.M. #37 Sta. 132+72
S. corner porch on house
60' R. of E
Elev. = 792.98

B.M. #38 Sta. 136+08
Spike in root 12" maple
20' 60' R. of E
Elev. = 786.87

B.M. #39 Sta. 141+15
Spike in root 15" elm
24' 60' L. of E
Elev. = 792.30

B.M. #40 Sta. 145+66
Spike in side 24" elm
33' 60' L. of E
Elev. = 781.57

B.M. #41 Sta. 151+09
Spike in root 24" maple
28' 60' R. of E
Elev. = 774.01

B.M. #42 Sta. 154+48
Spike in root 12" poplar
19' 60' R. of E
Elev. = 775.16

B.M. #43 Sta. 159+79
Spike in root 30" maple
28' 60' R. of E
Elev. = 746.85

