

EXTRA AREA DETAILS

S. R. 91 & S. R. 6

SCALE: 1" = 20'

FED. RD. DIVISION	STATE	PROJECT
2	OHIO	

41
146

LAKE COUNTY
LAK. 91-(0.00)-(2.38)

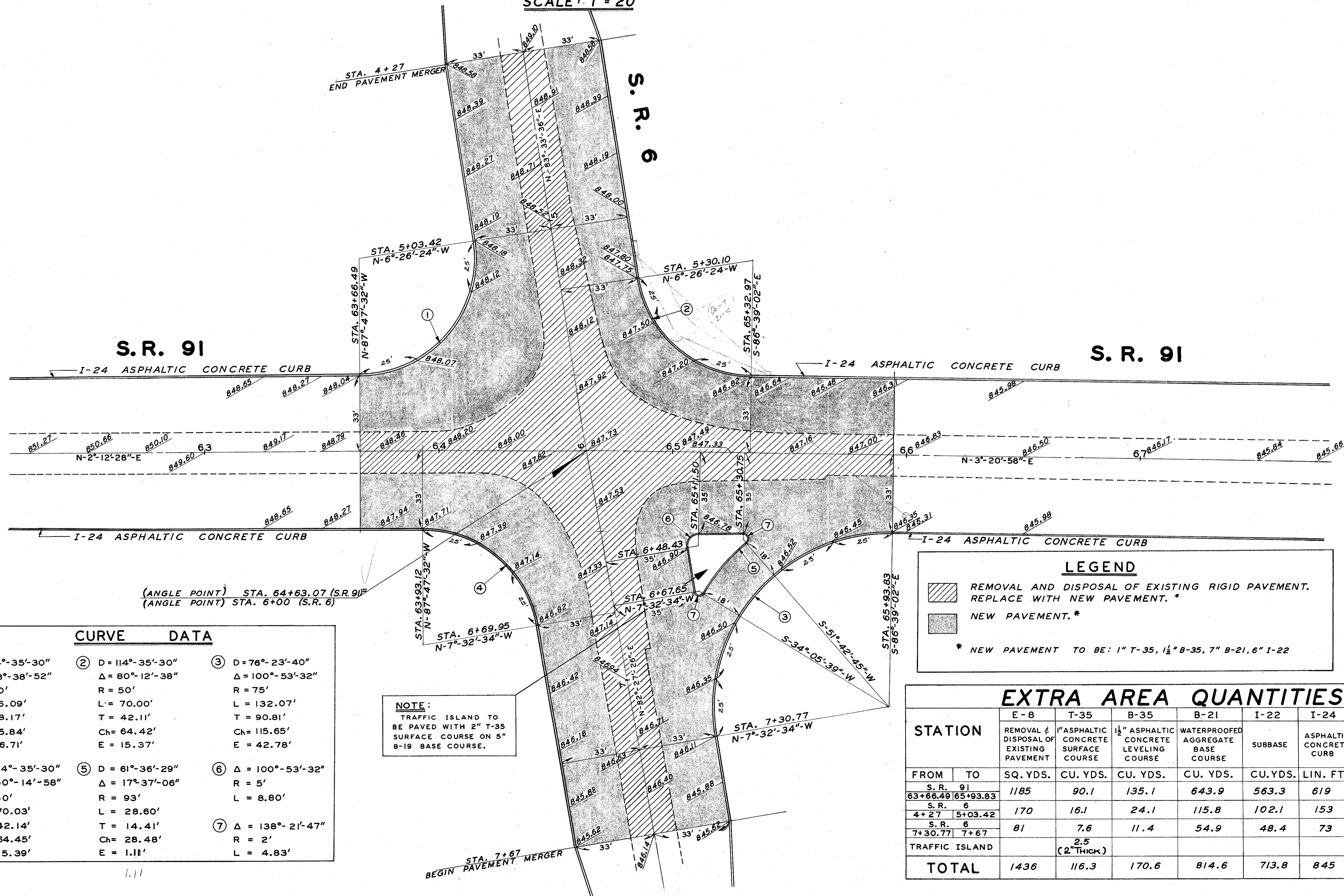

CURVE DATA		
① D = 114°-35'-30" Δ = 98°-38'-52" R = 50' L = 86.09' T = 58.17' Ch = 75.84' E = 26.71'	② D = 114°-35'-30" Δ = 80°-12'-38" R = 50' L = 70.00' T = 42.11' Ch = 64.42' E = 15.37'	③ D = 76°-23'-40" Δ = 100°-53'-32" R = 75' L = 132.07' T = 90.81' Ch = 115.65' E = 42.78'
④ D = 114°-35'-30" Δ = 80°-14'-58" R = 50' L = 70.03' T = 42.14' Ch = 64.45' E = 15.39'	⑤ D = 61°-36'-29" Δ = 17°-37'-06" R = 93' L = 28.60' T = 14.41' Ch = 28.48' E = 1.11'	⑥ Δ = 100°-53'-32" R = 5' L = 8.80'
		⑦ Δ = 138°-21'-47" R = 2' L = 4.83'

NOTE:
TRAFFIC ISLAND TO BE PAVED WITH 2" T-35 SURFACE COURSE ON 5" B-19 BASE COURSE.

LEGEND

REMOVAL AND DISPOSAL OF EXISTING RIGID PAVEMENT. REPLACE WITH NEW PAVEMENT. *

NEW PAVEMENT. *

* NEW PAVEMENT TO BE: 1" T-35, 1 1/2" B-35, 7" B-21, 6" I-22

		E-8	T-35	B-35	B-21	I-22	I-24	B-19
STATION		REMOVAL & DISPOSAL OF EXISTING PAVEMENT	1" ASPHALTIC CONCRETE SURFACE COURSE	1 1/2" ASPHALTIC CONCRETE LEVELING COURSE	WATERPROOFED AGGREGATE BASE COURSE	SUBBASE	ASPHALTIC CONCRETE CURB	AGGREGATE BASE COURSE
FROM	TO	SQ. YDS.	CU. YDS.	CU. YDS.	CU. YDS.	CU. YDS.	LIN. FT.	CU. YDS.
S. R. 91 63+66.49 65+93.83		1185	90.1	135.1	643.9	563.3	619	
S. R. 6 4+27 5+03.42		170	16.1	24.1	115.8	102.1	153	
S. R. 6 7+30.77 7+67		81	7.6	11.4	54.9	48.4	73	
TRAFFIC ISLAND			2.5 (2" THICK)					6.2
TOTAL		1436	116.3	170.6	814.6	713.8	845	6.2