

**LAKE COUNTY**  
**Sec. LAK 91-(0.00)-(2.38)**

Ref. No	Station	ITEM I-1		ITEM I-8		ITEM I-16		ITEM I-12	
		Class	QTY	Class	QTY	Class	QTY	Class	QTY
1-S	119+20	12"	100	3-A	1	ABANDON	1	PIPE	1
2-S	117+45	12"	204	3-A	1	ABANDON	1	REMOVAL	1
3-S	119+75	12"	100	3-A	1	ABANDON	1	PIPE	1
4-S	119+75	12"	75	3-A	1	ABANDON	1	REMOVAL	1
5-S	116+99	12"	75	3-A	1	ABANDON	1	PIPE	1
<b>TOTAL</b>			<b>479</b>		<b>3</b>		<b>4</b>		<b>256</b>

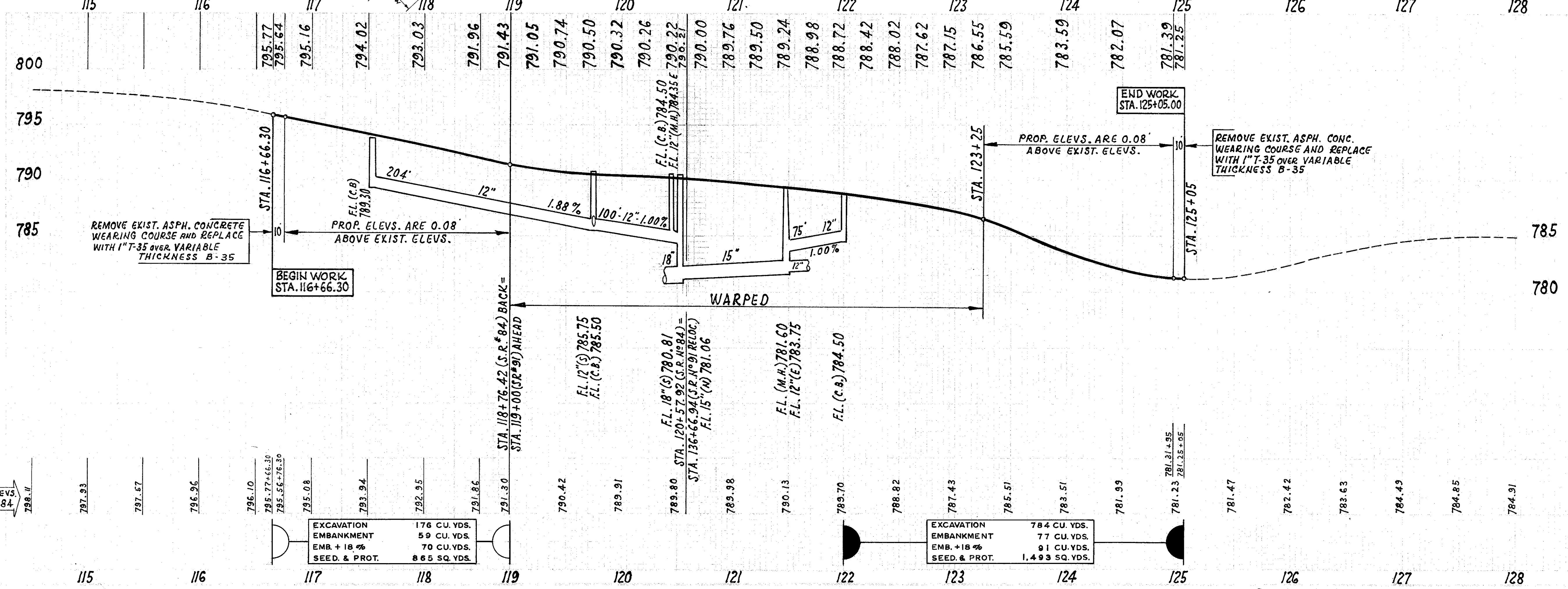

**TRAFFIC DIVIDERS**

Station	ITEM I-23	QTY
FROM	TO	EACH
117+38.30	119+53.88	17
121+69	124+21	22
<b>TOTAL</b>		<b>39</b>

**PLAN & PROFILE - S.R. No 84 - STA. 115+00 to STA. 128+00**