

LAKE COUNTY
LAK-91-(0.00)-(2.38)

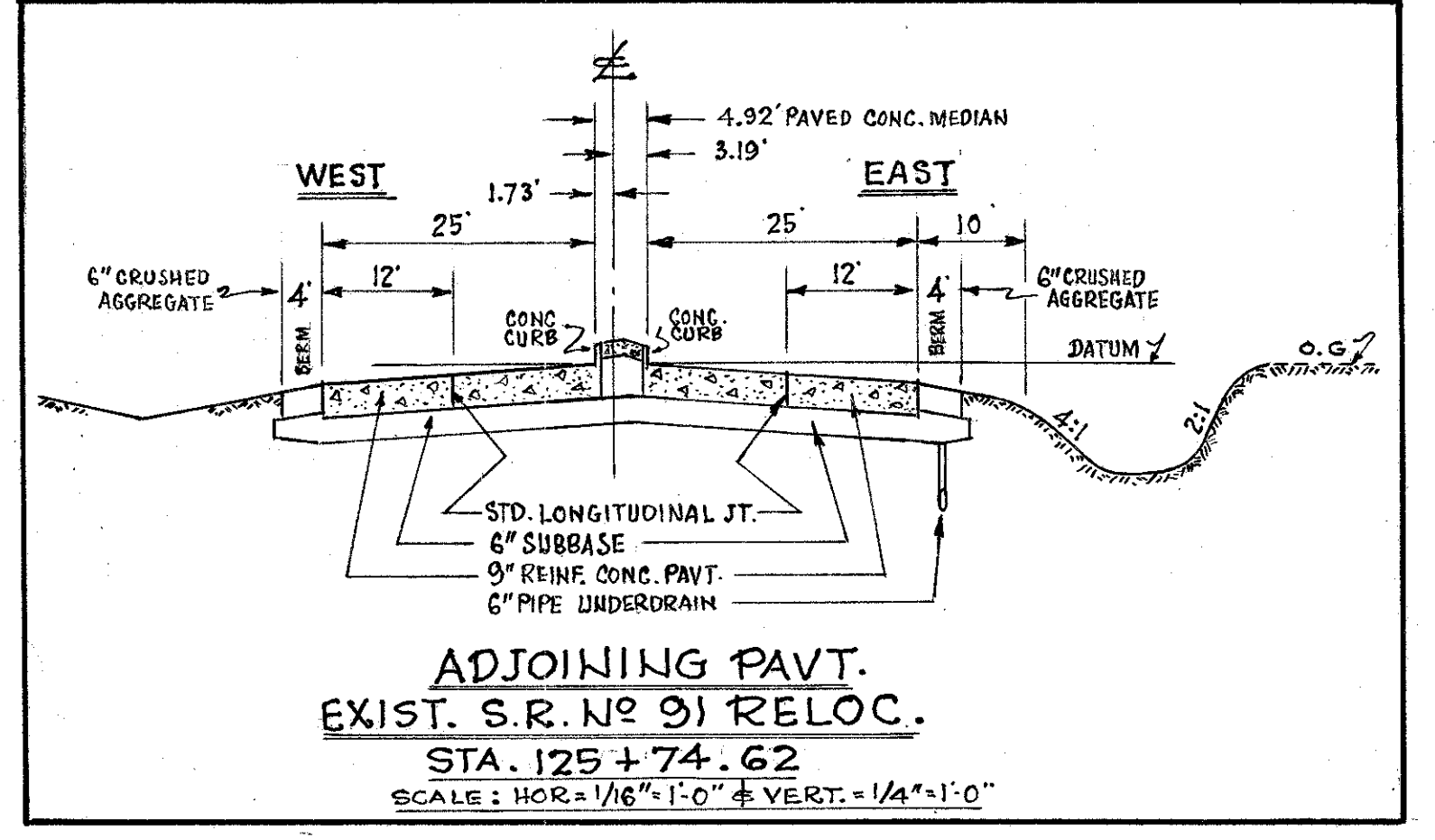
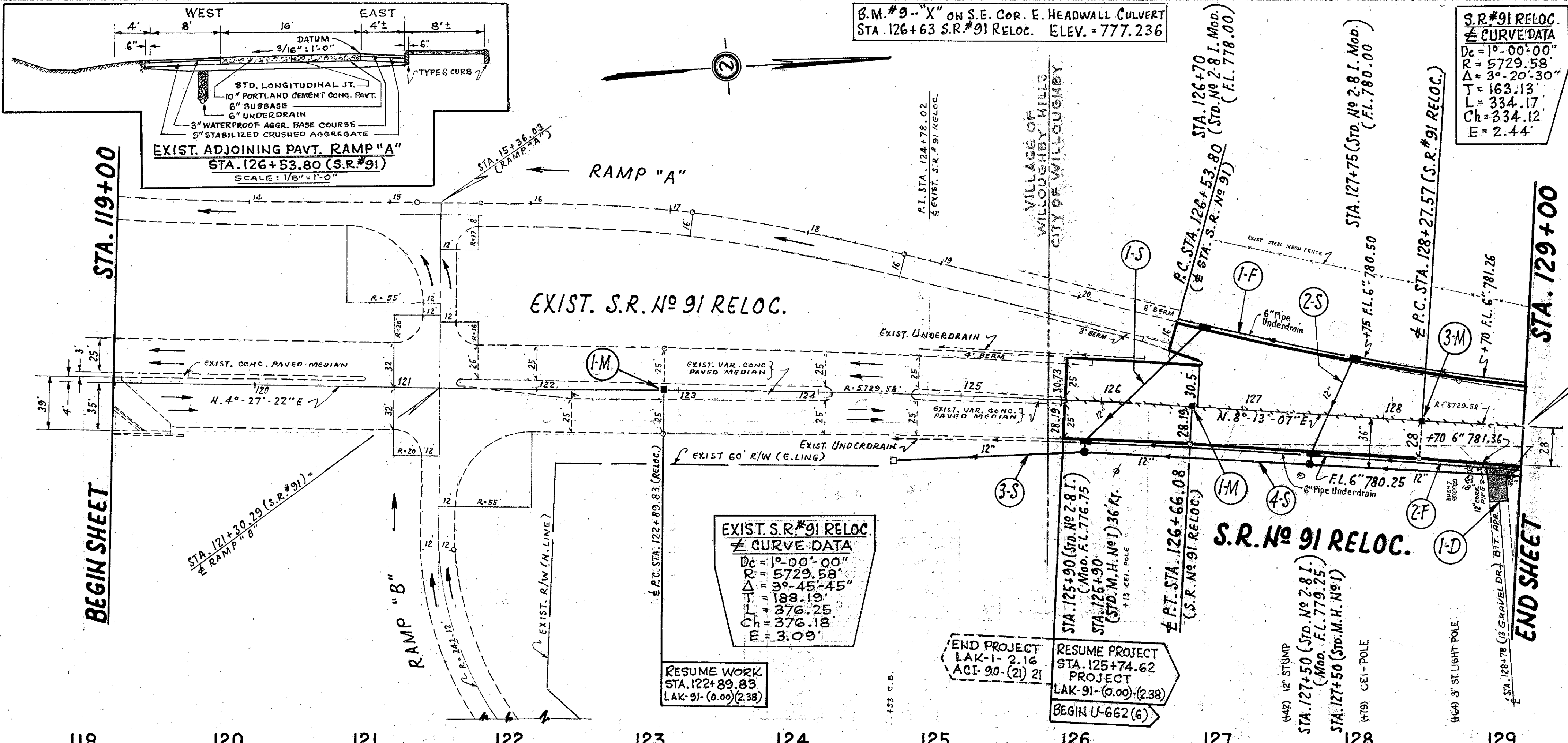

NOTE: 30 EXISTING TRAFFIC DIVIDERS ON EXISTING S.R.#91, STA. 125+80 TO STA. 129+40

STORM SEWERS						
Ref. No	Station	ITEM I-1 - LIN. FT.		ITEM I-8		
		Class J-1 PIPE	Class E-1 PIPE	STD. M.H. No 1	STD. M.H. No 2-8 I. MOD. EACH	
1-S	125+90	124+70	116	7		2
2-S	127+50	127+75	76	7		2
3-S	125+62	125+90		27		1
4-S	125+90	129+00		310		1
TOTAL		CITY OF WILLOUGHBY	192	351		2 4
TOTAL		WILLOUGHBY HILLS VILL.		110		

6" UNDERDRAINS					
Ref. No	Station	Side R or L	ITEM I-1		ITEM I-1 OUTLET PIPE Class F-4
			6" PIPE Class I-3 (SHALLOW) LIN. FT.	6" PIPE Class I-3 (DEEP) LIN. FT.	
1-F	126+53.80	L	190	30	20
2-F	125+74.62	R	274	30	20
TOTAL		CITY OF WILLOUGHBY	464	60	40

TRAFFIC DIVIDERS			
Station	FROM	TO	ITEM I-23
			ITEM E-8
			PRECAST WHITE PORTLAND CEMENT TRAFFIC DIVIDERS EACH
			REMOVAL AND DISPOSAL OF EXISTING TRAFFIC DIVIDERS EACH
	125+82	129+00	54
	125+80	129+40	30
TOTAL		CITY OF WILLOUGHBY	54 30

Ref. No	Station	MONUMENTS	
		ITEM I-8 STANDARD MONUMENT ASSEMBLY EACH	ITEM E-8 REMOVAL AND DISPOSAL OF EXISTING MONUMENT ASSEMBLY EACH
1-M	P.C. 122+89.83	1	1
2-M	P.T. 126+66.08	1	1
3-M	P.C. 128+27.57	1	1
TOTAL		VILLAGE OF WILLOUGHBY HILLS	1 1
TOTAL		CITY OF WILLOUGHBY	2

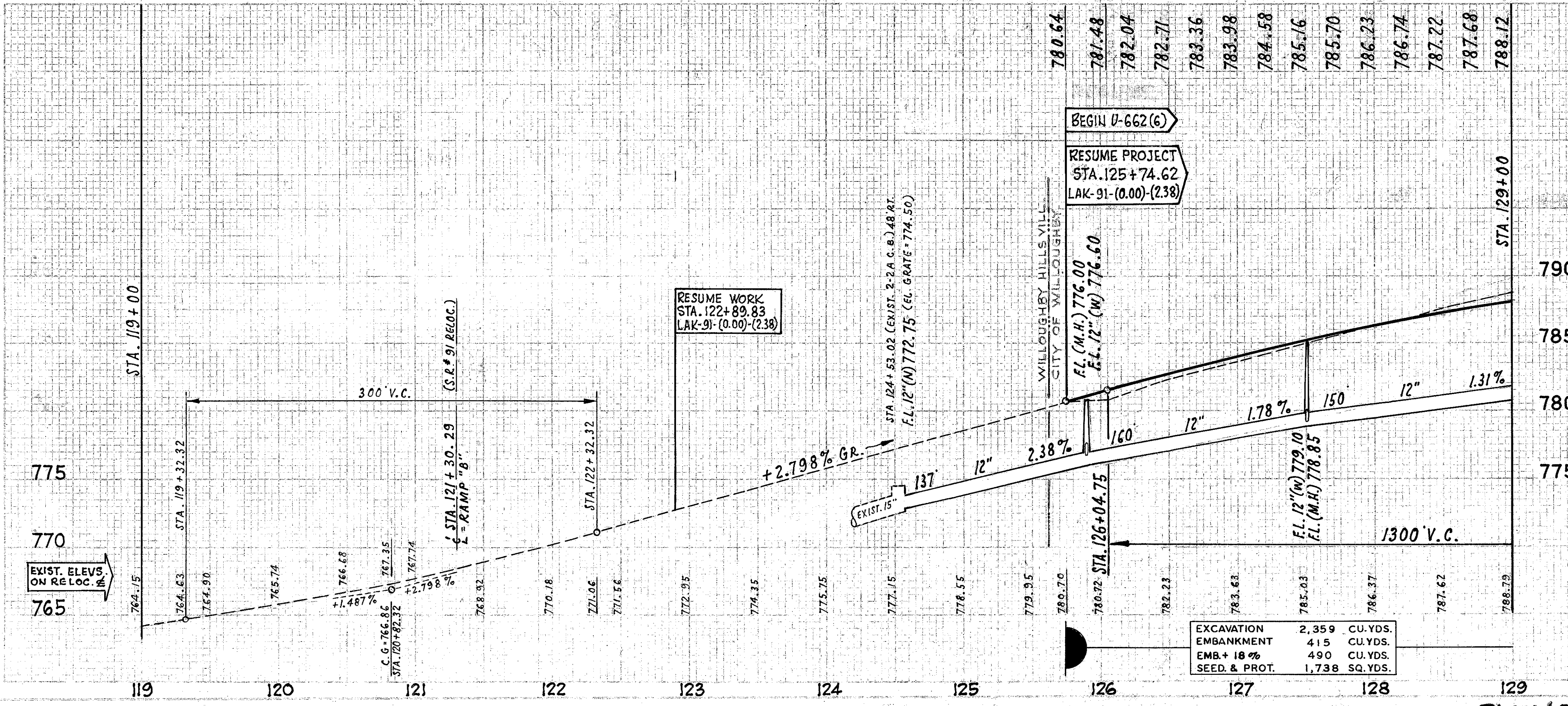

EXCAVATION	2,359	CU. YDS.
EMBANKMENT	415	CU. YDS.
EMB. + 18%	490	CU. YDS.
SEED. & PROT.	1,738	SQ. YDS.