

LAK-90-8.77/29.20

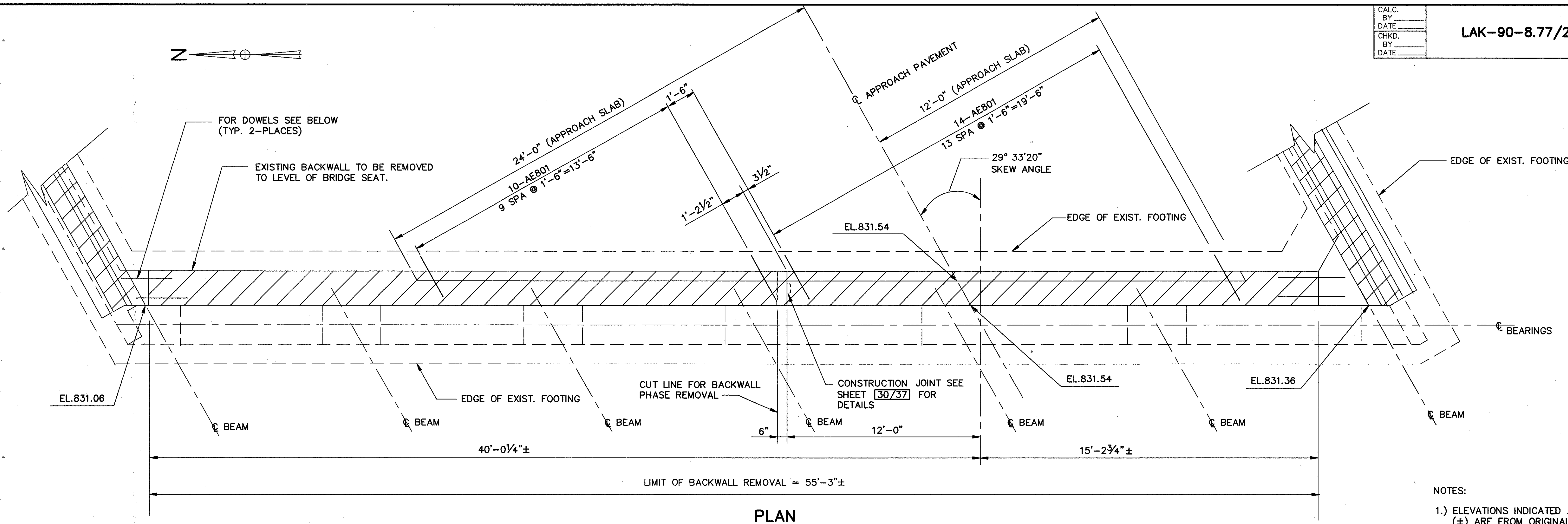

PLAN

- NOTES:
- 1.) ELEVATIONS INDICATED AS BEING APPROXIMATE (±) ARE FROM ORIGINAL DESIGN DRAWINGS. THEY ARE PROVIDED FOR INFORMATION ONLY AND ACTUAL FIELD CONDITIONS SHOULD BE EXPECTED TO DEVIATE DUE TO SETTLEMENT. ELEVATIONS NOT MARKED W/± ARE FROM FIELD MEASUREMENTS.
 - 2.) ALL BARS SHALL BE EPOXY COATED.
 - 3.) FOR APPROACH SLAB REPLACEMENT SEE HIGHWAY DWGS.
 - 4.) SEE HIGHWAY DRAWINGS FOR PHASE CONSTRUCTION LIMITS.
 - 5.) NOTATION: E.F.—EACH FACE, F.F.—FAR FACE, N.F.—NEAR FACE, TYP.—TYPICAL, EL.—ELEVATION, MIN.—MINIMUM, EXIST.—EXISTING, DWLS—DOWELS.
 - 6.) FOR SECTIONS SEE SHEET 20/37

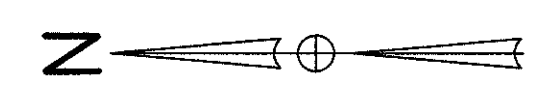
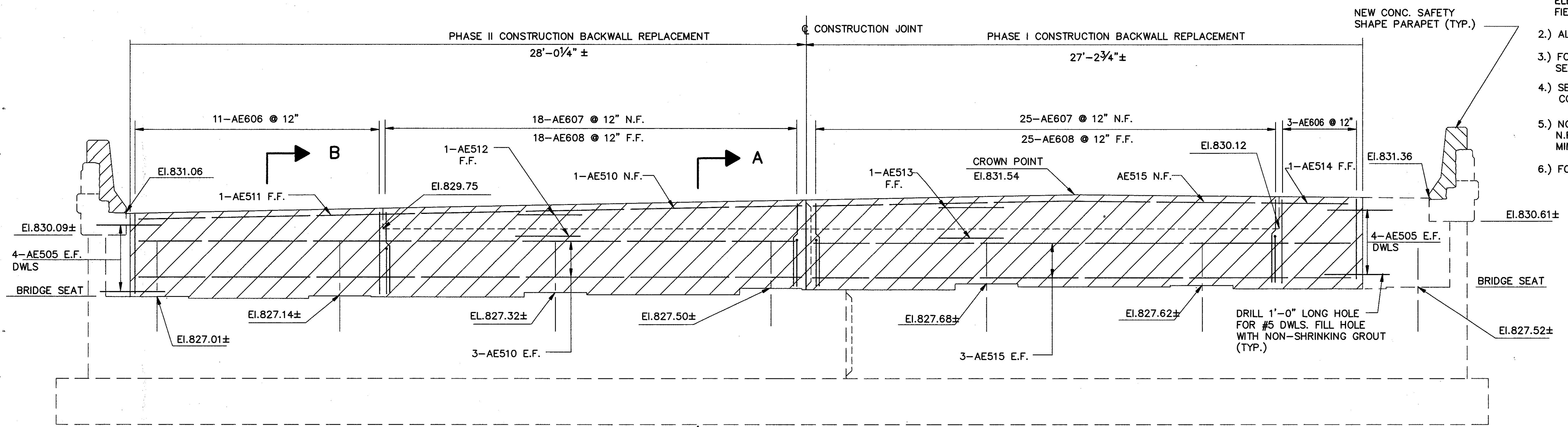

ELEVATION

CT COLPETZER-THOMAS, INC. AN ENGINEERING GROUP WILLOUGHBY • MENTOR • NORTH CANTON • STEUBENVILLE • LORAIN		19/37				
PLAN AND ELEVATION FORWARD ABUTMENT BACKWALL AUBURN RD. LAK-90-1487L						
DESIGNED	DRAWN	TRACED	CHECKED	REVIEWED	DATE	REVISED
H.B.M.	J.L.J.	J.L.J.	R.J.C.	B.J.A.	11/2/87	