

LAKE COUNTY  
LAK - I - 6.97

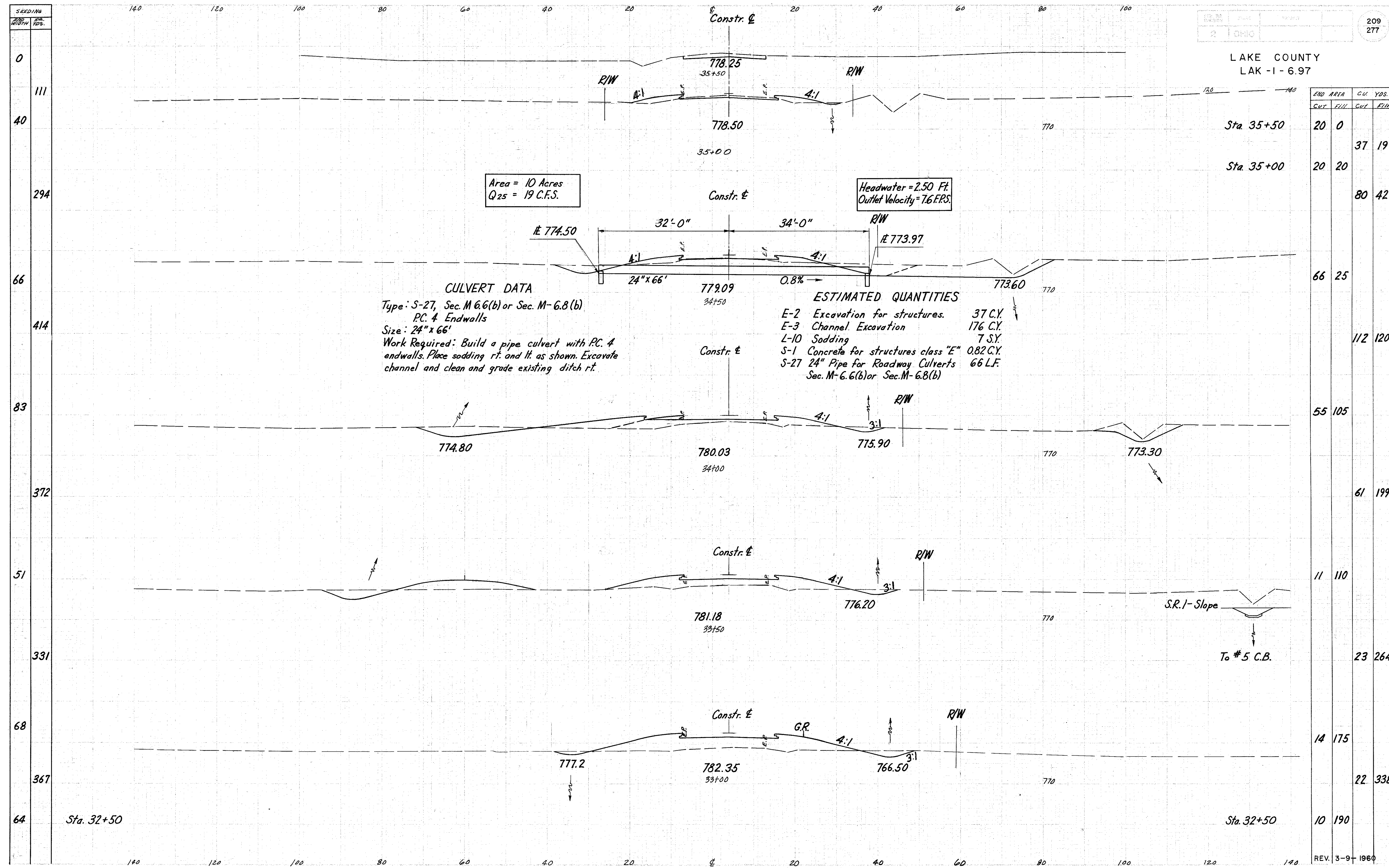

Area = 10 Acres  
Q<sub>25</sub> = 19 C.F.S.

Headwater = 2.50 Ft.  
Outlet Velocity = 7.6 F.P.S.

**CULVERT DATA**

Type: S-27, Sec. M-6.6(b) or Sec. M-6.8(b)  
PC: 4 Endwalls  
Size: 24" x 66"  
Work Required: Build a pipe culvert with PC: 4 endwalls. Place sodding rt. and lt. as shown. Excavate channel and clean and grade existing ditch rt.

**ESTIMATED QUANTITIES**

- E-2 Excavation for structures. 37 C.Y.
- E-3 Channel Excavation 176 C.Y.
- L-10 Sodding 7 S.Y.
- S-1 Concrete for structures class "E" 0.82 C.Y.
- S-27 24" Pipe for Roadway Culverts 66 L.F.  
Sec. M-6.6(b) or Sec. M-6.8(b)

Sta.	END AREA		CU. YDS.	
	CUT	FILL	CUT	FILL
Sta. 35+50	20	0		37 19
Sta. 35+00	20	20		80 42
66			25	
66				112 120
83			105	
83				61 199
372				11 110
51				23 264
51			110	
331				14 175
331				22 338
68				10 190
68			175	
367				
367			190	
64				

Sta. 32+50

Sta. 32+50