

LAKE COUNTY
LAK-1-697

P.I. Sta. 124 +70.85
 $\Delta = 28^\circ 25' 26''$ Lt.
 R = 100.00'
 L = 49.61'
 T = 25.33'

 P.I. Sta. 126 +70.19
 $\Delta = 59^\circ 33' 57''$ Rt.
 R = 75.00'
 L = 77.97'
 T = 42.92'
 P.C. Sta. 126 + 27.27
 P.T. Sta. 127 +05.24

(P) PAVEMENT

REF. NO.	STATION	SIDE	ROAD MIX BIT. MATL.	SEAL COAT BIT. MATL.	T-32			T-30	B-19	E-1
					# 46 AGGR. FOR ROAD MIX	# 6 AGGR. FOR CHOKE	# 6 AGGR. FOR SEAL COAT	BIT. PRIME COAT	AGGR. BASE COURSE	COMPACT SUBGR.
I-P	120+00	127+0962			GAL.	C.Y.	GAL.	C.Y.	S.Y.	
			10.96	249	56	4	8	399	138	996

(D) DRAINAGE

REF. NO.	STATION	SIDE	24" PIPE FOR DRIVEWAYS SODDING	
			SEC. M-6.4(a)	S.Y.
I-D	120+00	120+68	L.T.	76
2-D	120+64		C.	46
3-D	125+00	34+56	L.T.	206

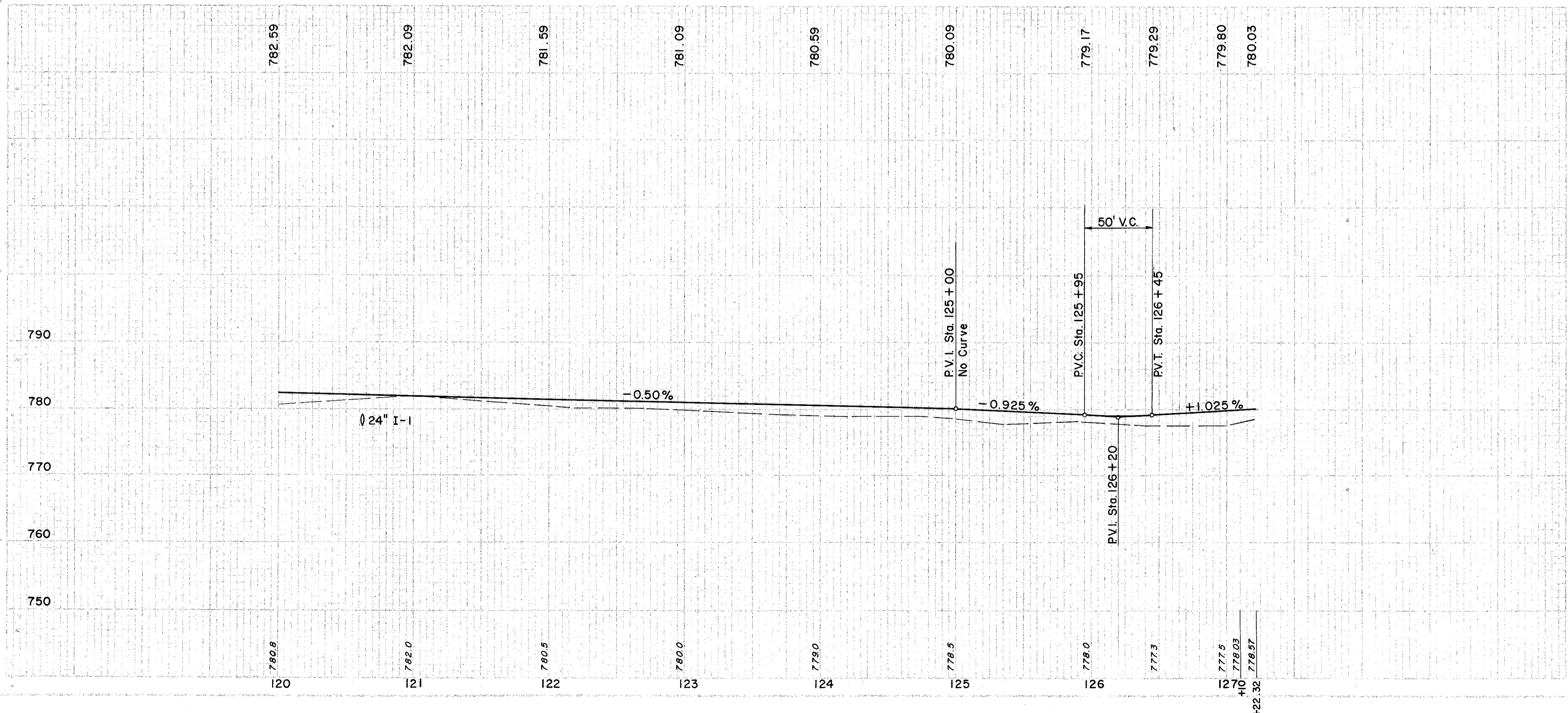
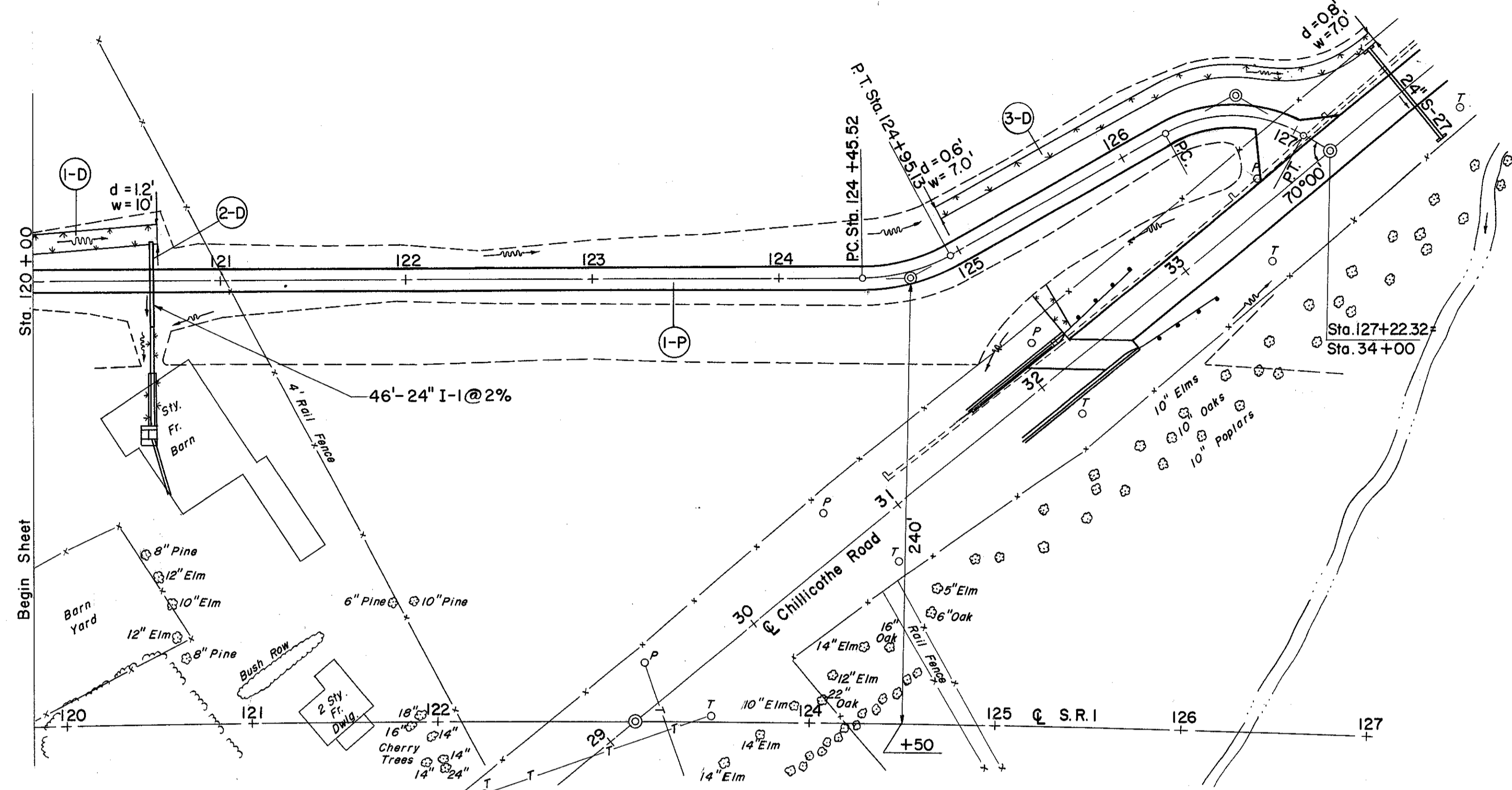

Excavation	322 C.Y.
Embankment	579 C.Y.
Embankment - 18"	683 C.Y.