

LAKE COUNTY
LAK-I-6.97

(D) DRAINAGE

REF. NO.	STATION	SIDE	L-10 SODDING FOR SPECIAL BERM & SLOPE PROTECT.
1-D	32+10	LT.	56
2-D	32+15	RT.	60

(R) ROADWAY

REF. NO.	STATION	SIDE	RAILWIRE CABLE TYPE (3-CABLES)
1-R	32+09	35+13	LT. 304
2-R	32+19	35+23	RT. 304

(P) PAVEMENT

REF. NO.	STATION	SIDE	ROAD BITUM. MAT'L.	SEAL BITUM. MAT'L.	#46 AGGR. FOR ROAD MIX.	#6 AGGR. FOR CHOKE	#6 AGGR. FOR SEAL COAT	T-32 BITUM. PRIME COAT GAL.	T-30 AGGR. BASE COURSE C.Y.	B-19 SUB-BASE C.Y.	I-22 COMPACT SUBGR. S.Y.	E-1 I-9 STONE UNDER DRAIN (NO.2) L.F.
1-P	32+2372	39+50	1598	363	81	6	12	581	213	179	1453	210
2-P	36+95	LT.									91	
TOTALS			1598	363	81	6	12	581	226	179	1544	210

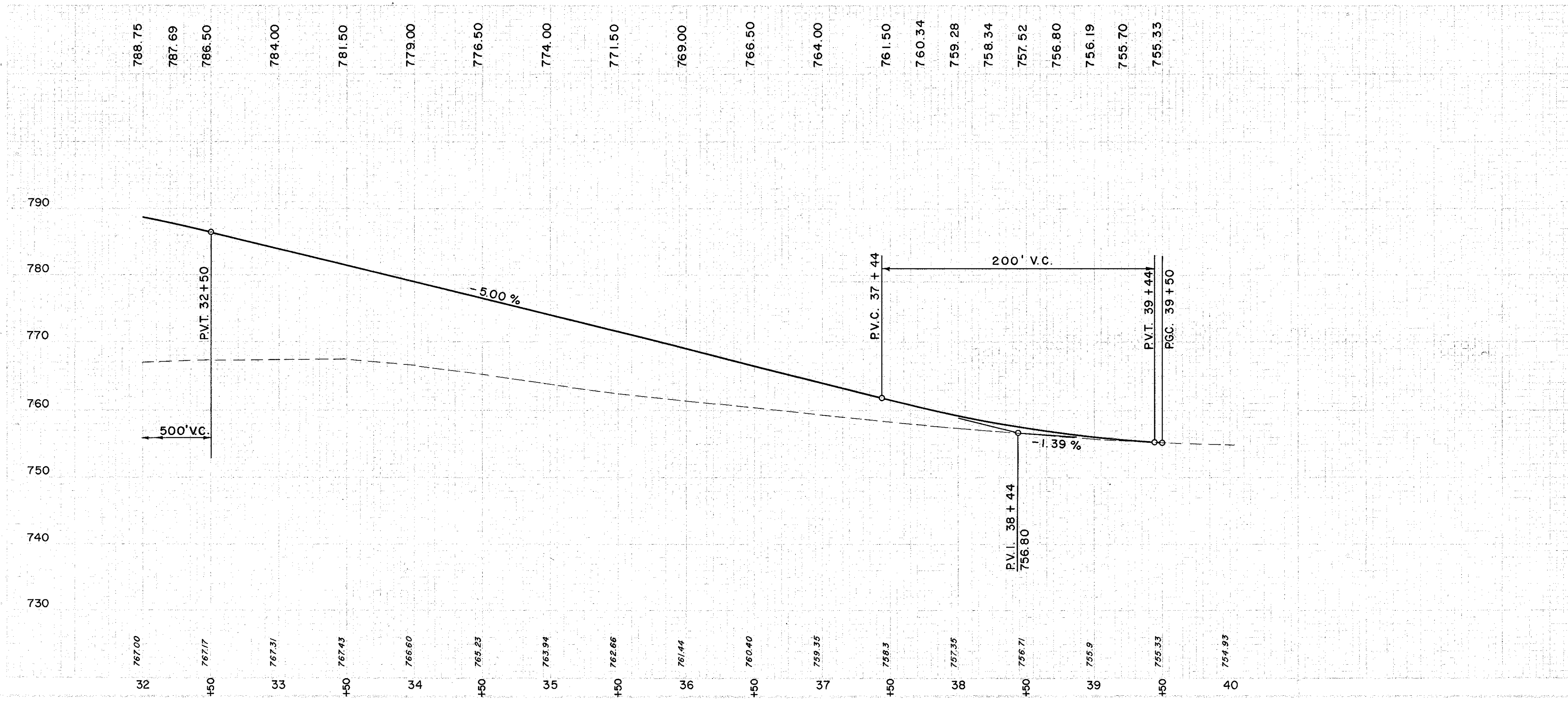
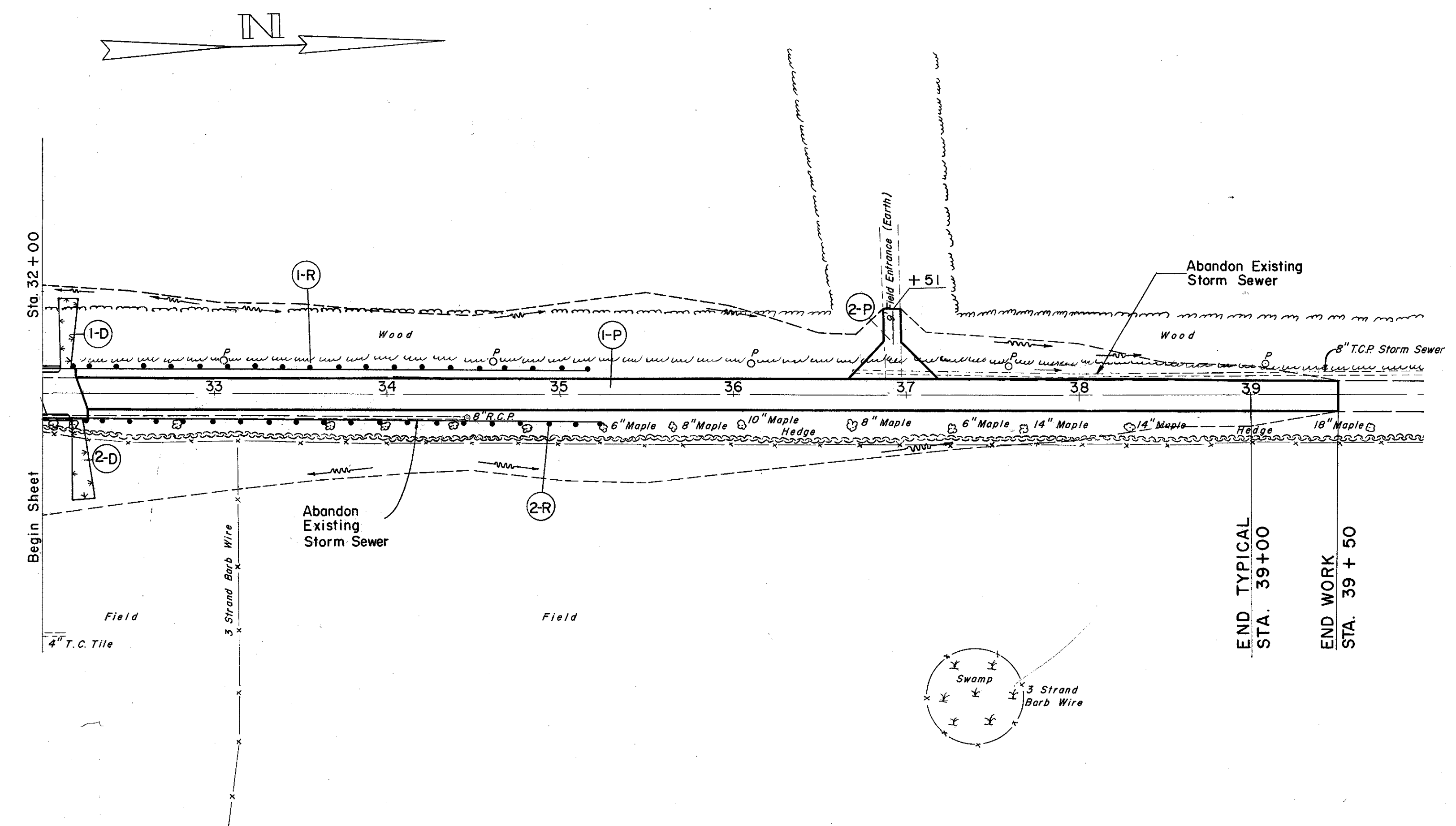

Excavation	279 C.Y.
Embankment	13,442 C.Y.
Quantity	18
	15,862 C.Y.