

FOR DETAILS OF STRUCTURE
NO LAK-I-0789
SEE SHEET NO. 70
(X-SECTIONS)

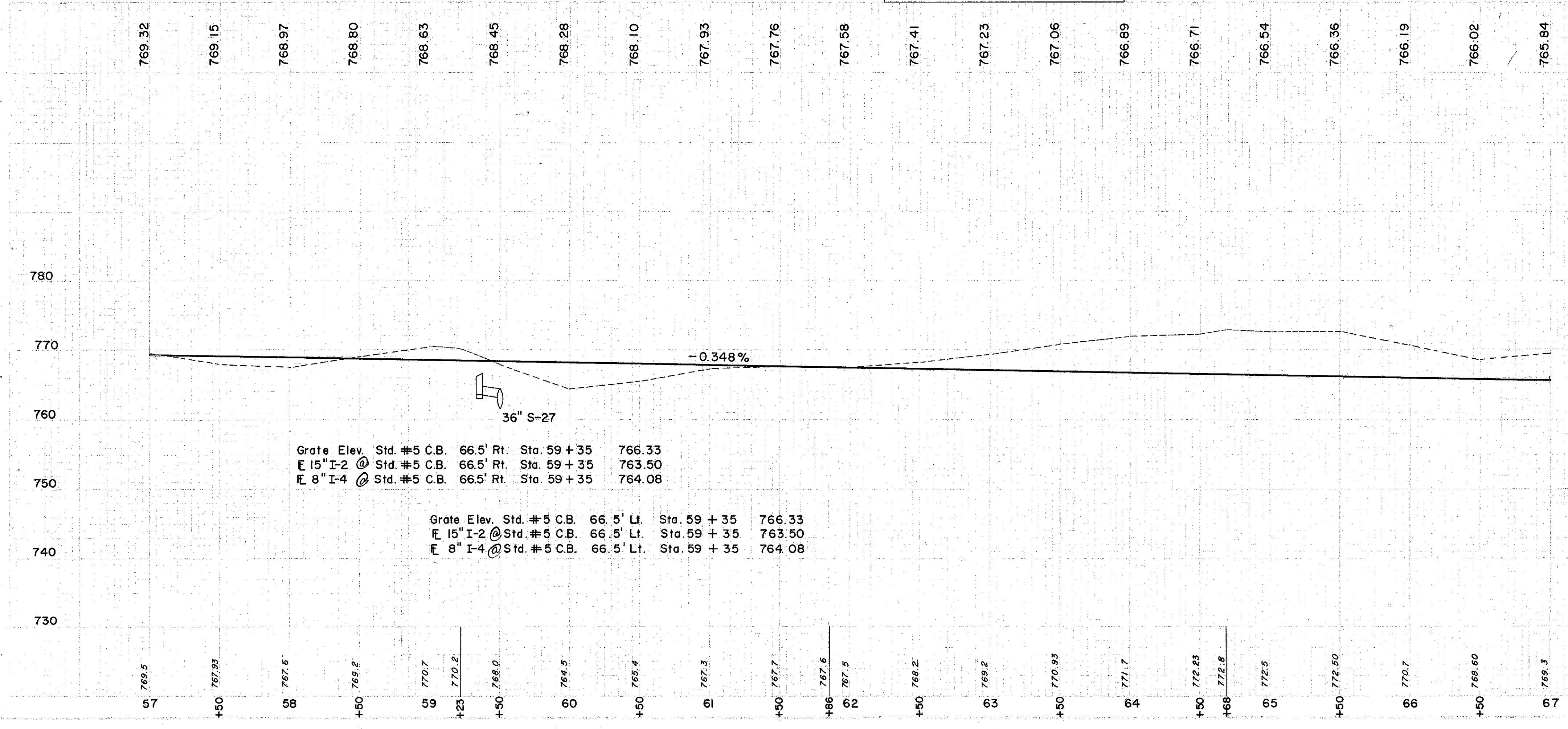
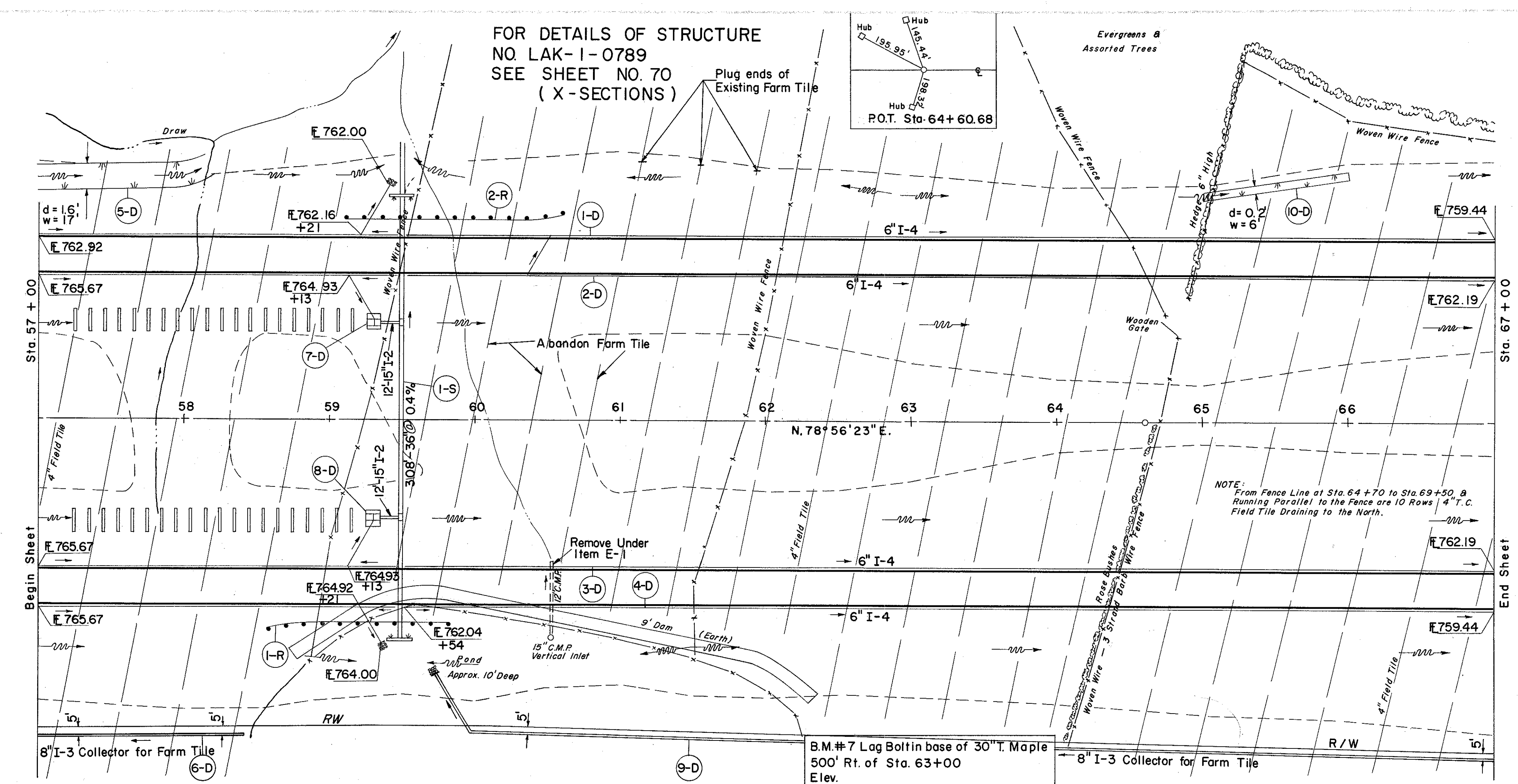

Grate Elev. Std. #5 C.B. 66.5' Rt. Sta. 59+35 766.33
 E 15" I-2 @ Std. #5 C.B. 66.5' Rt. Sta. 59+35 763.50
 E 8" I-4 @ Std. #5 C.B. 66.5' Rt. Sta. 59+35 764.08

Grate Elev. Std. #5 C.B. 66.5' Lt. Sta. 59+35 766.33
 E 15" I-2 @ Std. #5 C.B. 66.5' Lt. Sta. 59+35 763.50
 E 8" I-4 @ Std. #5 C.B. 66.5' Lt. Sta. 59+35 764.08

(D) DRAINAGE

REF. NO.	STATION	SIDE		CLASS	STRUCT.	L.F.	I-2	I-3	I-4	I-5	I-8	I-10	S-29
		FROM	TO										
I-D	57+00	67+00	LT.	15"	CLASS "A" SIDE SWR. DRAINAGE	1054	1018	1018	6"	60° WYE	8"	60° BEND	8"
I-D	57+00	67+00	RT.	15"	CLASS "A" SIDE SWR. DRAINAGE	1018	1018	1018	6"	60° WYE	8"	60° BEND	8"
I-D	57+00	67+00	RT.	15"	CLASS "A" SIDE SWR. DRAINAGE	264	264	264	6"	60° WYE	8"	60° BEND	8"
I-D	57+00	58+40	LT.	12	15"	140			6"	60° WYE	8"	60° BEND	8"
I-D	57+25	59+50	RT.	12	15"	730			6"	60° WYE	8"	60° BEND	8"
I-D	59+76	67+00	RT.	10	15"	10			6"	60° WYE	8"	60° BEND	8"
I-D	65+00	66+00	LT.	10	15"	10			6"	60° WYE	8"	60° BEND	8"

(S) STRUCTURES

REF. NO.	STATION	SIDE		CLASS	STRUCT.	L.F.	E-2	E-3	I-5	I-8	I-10	S-27	S-29
		FROM	TO										
I-S	59+50	66+00	LT.	15"	CLASS "A" SIDE SWR. DRAINAGE	411	4	4	8"	60° WYE	8"	60° BEND	8"
I-S	59+50	66+00	RT.	15"	CLASS "A" SIDE SWR. DRAINAGE	411	4	4	8"	60° WYE	8"	60° BEND	8"

(R) ROADWAY

REF. NO.	STATION	SIDE		CLASS	STRUCT.	L.F.	I-15
		FROM	TO				
I-R	58+58	59+83	RT.	15"	CLASS "A" SIDE SWR. DRAINAGE	125	125
I-R	59+10	60+60	LT.	15"	CLASS "A" SIDE SWR. DRAINAGE	150	150

Excavation 37,697 C.Y.
 Embankment 6,453 C.Y.
 Total 44,150 C.Y.