

TRAFFIC MAINTENANCE

LAKE COUNTY
LAK-90-6.71

OHIO
FHWA
REGION 5

160
182

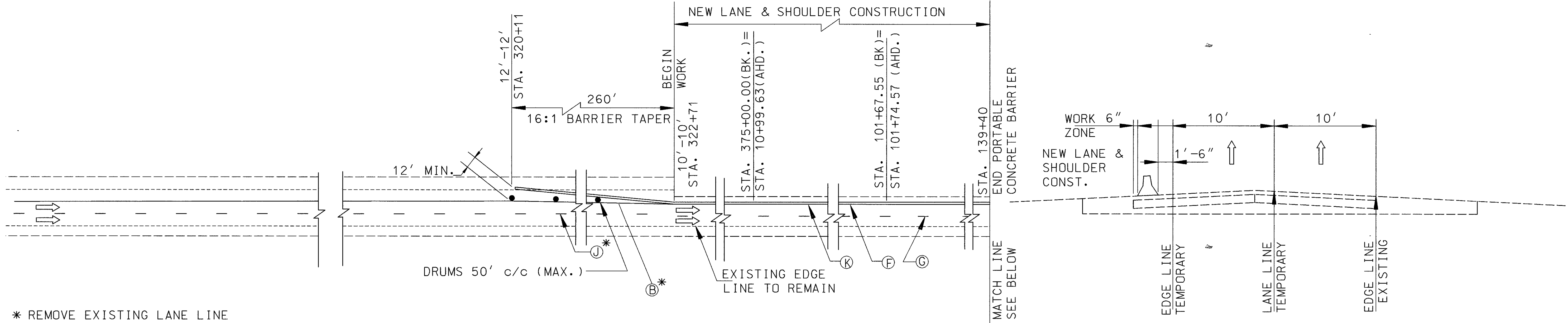
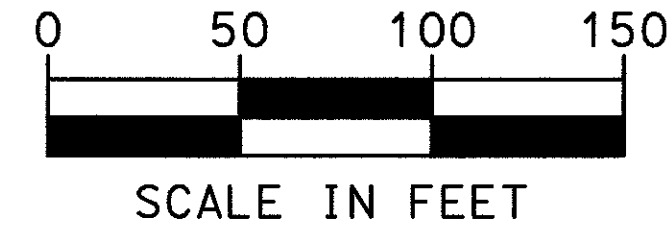

- * REMOVE EXISTING LANE LINE
- REMOVE CONFLICTING PAVEMENT MARKINGS

PHASE I - EAST BOUND NEW LANE AND SHOULDER CONSTRUCTION

NOTE: SEE CONSTRUCTION SEQUENCES AND SCHEDULE OF THRU LANES.

PHASE I
STA. 322+71 TO STA. 139+40

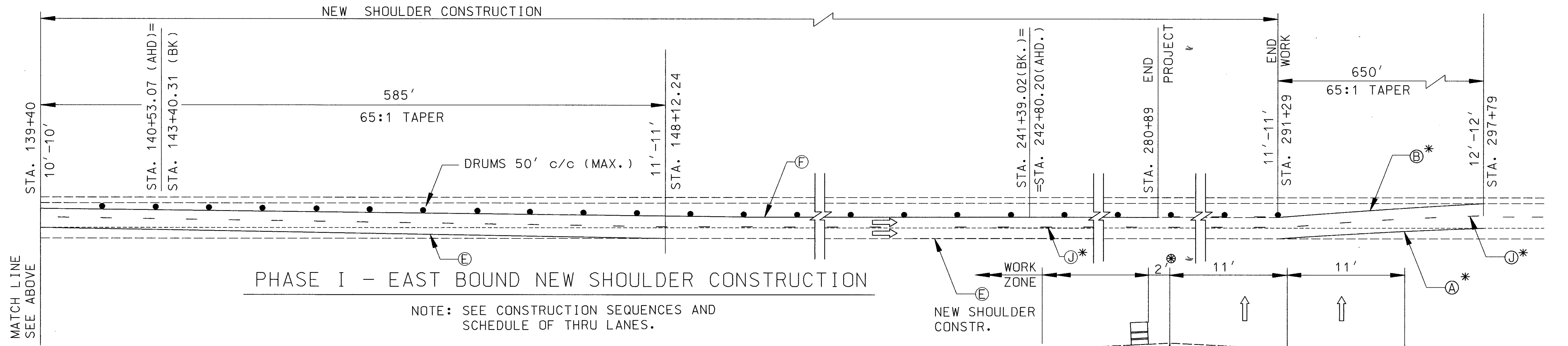

PHASE I - EAST BOUND NEW SHOULDER CONSTRUCTION

NOTE: SEE CONSTRUCTION SEQUENCES AND SCHEDULE OF THRU LANES.

NOTE: SIGNING SHALL BE ADDED FOR "TRUCKS TO USE LEFT LANE" WHERE TRAFFIC IS BEING MAINTAINED ON THE EXISTING SHOULDER.

⊗ MAY REDUCE TO 0' DURING ACTIVE SHOULDER WORK

REFERENCES:

ITEM	SHT. NO
TRAFFIC MAINTENANCE NOTES	155-156
TRAFFIC MAINTENANCE QUANTITIES	157
TEMPORARY PAVEMENT MARKINGS	159

PHASE I
STA. 139+40 TO STA. 291+29

FILE NAME: F:\WORK\LAKE-90\TRAFFIC\0574MB.DGN DATE: 08-12-94, DLR

COPYRIGHT © 1994 BY BENTON & BOWLES, INC. ALL RIGHTS RESERVED. 14, 1994, 08-26-21