

MICROFILMED  
DEC 17 1987

FED. RD. DIVISION	STATE	PROJECT	TYPE FUNDS
2	OHIO	I-1103(20)	

7.59 MI.± NORTH OF MAYFIELD HTS.  
LAKE COUNTY  
LAK-I-4.02

284  
333

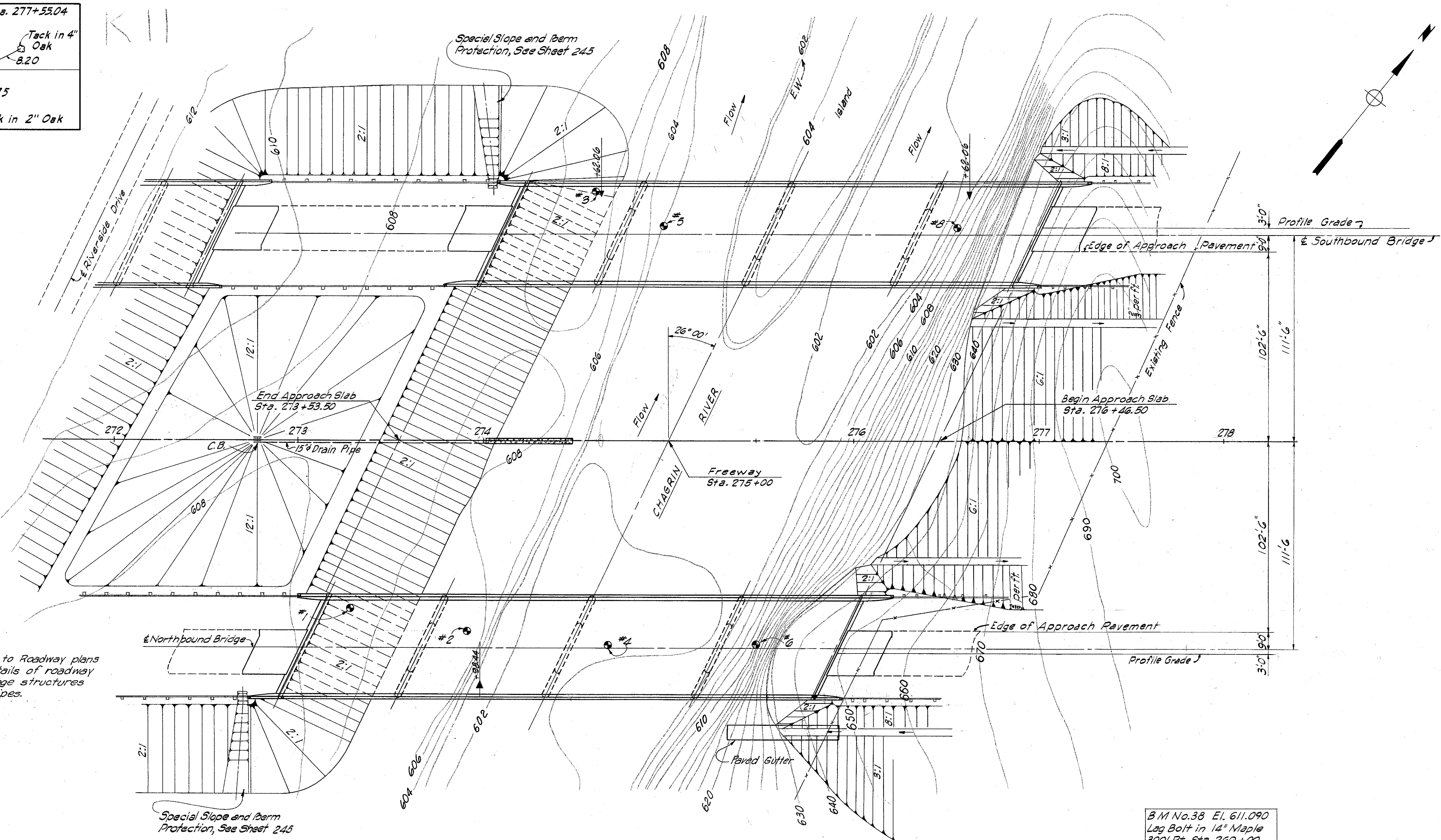

Note:  
Refer to Roadway plans for details of roadway drainage structures and pipes.

**EXISTING STRUCTURE**  
TYPE: 2 Span Low Steel Truss  
SPAN: 2 @ 85'  
ROADWAY: 20'± Plank Flooring  
DATE BUILT:  
CONDITION:  
ALIGNMENT: Tangent  
UNDERCLEARANCE: 16'±

**EXISTING STRUCTURE**  
TYPE: Concrete beam spans  
SPAN: 3 Spans @ 60' = 180'-0"  
ROADWAY: 25' with 2-2.5' sidewalks  
SKEW: 10° L.F.  
ALIGNMENT: 4° Right Curve  
DATE BUILT: 1931  
CONDITION: Good  
UNDERCLEARANCE: 18'  
ROADWAY WEARING SURFACE: Concrete

▲ Denotes Bridge Delineator  
● Denotes Boring Location  
Drainage Area: 255 sq. mi.

B/M No. 38 El. 611.090  
Lag Bolt in 14" Maple  
300' Rt. Sta. 269+00

**FOUNDATION SOUNDINGS:** Foundation design and footing quantities are based on a study of borings and soil sampling soundings made at the site. This sounding information may be inspected in the Bureau of Bridges in Columbus or in the Division office, but the state does not guarantee the accuracy thereof.

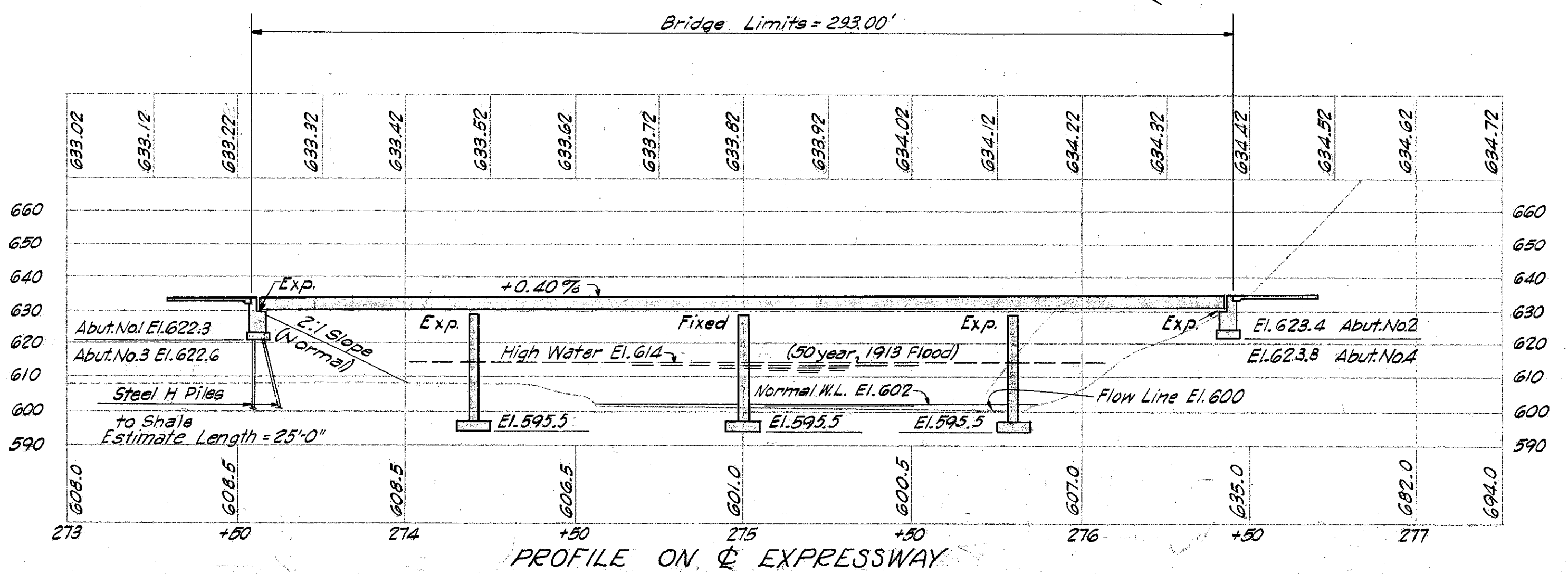

**PROPOSED STRUCTURE**  
(TWO BRIDGES)  
TYPE: Continuous Steel beams with reinforced conc. deck and substructure  
SPANS: 64'-80'-80'-64' 1/2 Bearings  
ROADWAY: 54'-0" Top Parapet, 1'-0" Curbs  
LOAD FREQUENCY: C.F. = 2000 (S7) Adequate for AASHO alternate loading.  
SKEW ANGLE: 26° 00' 00" L.F.  
WEARING SURFACE: 1" Mono. Conc.  
APPROACH SLAB: A5-1-54 (25' long)  
ALIGNMENT: Tangent  
SUPERELEVATION: None

MICHAEL BAKER, JR. CONSULTING ENGINEERS  
ROCHESTER, PENNSYLVANIA

**SITE PLAN**  
BRIDGE NO. LAK-I-0505  
OVER CHAGRIN RIVER  
LAKE COUNTY STA. 273+63.50  
SCALE: 1" = 30' TO 276+46.50

PRESENT TOPOGRAPHY	PROPOSED WORK
Surveyed Notes	Drawn W.A.J.
Drawn W.A.J.	Designed C.F.J.
Designed C.F.J.	Drawn J.M.B.
Drawn J.M.B.	Checked J.K.W.
Checked J.K.W.	Reviewed W.R.B.
Reviewed W.R.B.	4-25-58