

MICROFILMED
DEC 17 1987

FED. RD. DIVISION	STATE	PROJECT	TYPE FUNDS
2	OHIO	I-1103(20)	

268
333

LAKE COUNTY
LAK-1-4.02

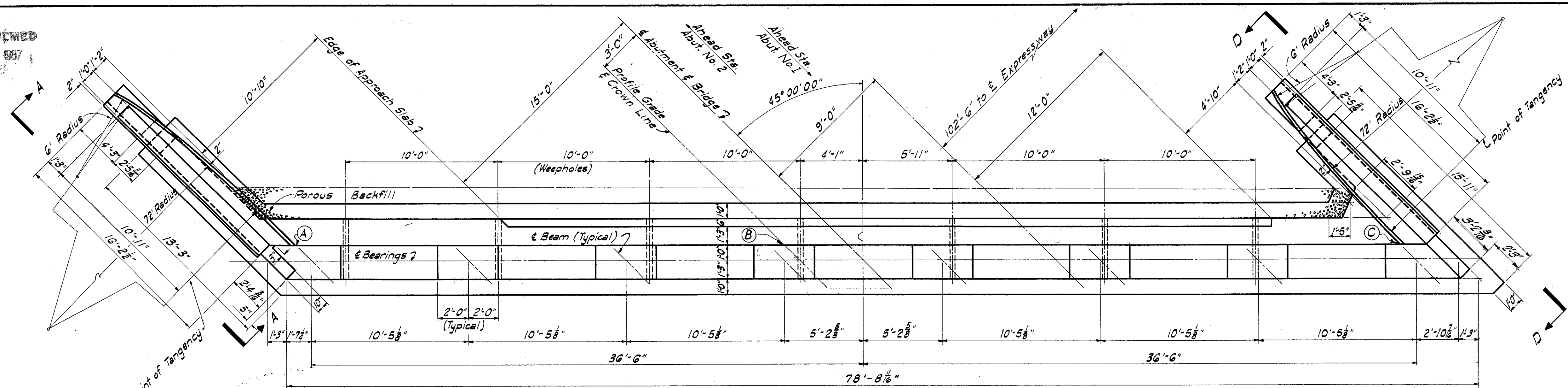

ABUTMENT PLAN

Reference to \pm Expressway, Profile Grade, and Crown Line are shown for abutment No. 2 and opposite hand for abutment No. 1.

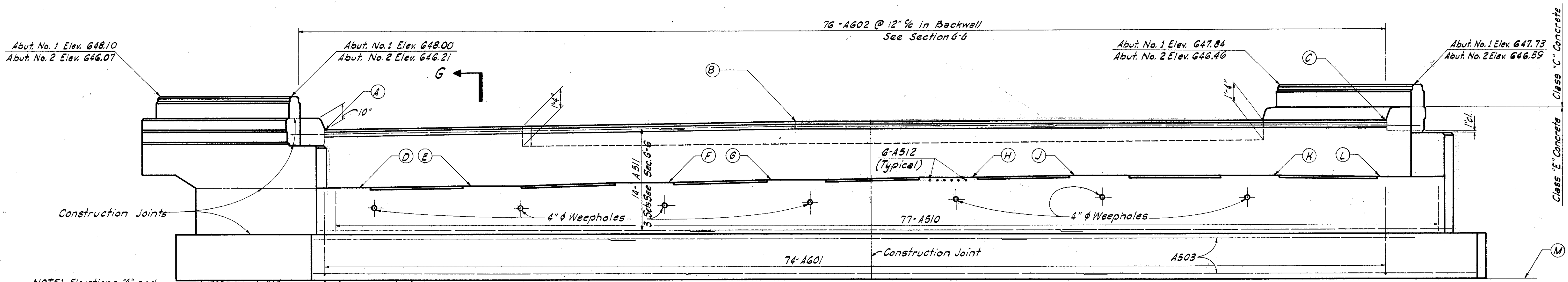

ABUTMENT ELEVATION

NOTE: Elevations 'A' and 'D' on left side as viewed from front face of abutment.

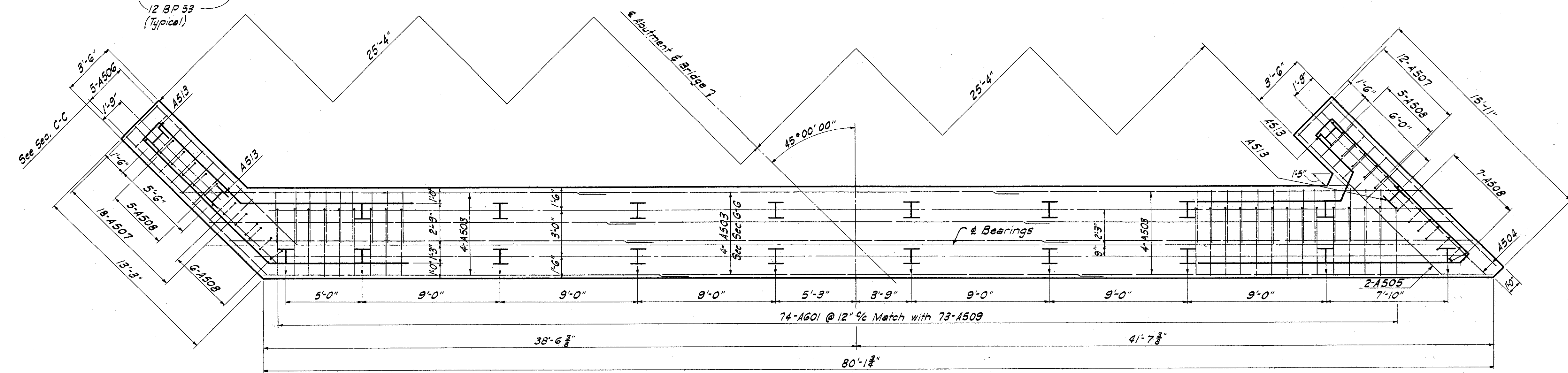

FOOTING PLAN

TABLE OF ELEVATIONS

Locations	A	B	C	D	E	F	G	H	J	K	L	M
Abut. No. 1	645.64	645.90	645.38	641.71	641.78	641.85	641.91	641.96	641.79	641.63	641.46	635.50
Abut. No. 2	643.87	644.43	644.23	639.96	640.15	640.33	640.51	640.48	640.43	640.38	640.33	634.00

NOTES
Care shall be taken in placing reinforcing steel under beam seats so as not to interfere with drilling of anchor bar holes.
For additional abutment notes, see abutment sheet on the south bridge, north bound lane.

Note: All piles in front row are battered 3:12 in the direction indicated.

MICHAEL BAKER JR., CONSULTING ENGINEERS
ROCHESTER, PENNSYLVANIA

ABUTMENTS
SOUTH BOUND-PLAN & ELEVATION
BRIDGE NO. LAK-1-0426
OVER STATE ROUTE NO. 174

LAKE COUNTY
S.B. STA. 235+38.42
TO STA. 237+26.78

Designed	Drawn	Traced	Checked	Reviewed/Date	Revised
G.S.W.	B.C.W.	B.C.W.	G.M.W.	W.R.B. 4-58	