

This sheet supersedes
Sheet No. 258
Added 3-24-60 R.E.C.

FED. RD. DIVISION	STATE	PROJECT
2	OHIO	I-1103 (20) S-46 (7)

258-S
333

LAKE COUNTY
LAK-1-4.02

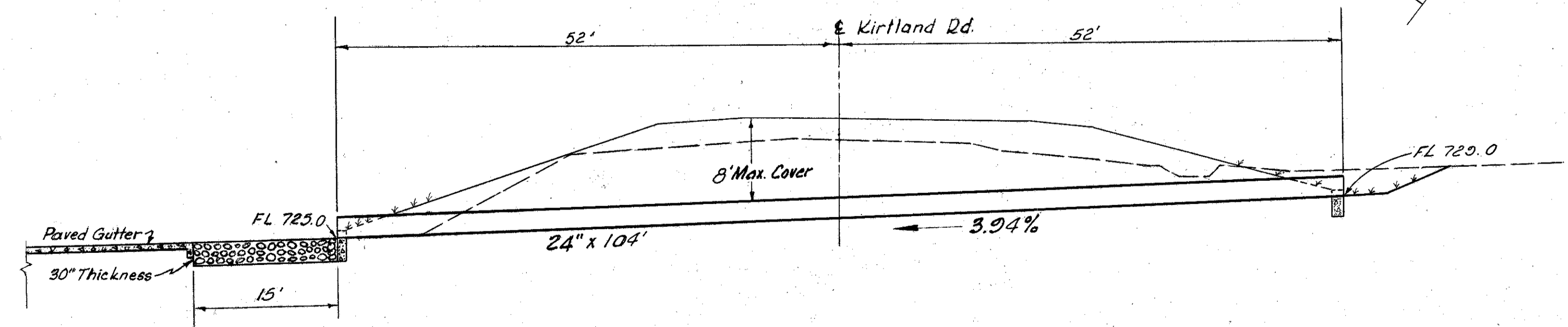
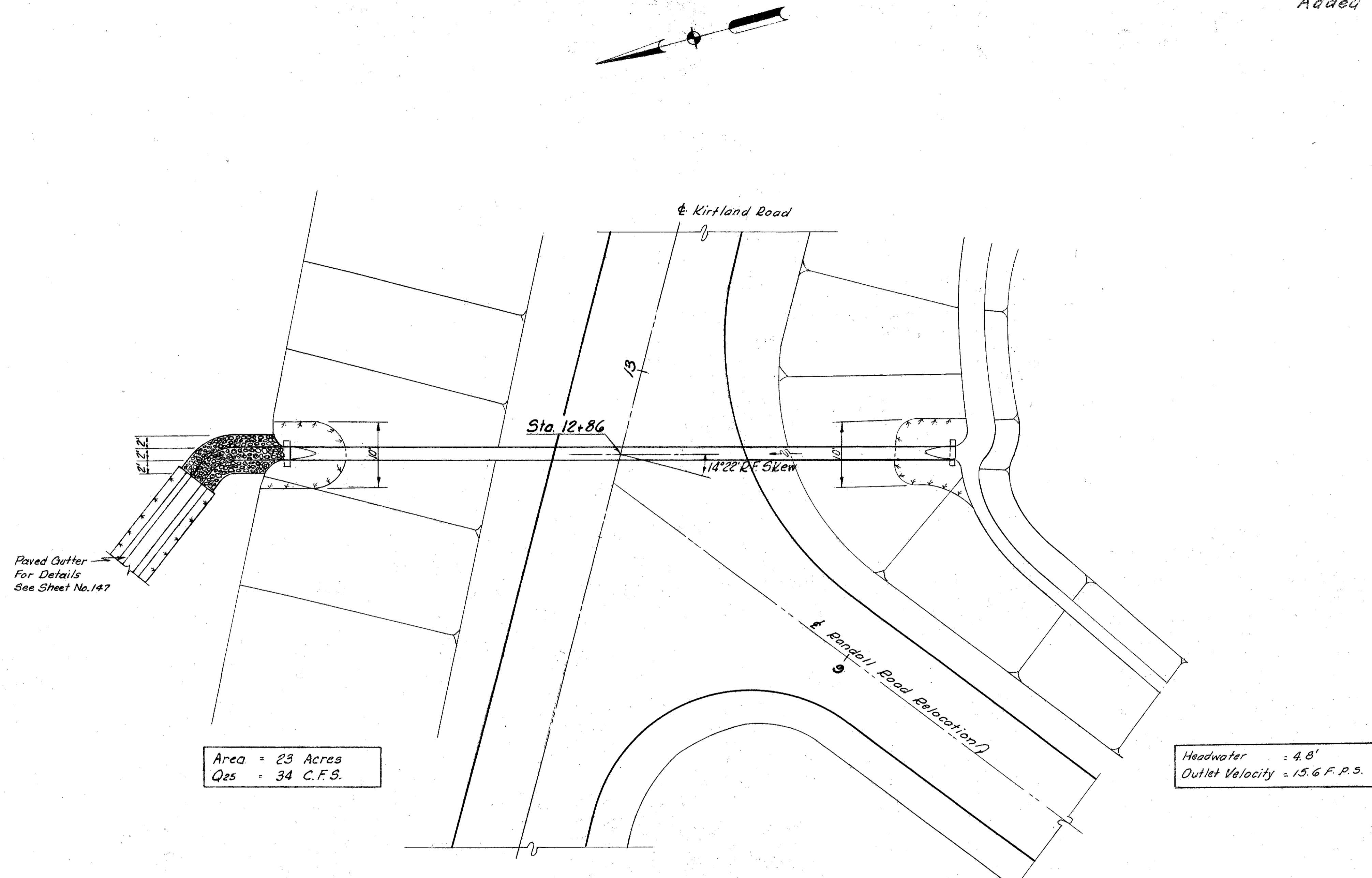

ESTIMATED QUANTITIES

E-2	Excavation for Structures	80	Cu. Yds.
S-1	Concrete for Structures, Class "C"	0.82	Cu. Yds.
S-27	24" Pipe for Roadway Culvert	104	Lin. Ft.
I-10	Dumped Rock Channel Protection	9	Cu. Yds.
L-10	Sodding	37	Sq. Yds.

CULVERT DATA
TYPE: Pipe Culvert S-27, M-G.G(b) or M-G.B(b) Type P.C.4 Hdwl.
SIZE: 24" x 104'

Scale: 1" = 10'

REVISIONS: 3-18-60 Grade Raise for 16'-4" Br. Cl.

MICHAEL BAKER, JR., CONSULTING ENGINEERS
ROCHESTER, PENNSYLVANIA

STATE OF OHIO
DEPARTMENT OF HIGHWAYS
STATE HIGHWAY NO. 1
C-44

CULVERT SECTION
KIRTLAND ROAD STA. 12+86

Designed	Drawn	Traced	Checked	Reviewed Date	Revised
L.I.	J.D.	K.G. M.W.	E.H.		